

Orig + BK 297-11.

L. & S.—55

No. 338

957

39

Cadastral Sheet H19 B.

R.P.O. Vol. 29

Fol. 105

Ward of Guayaguayare

C.T. Vol. 610

Fol. 289

County of Mayaro

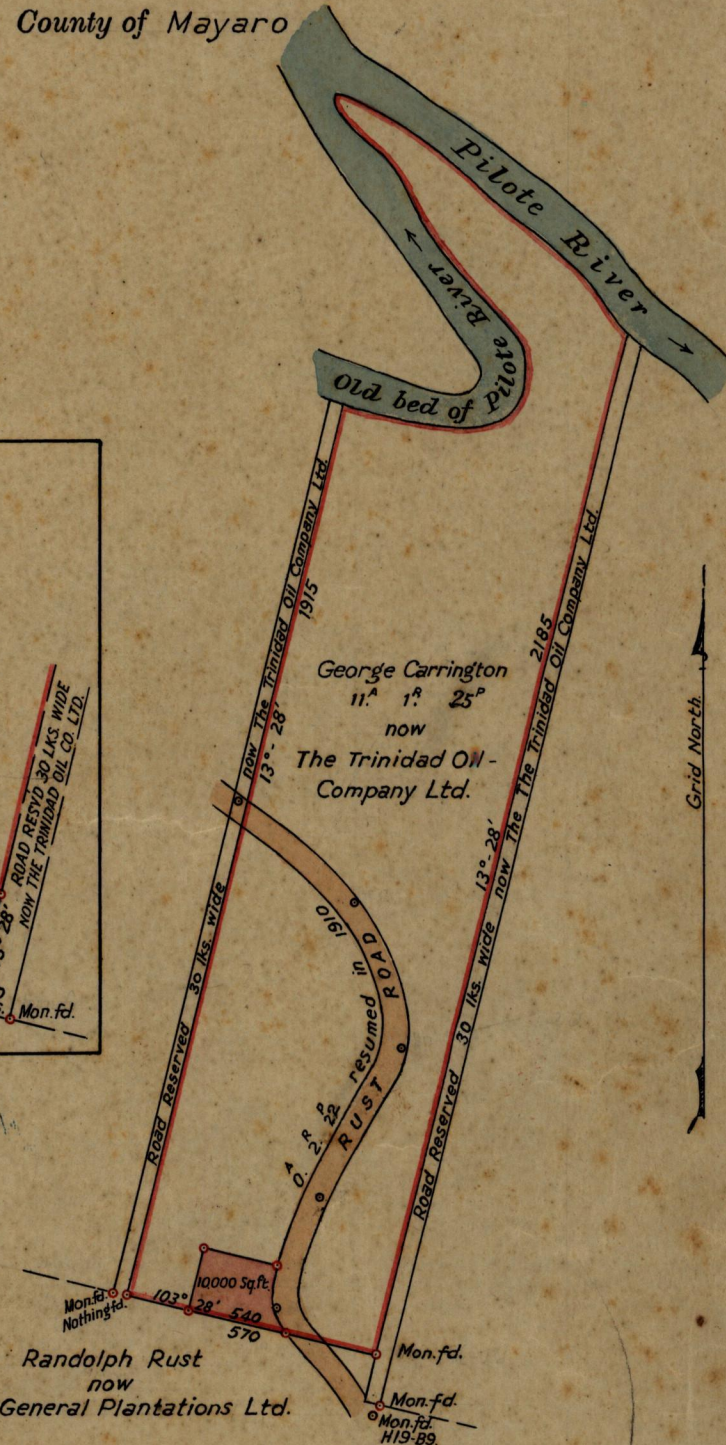
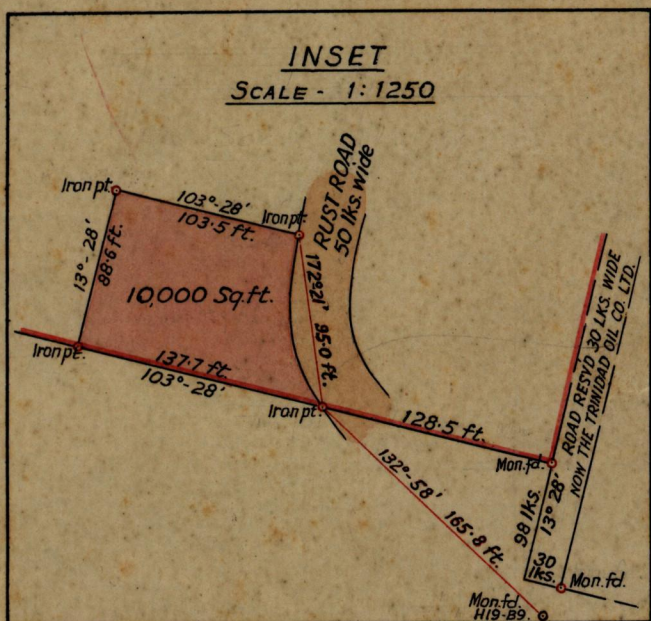

Approved

*Leonard Bead*  
 Director of Surveys  
 27/9/57

SCALE 4 chains to 1 inch

Note : To obtain compass bearings add/subtract 12 minutes Distances are in links & feet

PLAN of a Parcel of land coloured pink in the Ward of Guayaguayare

Containing ten thousand square feet.

Surveyed by me, with due authority, in November, 1956.

I certify that I have complied with rule 76 of Ch. 27, No. 2, under Section 14(2)<sup>d</sup> of the Land Surveyors Ordinance 1952, and that this plan is correct.

Checked by

*R. Stewart*  
 Land Surveyor

Entered on

Trinidad... 30th July... 1957.

27/9/57