

957
22/1/76

L. & S.—54 328

No 36362

R.P.O. Vol. 27
C.T. Vol. 515

Fol. 551
Fol. 307

Ward of Ortoire
County of Victoria
Cadastral Sheet H. I. J.

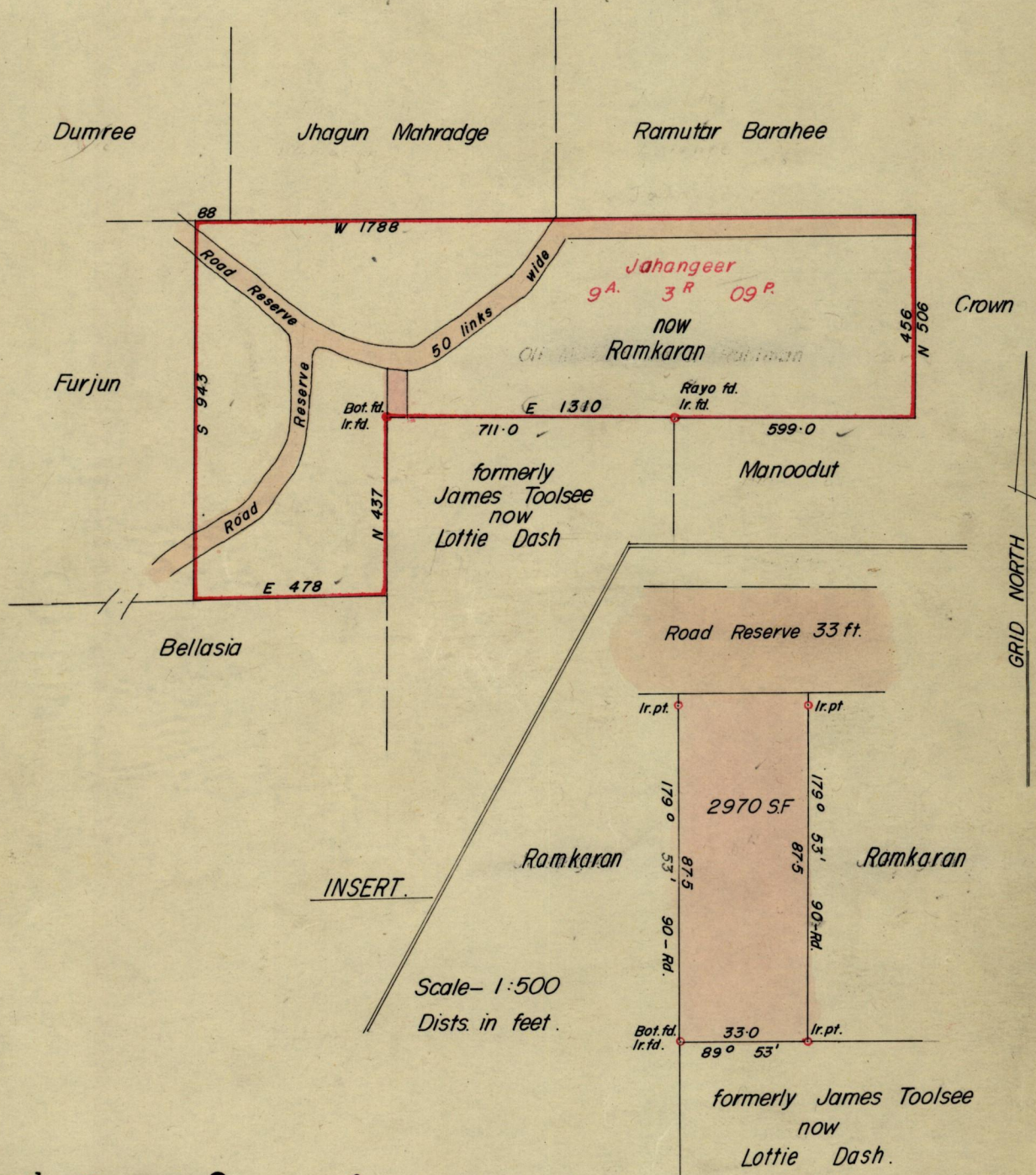

Approved
John Samuel
25.1.76
Director of Surveys

SCALE One Inch to 4 Chains
minutes Distances are in links.

Note: To obtain compass bearings add/subtract

PLAN of a Parcel of land coloured pink in the Ward of Ortoire.

Containing Two thousand nine hundred and seventy square feet.

Surveyed by me, with due authority, in October 1975

I certify that I have complied with rule 76 under Section 14 (2) (d) of the Land Surveyors' Ordinance 1952, and that this plan is correct.

Checked by *L.S.D. 22/1/76*

Ivan Laughlin

Entered

Land Surveyor, Trinidad 21.1.1976

Original in Bk 322 fo. 223

Ms. A. 9. 2

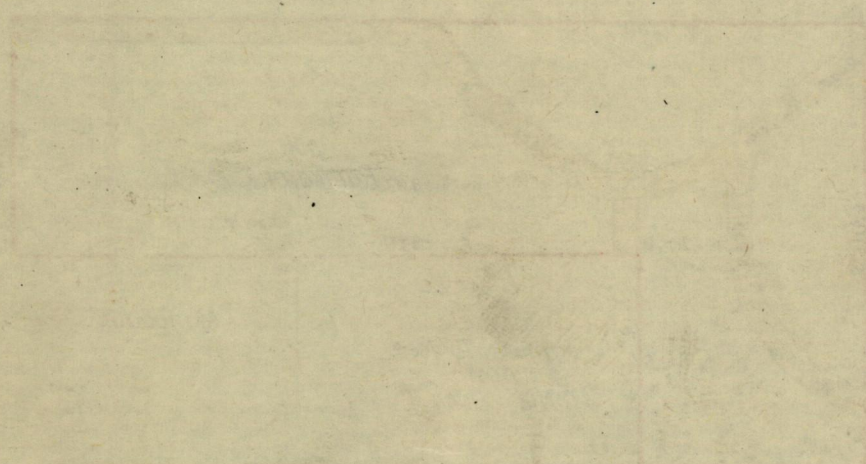

Faint, illegible text at the bottom of the page, possibly bleed-through from the reverse side or a very light stamp.