

No 40329

R.P.O. Vol. 96
C.T. Vol. 1247

Fol. 29
Fol. 21

Ward of Siparia
County of St. Patrick
Cadastral Sheet G 13 E

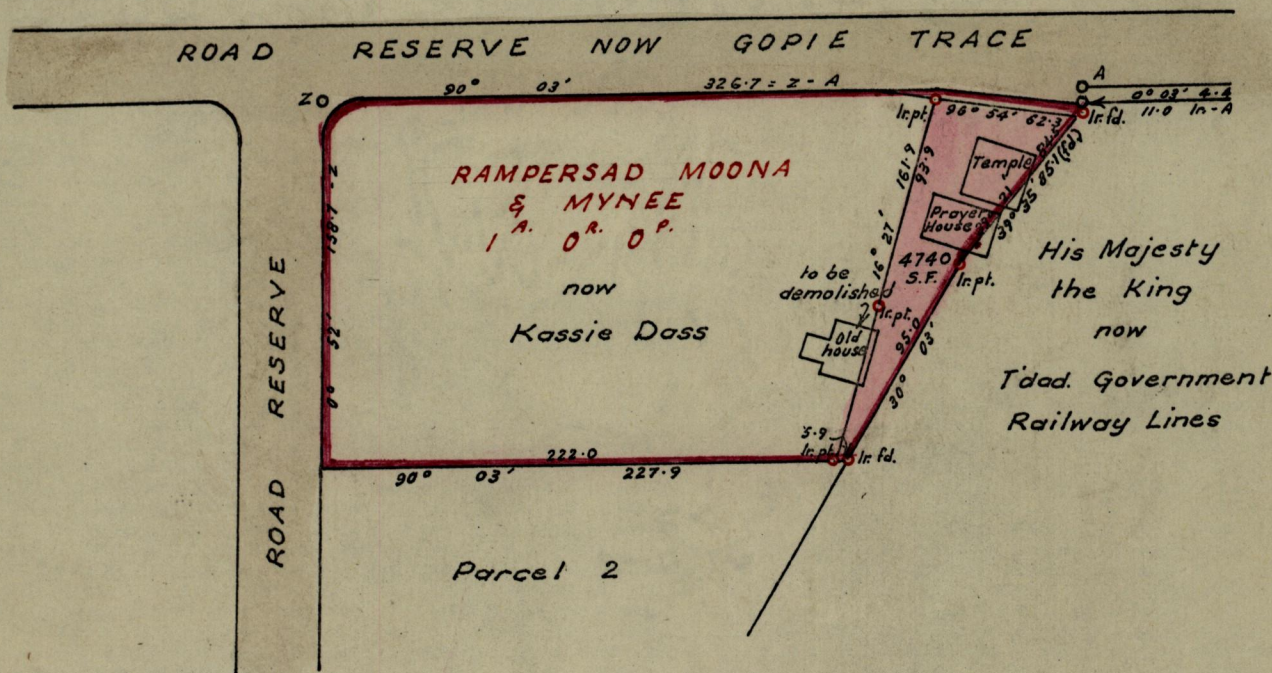

Approved

Seeloo Samuff
 27.1.78. Director of Surveys

SCALE 1 : 1000

Note: To obtain compass bearings ~~and~~ subtract 3 minutes Distances are in feet
 PLAN of a Parcel of land coloured pink in the Ward of Siparia
 Containing four thousand, seven hundred and forty square feet
 Surveyed by me, with due authority, in January 1978

I certify that I have complied with rule 76 under Section 14 (2) (d) of the Land Surveyors' Ordinance 1952, and that this plan is correct.

Checked by *D.F.H. 24/1/78*

J.R. Gardiner
 Land Surveyor, Trinidad 17th Jan. 1978