

957

28

No 40136

Vol. 2555 : 357

R.P.O. Vol. 152

Fol. 105

C.T. Vol. 1178

Fol. 379

Ward of Siparia
County of St. Patrick
Cadastral Sheet G. 19, E

GN

Parcel 2

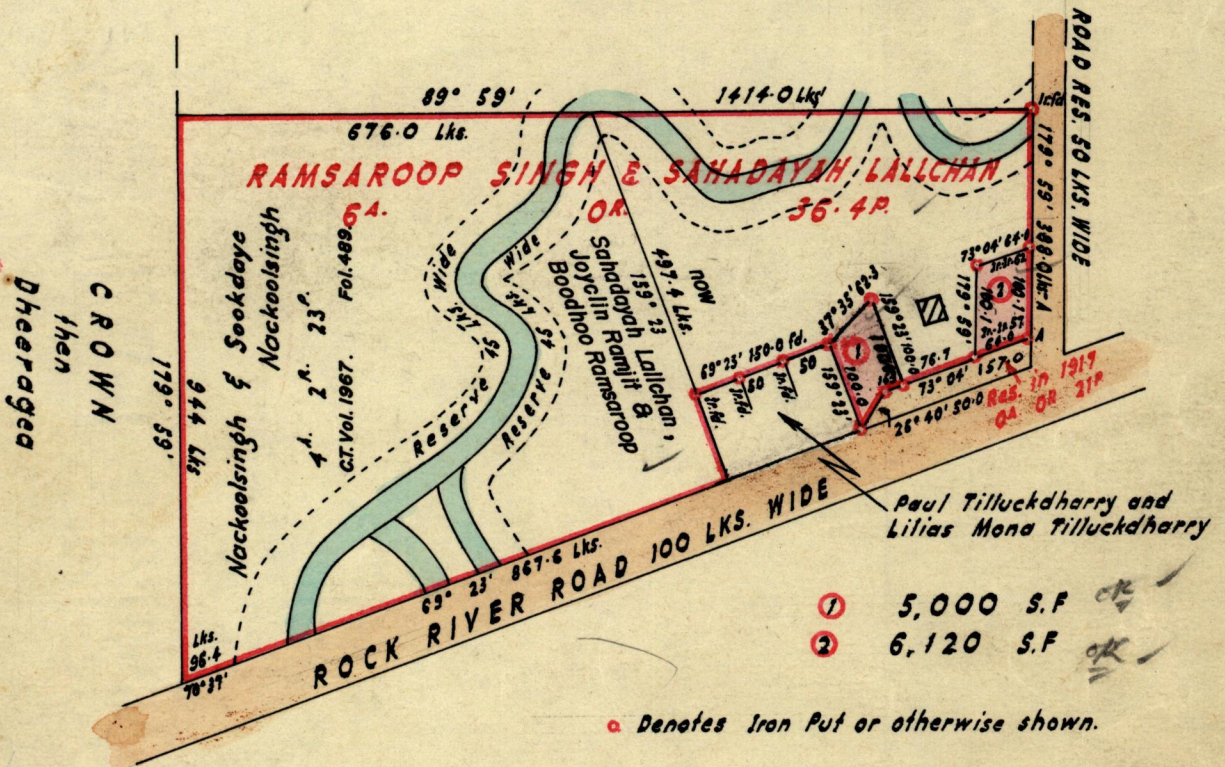

- ① 5,000 S.F
- ② 6,120 S.F

o Denotes Iron Put or otherwise shown.

3 hls fld = CT-1633/205

Approved

M.B. Joseph
Director of Surveys
14.8.79

SCALE - 1 : 2500

Note: To obtain compass bearings add ~~subtract~~ 1 minutes Distances are in Lks & Ft.
PLAN of 2 Parcelsof land coloured Pink in the Ward of Siparia
Containing together Eleven Thousand, One Hundred and Twenty Sq. Ft.
Surveyed by me, with due authority, in January 1978.

I certify that I have complied with rule 76 under Section 14 (2) (d) of the Land Surveyors' Ordinance 1952, and that this plan is correct.

Checked by *12/8/79*

S. Zalliecharan

Entered *PA. G. 19 E.* LANDS. AND SURVEYS VAULT RECORDS Land Surveyor, Trinidad *18/3/1978*

6

Original BK. 1117 fol. 29

Lot 1 - John Clifford - Vol. 2555 fol. 36B

Lot 2 - Joychim Ramjet - Vol. 2567 fol. 487