

CL Stoute Esq

9/7/73 957

L. & S.—54

234

B337/80  
461/80

No 33672

R.P.O. Vol. 13  
C.T. Vol. 468

Fol. 213  
Fol. 7

Ward of Siparia  
County of St. Patrick  
Cadastral Sheet G.17.C  
Siparia Village

G.N

Vol 2168/189

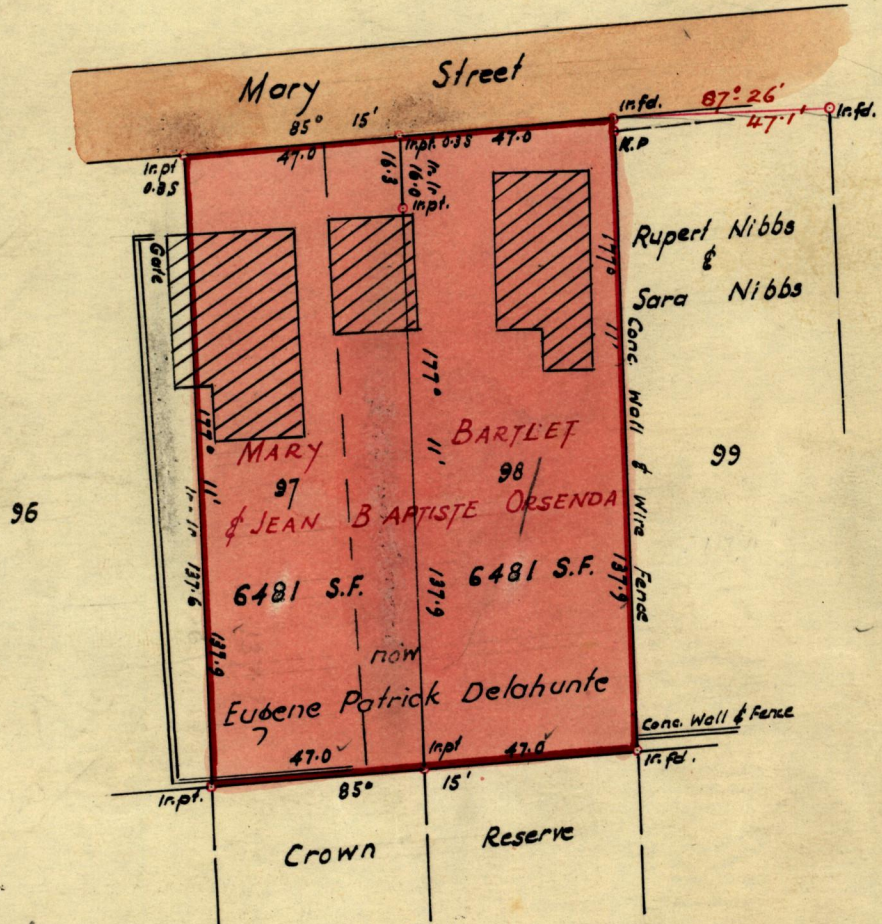

Cecilia Leon Salandy 1/2 share.  
Clive Alexander

Approved  
*Q.A. Game*  
Director of Surveys  
29.4.73

SCALE 1:500

Note: To obtain compass bearings add/subtract 5 minutes Distances are in Ft  
Two  
PLAN of Parcel of land coloured pink in the Ward of Siparia  
Containing together Twelve thousand nine hundred and sixty two sq. ft.  
Surveyed by me, with due authority, in May 1973

I certify that I have complied with rule 76 under Section 14 (2) (d) of the Land Surveyors' Ordinance 1952, and that this plan is correct.

Checked by *L.F.W. 29/4/74*

Entered *H. Stout*  
Land Surveyor, Trinidad 4<sup>th</sup> July 1973

LANDS AND SURVEYS VAULT RECORDS



original survey in BK 337 fol. 133A

see also BK 1110: 55

33012 271

Ward of ...  
County of ...  
State of ...

fol ...  
fol ...

R.O. fol ...  
C.A. fol ...



Approved

Witness my hand

Notary Public

Subscribed and sworn to before me this ... day of ... 19...

in the presence of

Witness my hand and seal this ... day of ... 19...

Witness my hand and seal this ... day of ... 19...

Witness my hand and seal this ... day of ... 19...

Witness my hand and seal this ... day of ... 19...

Witness my hand

Witness my hand and seal this ... day of ... 19...

Faint, illegible text at the bottom left corner, possibly a stamp or additional notes.