

No 35790

R.P.O. Vol. 175
C.T. Vol. 834

Fol. 453
Fol. 107

Ward of Erin
County of St. Patrick
Cadastral Sheet G.16, K4L

GN

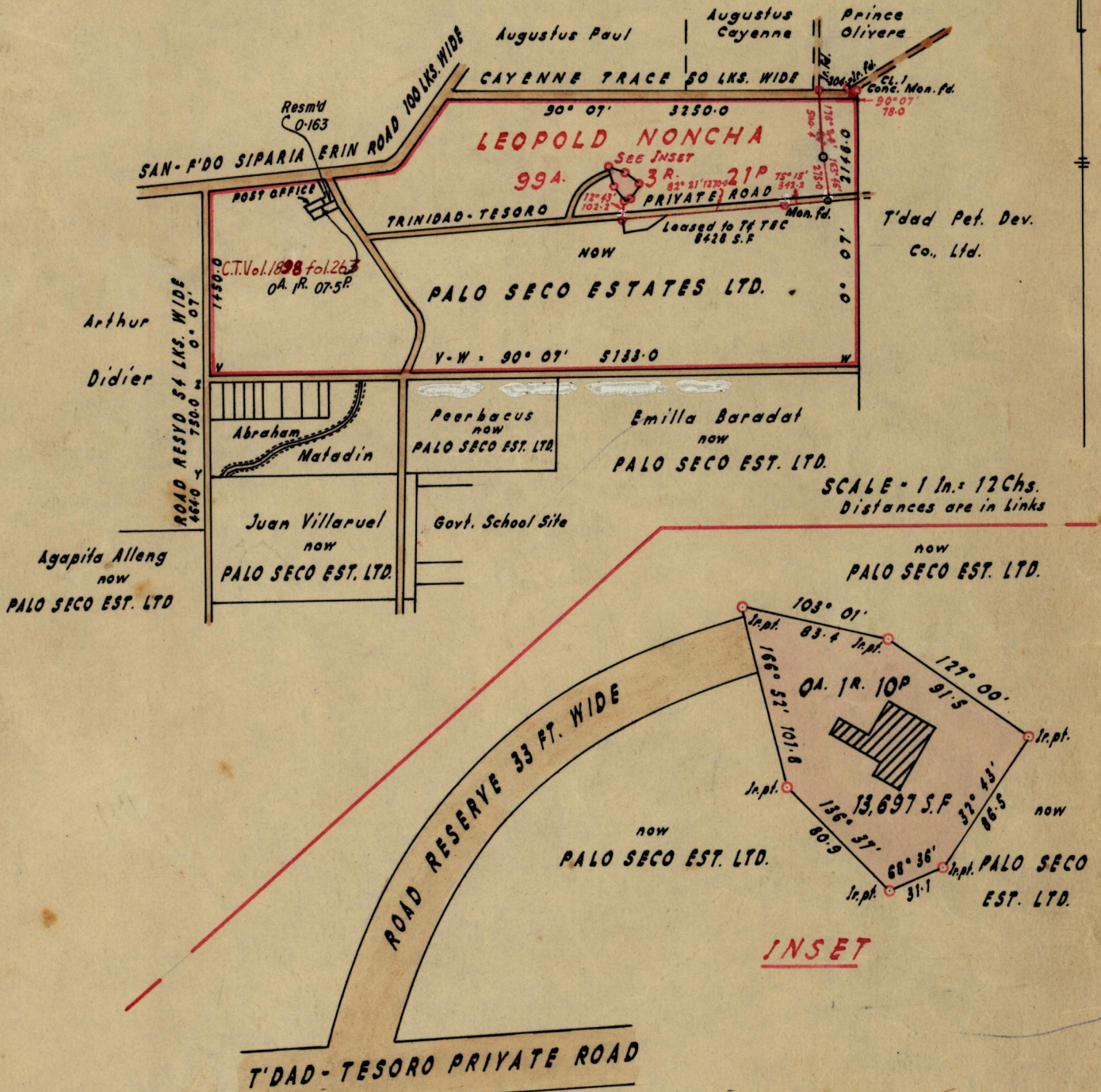

Approved

John Sammf
Director of Surveys

14.1.76.

SCALE - 1 : 1,000

Note: To obtain compass bearings ~~with~~ subtract 7 minutes Distances are in feet

PLAN of a Parcel of land coloured Pink in the Ward of Erin

Containing One Road and Ten Perches.

Surveyed by me, with due authority, in June 1975.

I certify that I have complied with rule 76 under Section 14 (2) (d) of the Land Surveyors' Ordinance 1952, and that this plan is correct.

Checked by *L.F.D. 12/1/76*

A.H. Dub

Entered.....

Land Surveyor, Trinidad. 4th August 1975

Original in Bk 481 fo 30

163 Rold BK 23 Tol 22
Suld 1R 7.5 P CTV d 1898/163