

No 2010

957

133

R.P.O. Vol.
C.T. Vol. 781

Fol.
Fol. 247

Ward of Naparima
County of Victoria
Cadastral Sheet G13H

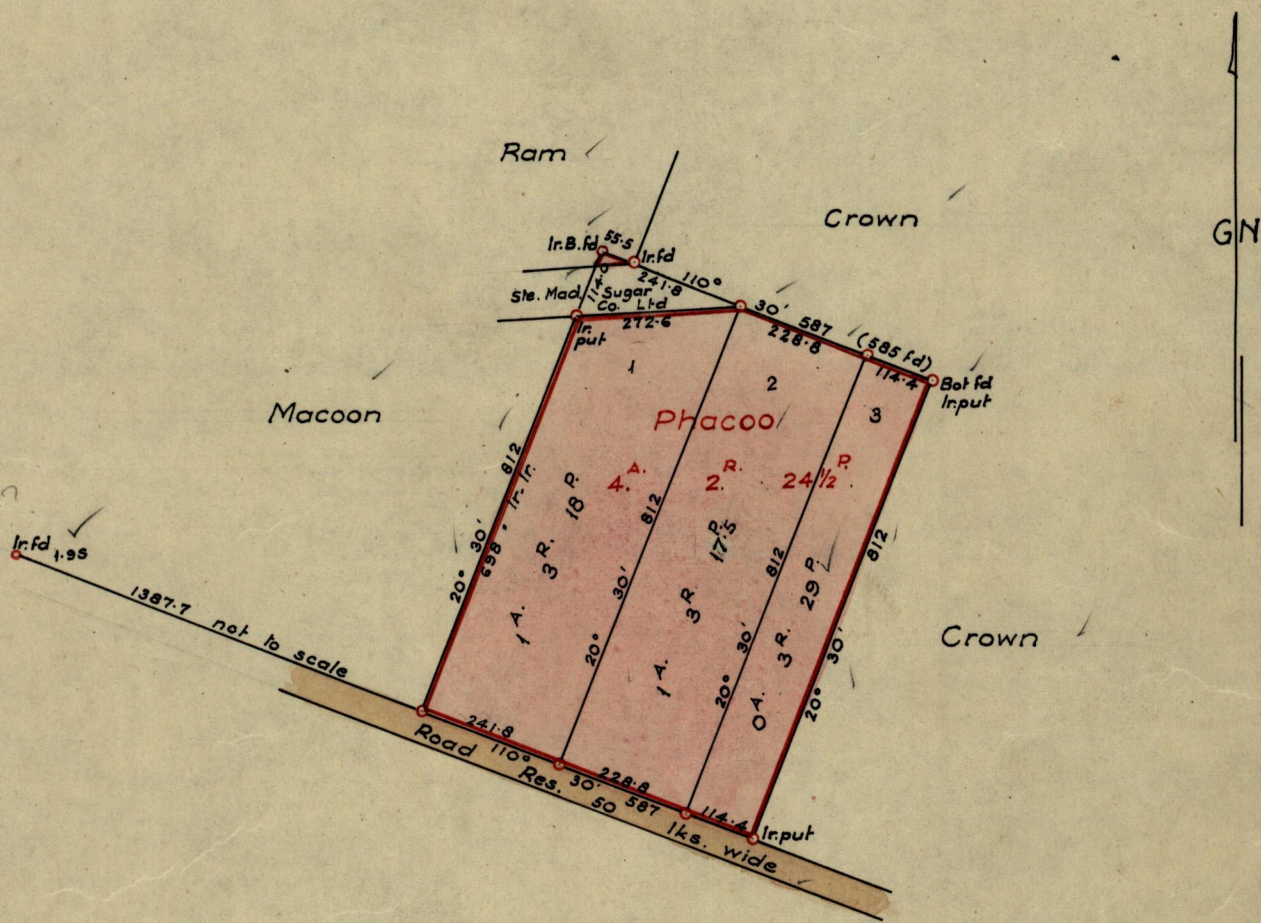

Approved

Lud. E. Laurel

By Dep Director of Surveys
18/7/60.

SCALE 1 ~ 2500
minutes

Distances are in Links

Note: To obtain compass bearings add/subtract 0

PLAN of a Parcel of land coloured pink in the Ward of Naparima
Containing Four acres two roods and twenty four point five perches.
Surveyed by me, with due authority, in May 1960.

I certify that I have complied with rule 76 under Section 14 (2) (d) of the Land
Surveyors' Ordinance 1952, and that this plan is correct.

Checked by *BA* 11/2/60

Entered

Alberta Haynes
Land Surveyor, Trinidad 24th June 19. 60