

No 2260

357

15

Ward of Naparima
County of Victoria
Cadastral Sheet G.13.C.

R.P.O. Vol. 153
C.T. Vol.
Fol. 253
Fol.

Inset

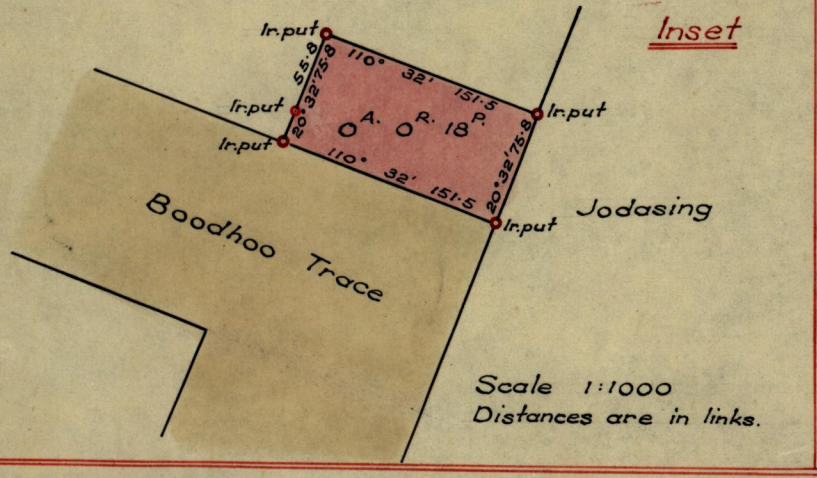

Scale 1:1000
Distances are in links.

G.N.

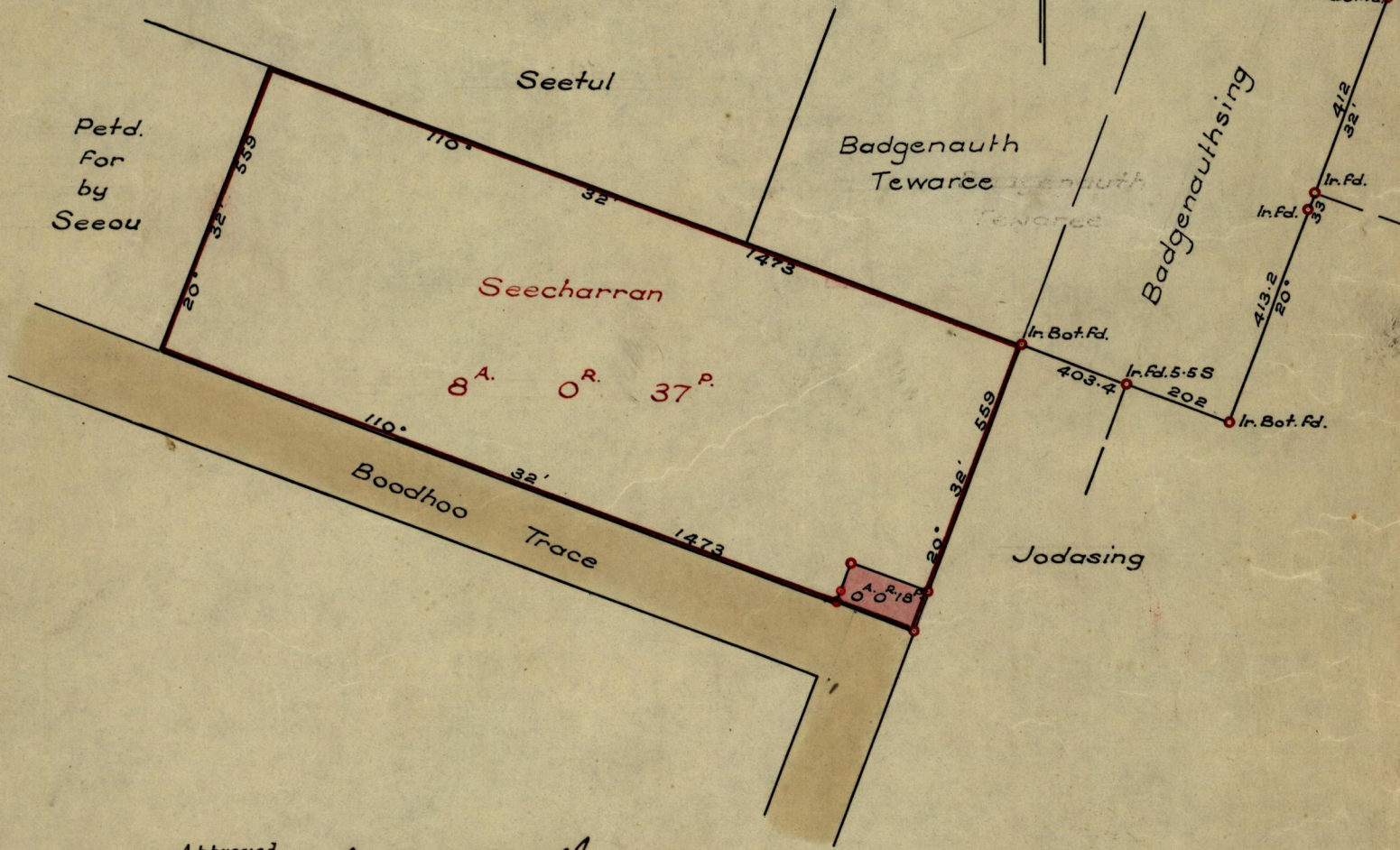

Approved

Lud. E. Farwell

Director of Surveys
15/2/61

SCALE 1:2500
minutes Distances are in links.

Note: To obtain compass bearings add/subtract 2

PLAN of a Parcel of land coloured pink in the Ward of Naparima
Containing Eighteen perches.

Surveyed by me, with due authority, in June 1960

I certify that I have complied with rule 76 under Section 14 (2) (d) of the Land Surveyors' Ordinance 1952, and that this plan is correct.

Checked by *G.D.F.*

Albert H. Hayes
Land Surveyor, Trinidad 2nd July 1960