

No 30435

957

12

R.P.O. Vol
C.T. Vol. 655

Fol.
Fol. 133

Ward of Naparima
County of Victoria
Cadastral Sheet G.13.B

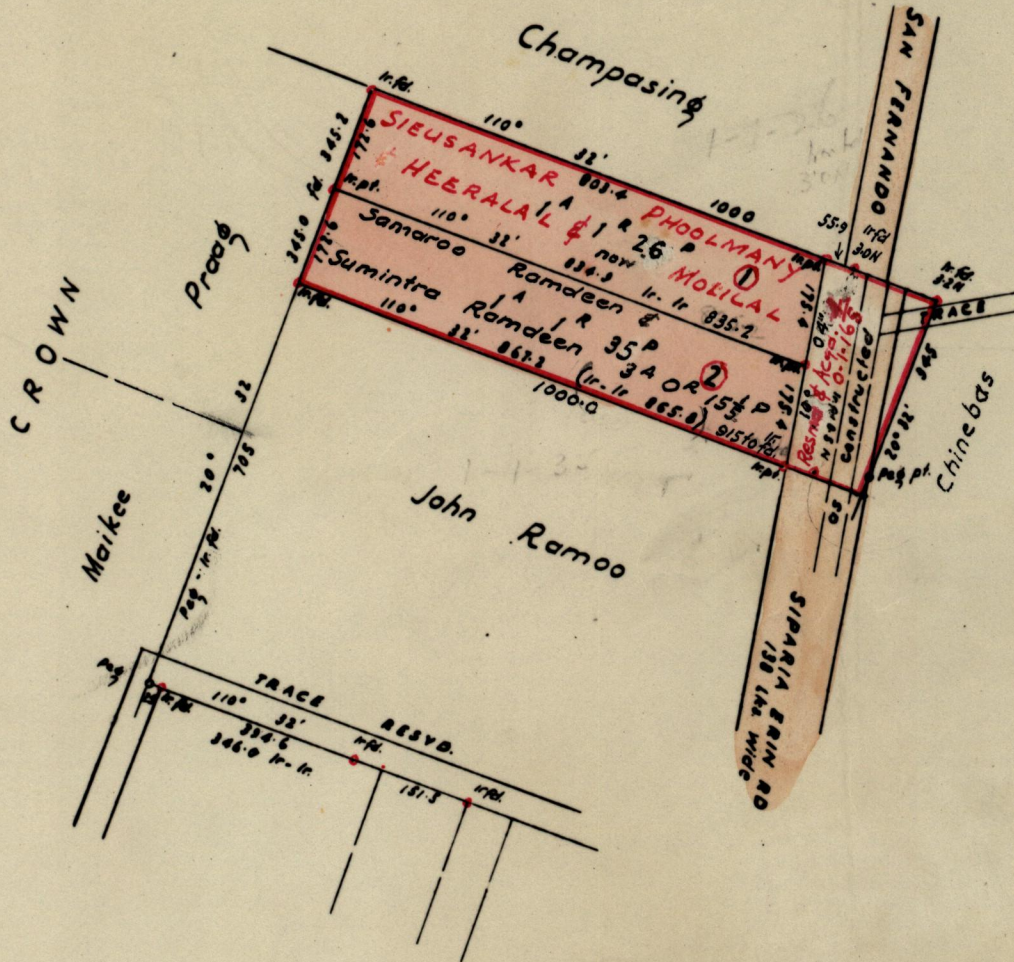
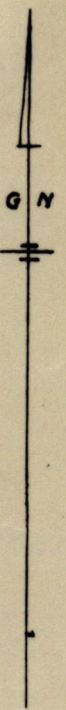

Approved

G.H. Small

Director of Surveys
18-6-71

SCALE 1:2500

Note: To obtain compass bearings ^{Two} add/subtract 2 minutes Distances are in Links
PLAN of a Parcel of land coloured pink in the Ward of Naparima
Containing together Two acres three roods and twenty one perches
Surveyed by me, with due authority, in April 1971

I certify that I have complied with rule 76 under Section 14 (2) (d) of the Land Surveyors' Ordinance 1952, and that this plan is correct.

Checked by *L.F.W. 15/6/71*

Land Surveyor, Trinidad

M.H. O'Neil

24th May 1971