

No 15683

R.P.O. Vol. 1663
C.T. Vol.

Fol 235
Fol

Ward of St. Ann's
County of St. George
Cadastral Sheet A.20.0.

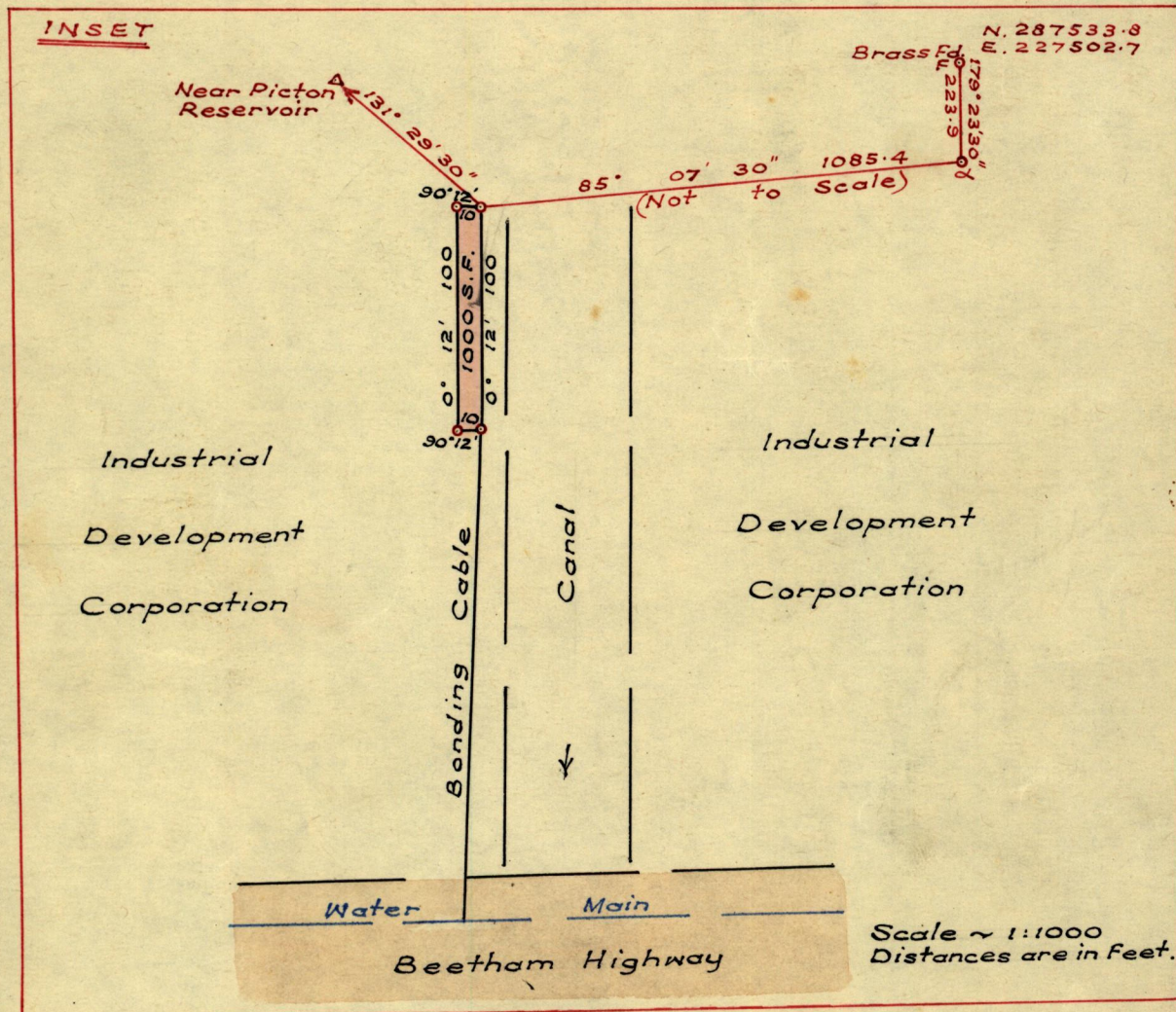
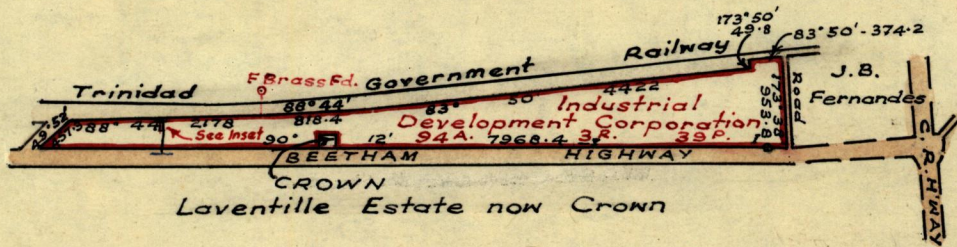

Approved

Fred E. Farrell

Director of Surveys

16. 12. 65
o denotes Iron put.

SCALE 1:25000

Note: To obtain true bearings add/subtract 2 minutes
Bearings are based on Solar observations. Distances are in feet

PLAN of a Parcel of land coloured pink in the Ward of St. Ann's
Containing one thousand square feet.

Surveyed by me, with due authority, in Sept. 1965

I certify that I have complied with rule 76 under Section 14 (2) (d) of the Land Surveyors' Ordinance 1952, and that this plan is correct.

Checked by *D. H. 17/65*

Phil Douglas

Entered

Land Surveyor, Trinidad

Oct 11th 1965

LANDS AND SURVEY RECORDS

Original survey on P.G. 31

X 39

Done

1880