

957  
L. H. A. ST. PATRICK, SIPARIA  
RECEIVED 24/2/65

104

Ward of Siparia  
County of St. Patrick  
Cadastral Sheet G.13.J.

This plan replaces plan no 15/64  
of 6/7/64

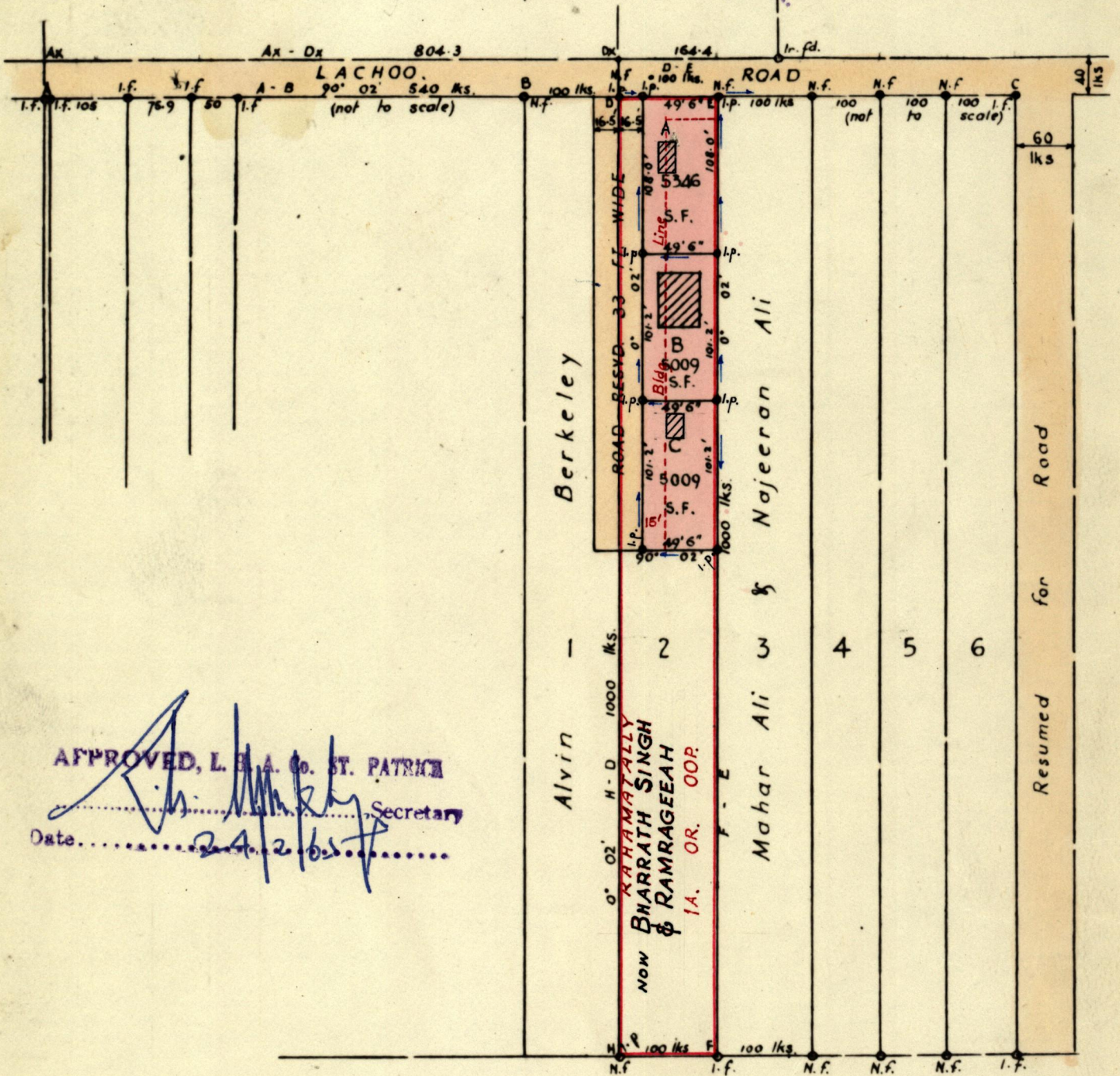
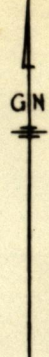

APPROVED, L. H. A. ST. PATRICK

*[Signature]* Secretary  
Date 24/2/65

N. F. = Noth. fd., I. F. = In. fd., I. p. = In. put

Approved

*[Signature]*  
Director of Surveys  
12. 3. 65.

SCALE 1:1250

Note: To obtain compass bearings subtract 2 minutes.

Dist are in Links & Feet

Plan of Three Parcels of Land, coloured pink, in the Ward of Siparia  
Containing together fifteen thousand, three hundred & sixty-four sq. feet  
Surveyed by me, with due authority, in December 1964

I certify that I have complied with rule 76 under Section 14 (2) (d) of the Land Surveyors' Ord. 1952, and that this plan is correct.

Checked by *[Signature]* 1/12/65

*[Signature]*  
Land Surveyor Trinidad 12<sup>th</sup> January 1965

Entered .....

LANDS AND SURVEYS DEPARTMENT RECORDS



Original in Bk 798 fo 178

*[Faint, illegible handwritten notes]*

*[Faint, illegible handwritten notes]*