

3436

REMAINING PORTION

L. & S.—56

5834

R.P.O. Vol. 95 Fol. 513

350

Cadastral Sheet G.13. M. 63.E. 4/d.

C. of T. Vol. 2151 Fol. 113.B

Ward of Siparia.

County of St. Patrick.

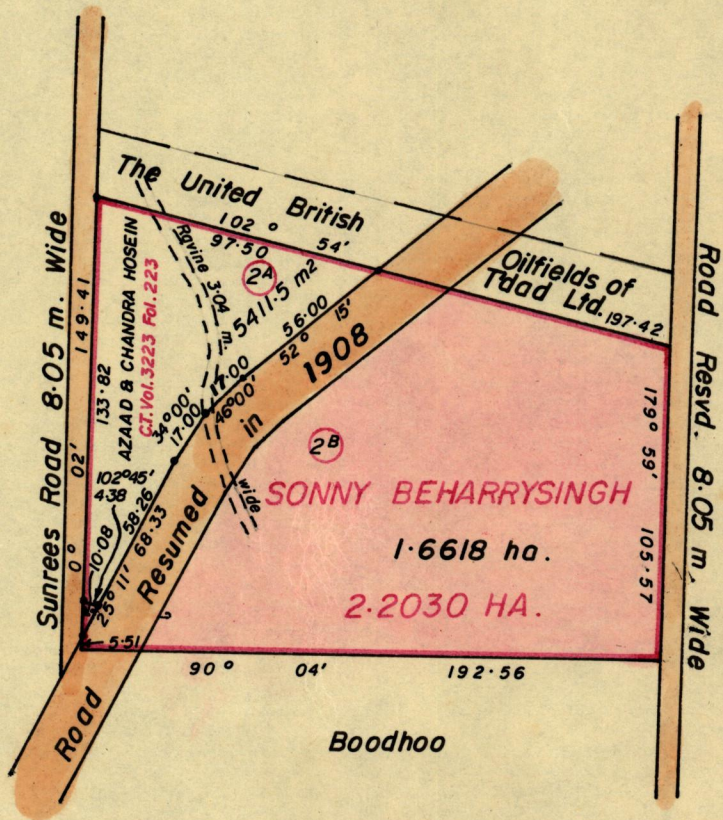
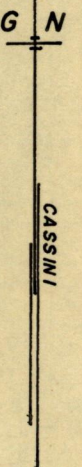

Approved

Alwyn Thidji
Director of Surveys
88.09.28

SCALE 1:2500.

Note: To obtain compass bearings ^{add} 3 minutes _{subtract}

Distances are in metres.

This is a true copy of a diagram of two point two zero three zero hectares originally transferred granted to SONNY BEHARRYSINGH, shewing a portion coloured pink and containing one point six six one eight hectares being the remainder after one (1) previous transfer of another portion of the land. 14(2)(d) of the Land Surveyors Ordinance 1952 the dividing lines having been run in conformity with Rule 76 under Sec. 7 (a) of Cap. 27. No. 2 and duly certified by the Director of Surveys.

Checked by *[Signature]* 2/9/87
Entered on

Winton Ramcharan
Land Surveyor, Trinidad, 15th September 1988

