

950

547

No 15730

R.P.O. Vol. 791
C.T. Vol.

Fol. 93
Fol.

Ward of Matura
County of St. Andrew
Cadastral Sheet C.14.B. 16 C.
1/c.

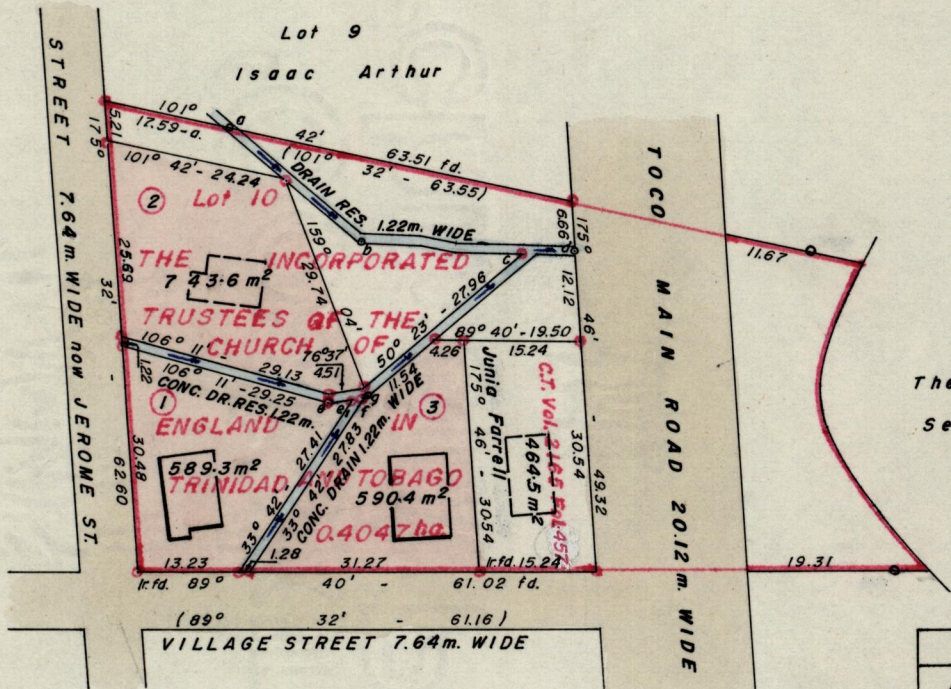

LEGEND

STA.	BEARINGS	DIST.
e - f	76° 37'	4.35
f - g	76° 37'	0.43
f - c	48° 20'	28.76
a - b	129° 43'	23.87
b - c	94° 42'	21.95
c - d	85° 10'	6.45
e - e ₁	76° 37'	2.79

Lots 38 & 39

See Bk. 1003 Fol. 139

Approved

Alonso Rodriguez
 Director of Surveys
 88.08.26

Denote Iron put except otherwise stated

SCALE 1:1,000

Note: To obtain compass bearings add/~~subtract~~ 28 minutes

Distances are in metres

PLAN of 3 Parcelsof land coloured pink in the Ward of Matura

Containing together one thousand nine hundred and twenty three point three square metres

Surveyed by me, with due authority, in January 1988

I certify that I have complied with rule 76 under section 14(2)(d) of the Land Surveyors' Ordinance 1952, and that this plan is correct.

Checked by *GR 23/8/88*

Anthony Peter Steans
 Land Surveyor, Trinidad
 27 July 1988

Entered

1992

BK. 740 fol. 110
(Original Survey)

