

950

L. & S.—54

462

Nº 45556

R.P.O. Vol. 1
C.T. Vol. 26

Fol. 329
Fol. 655

Ward of *La Brea*
County of *St. Patrick*
Cadastral Sheet *G 6.N.*

G. N.

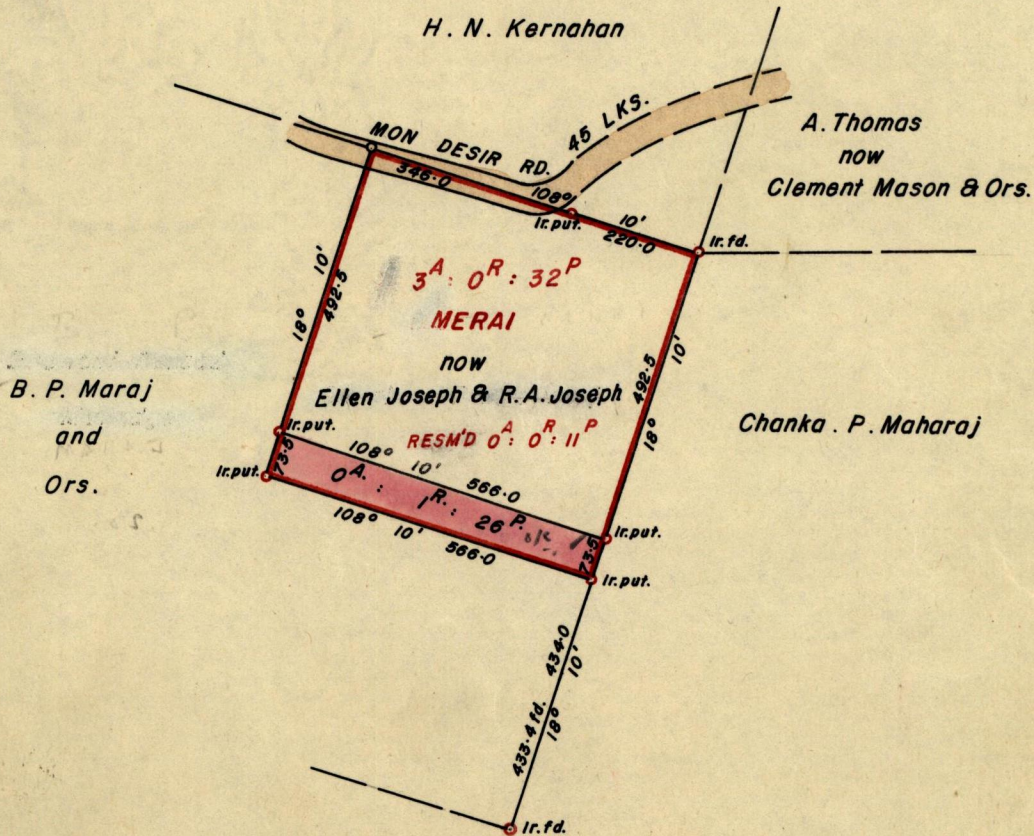

Approved

John Samuel
Director of Surveys

SCALE ~1:2500

minutes Distances are in links.

Note: To obtain compass bearings add/subtract

PLAN of a Parcel of land coloured pink in the Ward of *La Brea*

Containing one rood and twenty-six perches

Surveyed by me, with due authority, in *October 1979*.

I certify that I have complied with rule 76 under Section 14 (2) (d) of the Land Surveyors' Ordinance 1952, and that this plan is correct.

Checked by *L. J. L. 8/9/80*

Land Surveyor, Trinidad

John Samuel
16th January 1980

for Original see 456 for 24

204

(10)

