

950  
350

341

Nº 45405

R.P.O. Vol. 68  
C.T. Vol. 940

Fol. 289  
Fol. 75

Ward of Siparia  
County of St. Patrick  
Cadastral Sheet G. 13. B8 F

REMAINING PORTION

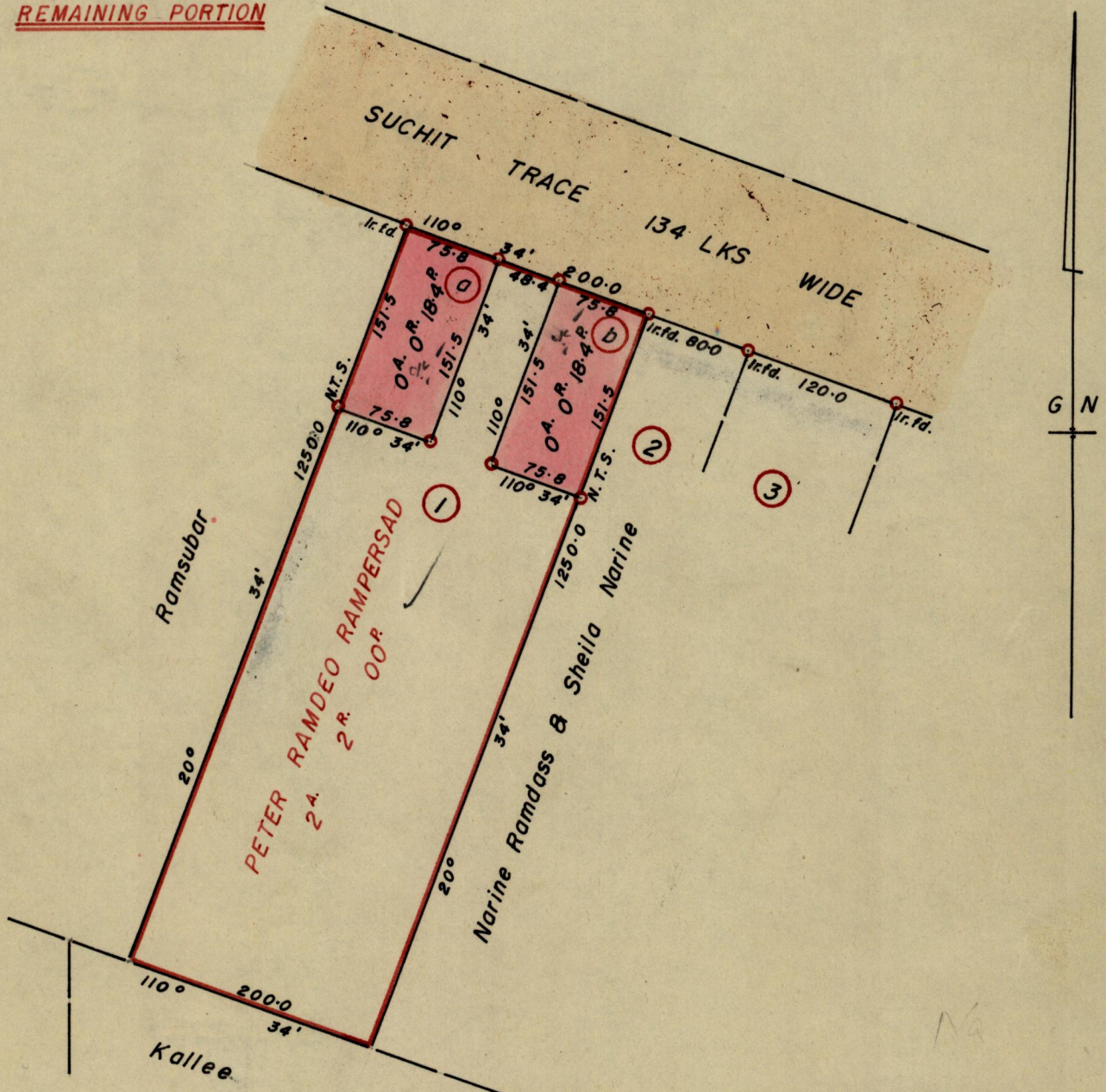

Iron put at all corners except otherwise shown

Approved  
*[Signature]*  
Director of Surveys

SCALE 1 : 1000

Note: To obtain compass bearings ~~add~~ subtract 4 minutes Distances are in L ks.

PLAN of 2 Parcels of land coloured pink in the Ward of Siparia

Containing together thirty six point eight perches

Surveyed by me, with due authority, in Jan. 1980

I certify that I have complied with rule 76 under Section 14 (2) (d) of the Land Surveyors' Ordinance 1952, and that this plan is correct.

Checked by *[Signature]*

*[Signature]*

Entered.....

Land Surveyor, Trinidad ..... 28/1/1980

Original: EK 1005 P8133

1005

1005

1005

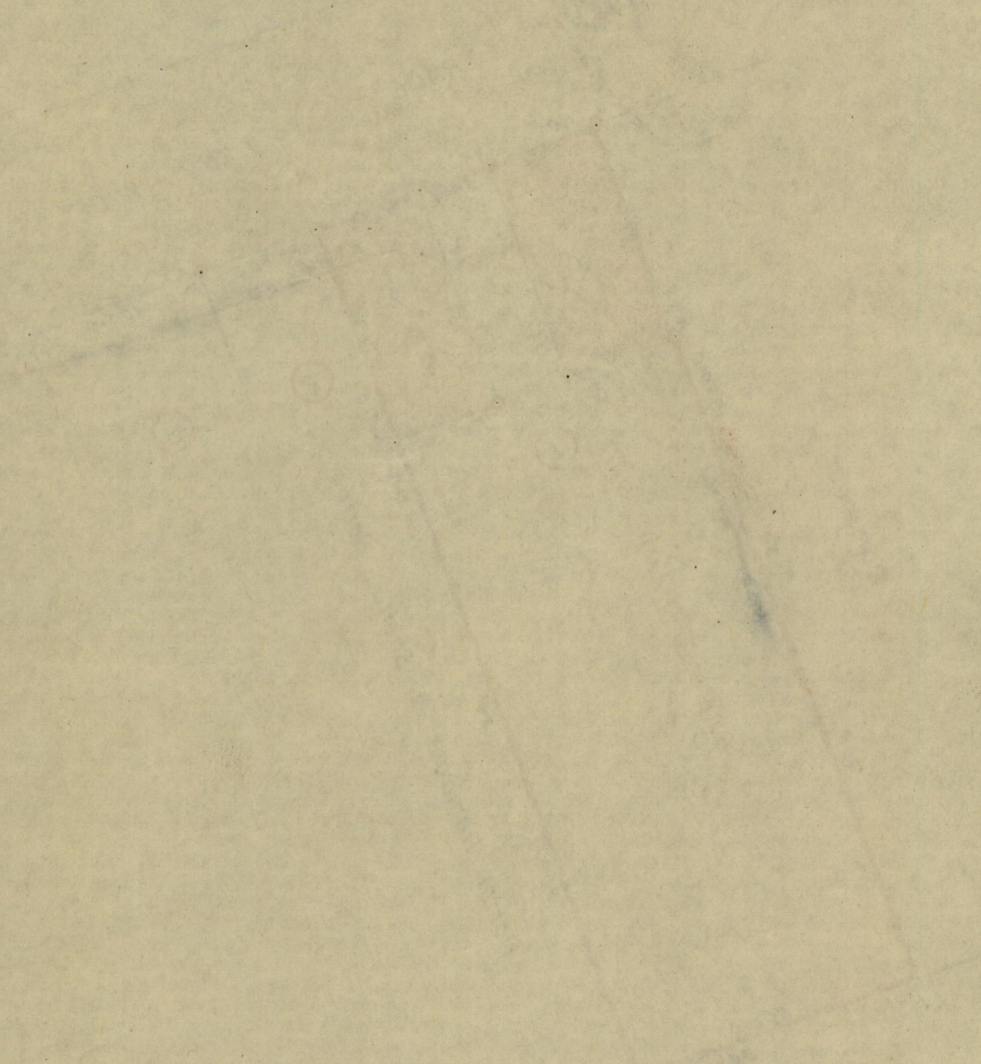

1005

Faint, illegible text at the bottom of the page, possibly a title or reference information.