

No 21038

95()

314

R.P.O. Vol. 70
C.T. Vol. 633

Fol. 29
Fol. 369

Vol. 1901 Sel 155

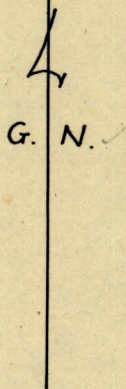

Ward of Siparia
County of St. Patrick
Cadastral Sheet G.13. E. & F.

Ramdane Mahradge

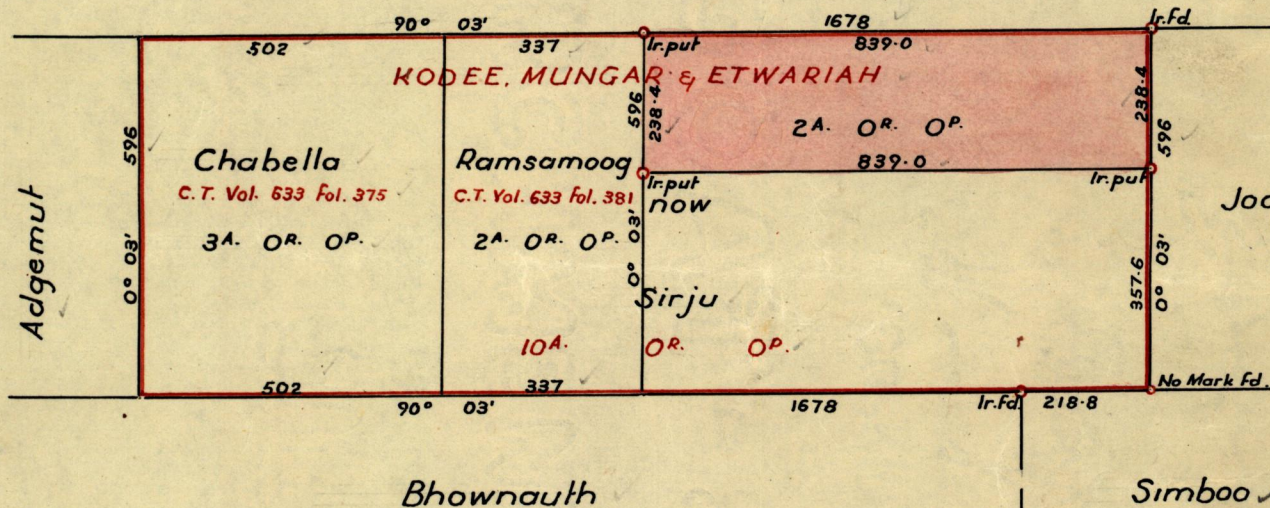

Approved

R. H. Farrell

Director of Surveys
25.11.68

SCALE 1 ~ 2500

Note: To obtain compass bearings ~~add~~/subtract 3 minutes Distances are in links

PLAN of a Parcel of land coloured Pink in the Ward of Siparia
Containing Two acres

Surveyed by me, with due authority, in July 1967

I certify that I have complied with rule 76 under Section 14 (2) (d) of the Land Surveyors' Ordinance 1952, and that this plan is correct.

Checked by *[Signature]* 20.11.68

Winston R. [Signature]

Entered

Land Surveyor, Trinidad July 24th 1967

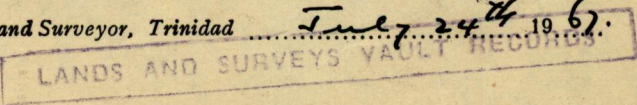

BR 722 fol 186 + 187

for previous sub-divisions

BR 722

BR 722

Faint, illegible text at the bottom of the page, possibly bleed-through from the reverse side.