

Nº 44632

950

312

R.P.O. Vol. 204
C.T. Vol. 723

Fol. 181
Fol. 117

Ward of *Tomono*
County of *St Andrew*
Cadastral Sheet *E.1.F.*

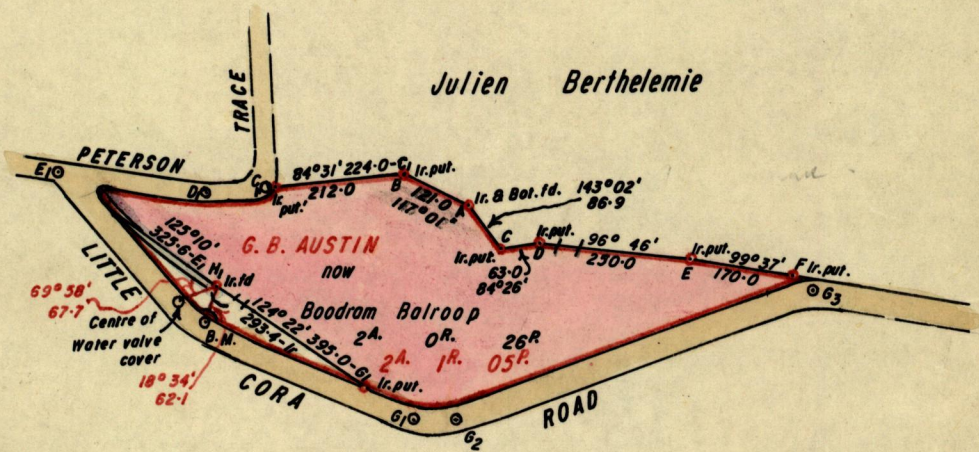
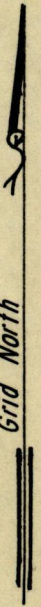

G ₁ -G ₂	91° 02'	70-0
G ₂ -G ₃	70° 26'	627-5
G ₃ -F	302° 02'	40-0
C ₁ -D ₁	263° 11'	104-3
D ₁ -E ₁	278° 03'	237-0

Approved

Julien Berthelemie
28-1-80. Director of Surveys

SCALE 1: 2500

Note: To obtain compass bearings add/subtract 14

minutes Distances are in links

PLAN of a Parcel of land coloured pink
Containing two acres and twenty six perches

in the Ward of *Tomono*

Surveyed by me, with due authority, in *May & June 1979*

I certify that I have complied with rule 76 under Section 14 (2) (d) of the Land Surveyors' Ordinance 1952, and that this plan is correct.

Checked by *L.Y.D. 24/1/80*

Winston Ramcharne

Entered.....

Land Surveyor, Trinidad *23rd January 1980*

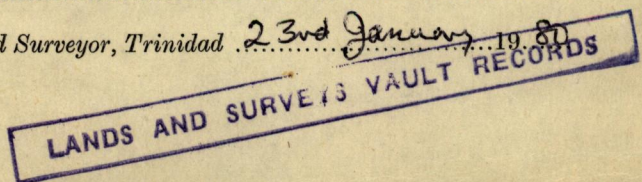

Original BK 192 fol 88

LIBRARY OF THE
MUSEUM OF NATURAL HISTORY
LONDON

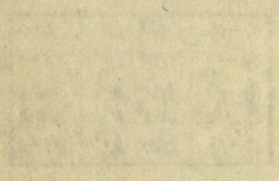
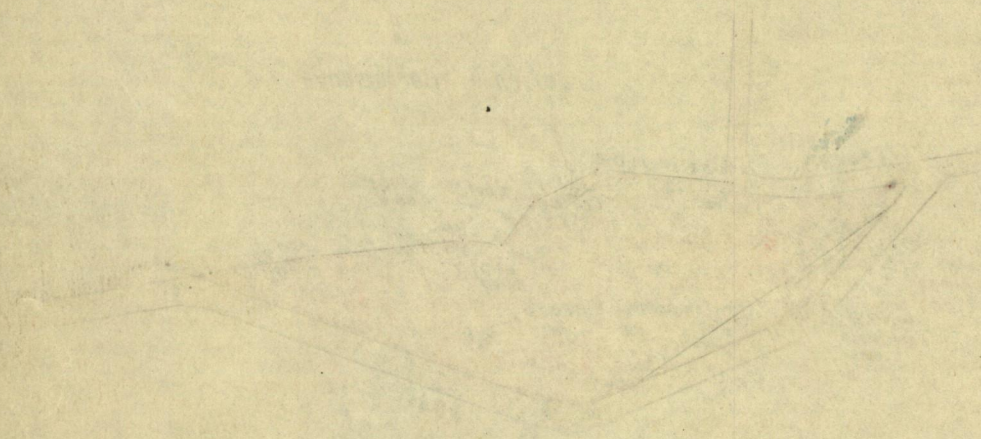

Faint, illegible text or markings at the bottom of the page, possibly bleed-through from the reverse side.