

Orig - BK 390:42

Cadastral Sheet G13J
Ward of SIPARIA
County of ST. PATRICK

R.P.O. Vol. 77 Fol. 187
C.T. Vol. 1010 Fol. 237

95(1)

966

3rd.

G.N. 306

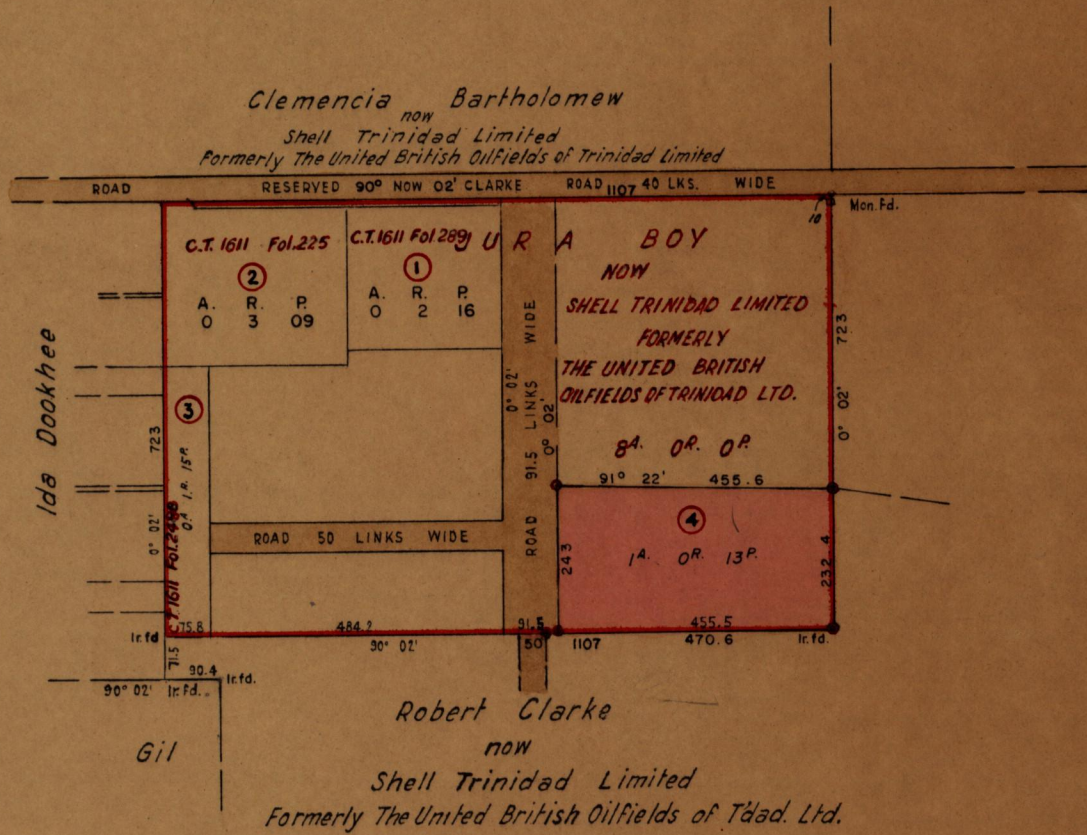

Approved

L.A. Fanell
Deputy Director of Surveys
30.10.67

SCALE: 1: 2500

NOTE: To obtain Compass bearings subtract 2 minutes
● Denotes Iron put

Distances are in Links

PLAN of a Parcel of Land coloured Pink in the Ward of SIPARIA
Containing One Acre and Thirteen Perches
Surveyed by me, with due authority in May 1966

I certify that I have complied with Rule 76 under Section 14 (2) (d) of the Land Surveyors Ordinance 1952 and that this plan is correct.

Checked by:

30/10/67

Robert Clarke

Land Surveyor, Trinidad,

9th October 1967.

LANDS AND SURVEYS VAULT RECORDS