

No 2770

950

264

R.P.O. Vol. Fol.
C.T. Vol. 101 Fol. 645

Ward of Naparima
County of Victoria
Cadastral Sheet G. 8. N & O. 633

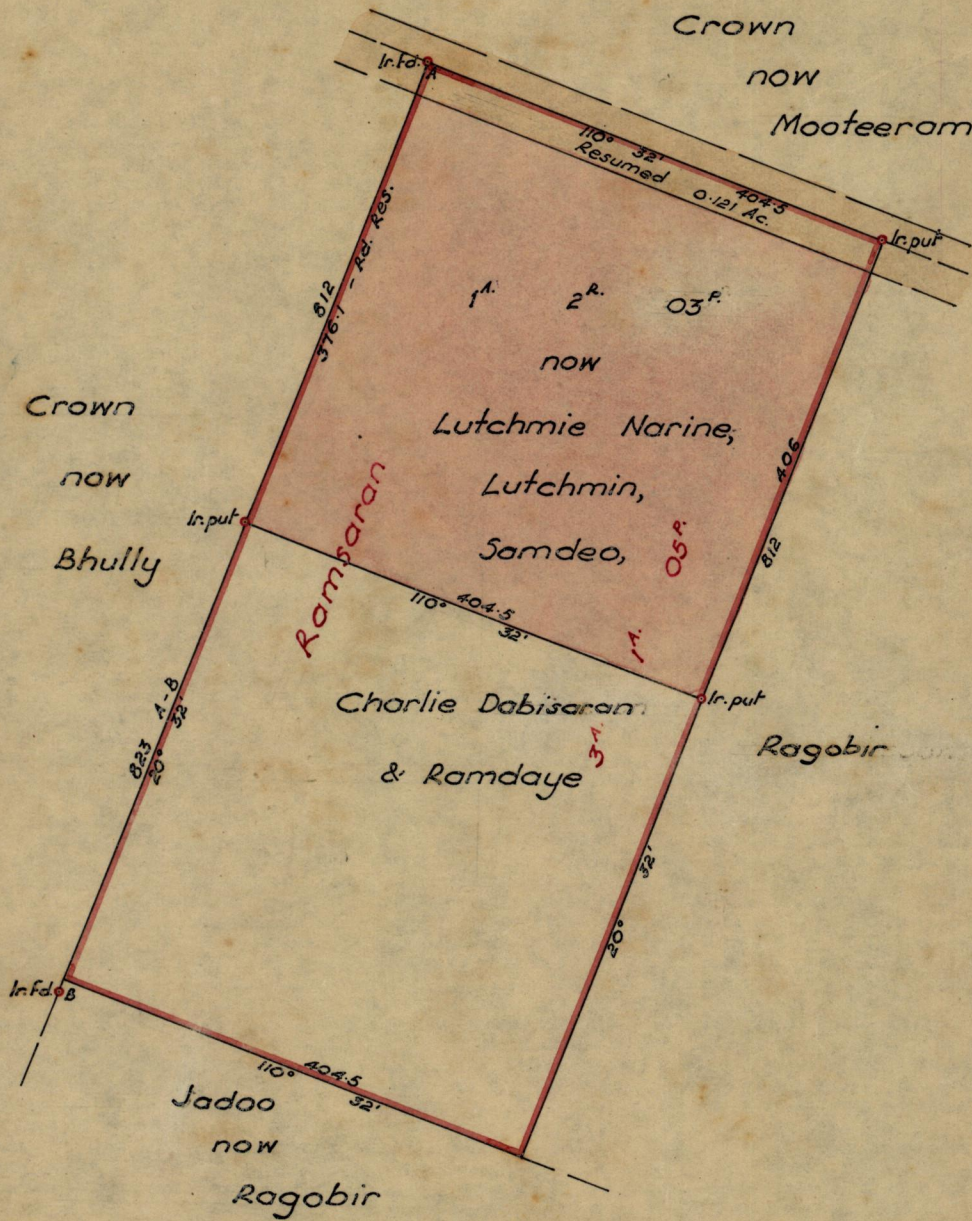

Approved

Lud. E. Farrell

Deputy Director of Surveys

27/5/59

SCALE ~ 1:1250

Note: To obtain compass bearings add/subtract 2 minutes Distances are in links

PLAN of a Parcel of land coloured pink in the Ward of Naparima

Containing One acre two roods and three perches

Surveyed by me, with due authority, in November 1955

I certify that I have complied with rule 76 under Sec. 74(d) of the Land Surveyors Ordinance 1952, and that this plan is correct

Checked by *CAS* 26.5.59

Winston Keeble

Entered

Land Surveyor, Trinidad November 30th 1955

LANDS AND SURVEYS VAULT RECORDS