

No 7390

950

261

R.P.O. Vol. 12 Fol. 77
 R.P.O. Vol. 751 Fol. 147
 C.T. Vol. 1293 Fol. 103
 " 120 " 279

Ward of Naparima
 County of Victoria
 Cadastral Sheet 69M.

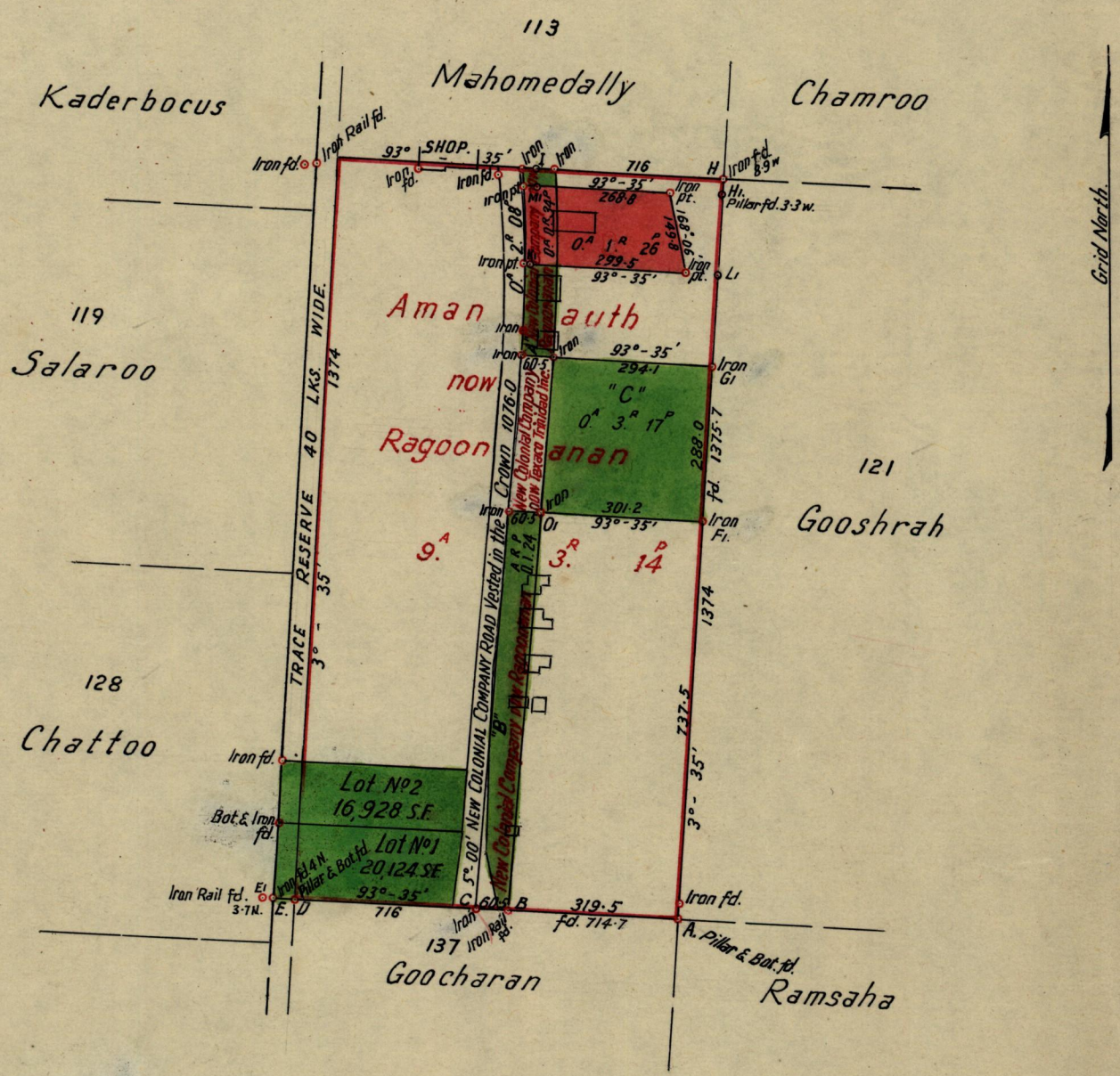

Approved

W. Hyder
 Director of Surveys
 11. 8. 61

SCALE 1: 2,500

Note: To obtain compass bearings add/subtract 0 minutes Distances are in links
 PLAN of ^{two} Parcel(s) of land coloured pink in the Ward of Naparima
 Containing ^{together} one rood and twenty six perches.

Surveyed by me, with due authority, in March, 1961 for a Lease to Texaco (Trinidad) Ltd.
 I certify that I have complied with rule 76 under Section 14 (2) (d) of the Land Surveyors' Ordinance 1952, and that this plan is correct.

Checked by *[Signature]* 10.8.61

HM - J. Overstep
 Land Surveyor, Trinidad 15th May 1961

10.9.61