

Nº 2054

950

257

R.P.O. Vol.
C.T. Vol. 971

Fol.
Fol. 59.

Ward of Naparima.
County of Victoria.
Cadastral Sheet G. 8. M. & N.

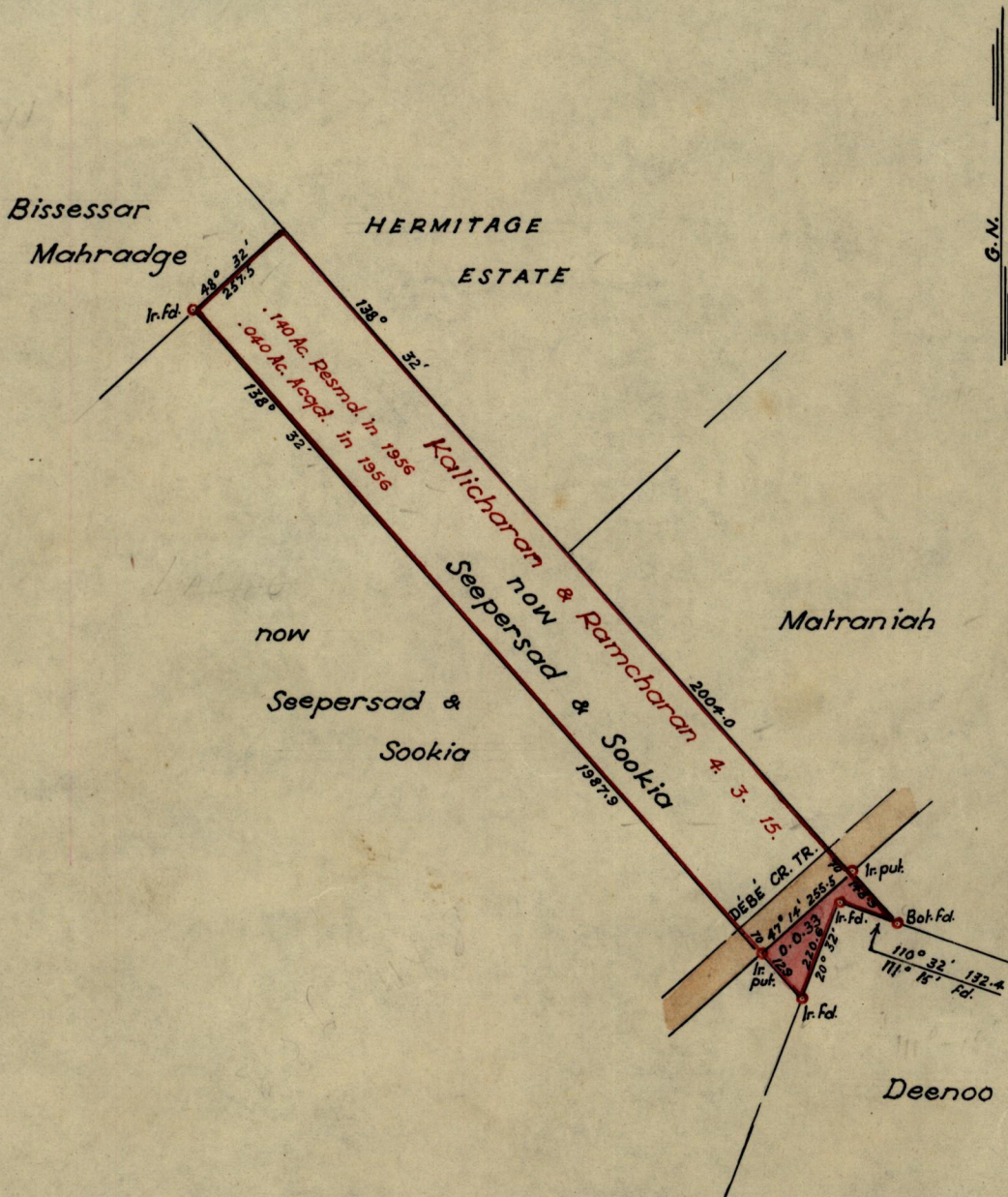

Approved

Lud. E. Savell

Ag. Dep. Director of Surveys
9. 12. 61

SCALE ~ 4 CHS. TO 1 INCH.
minutes Distances are in links

Note: To obtain compass bearings ~~add~~ subtract 2

PLAN of a Parcel of land coloured pink in the Ward of Naparima.
Containing thirty-three perches.

Surveyed by me, with due authority, in June 1960.

I certify that I have complied with rule 76 under Section 14 (2) (d) of the Land Surveyors' Ordinance 1952, and that this plan is correct.

Checked by..... *[Signature]* 6.12.61

Winston Keeble

Entered

Land Surveyor, Trinidad June 25th 1960