

Nº 22874

950

255

R.P.O. Vol. 23
C.T. Vol. 456

Fol. 565
Fol. 529

Ward of Naparima
County of Victoria
Cadastral Sheet G.8.N.

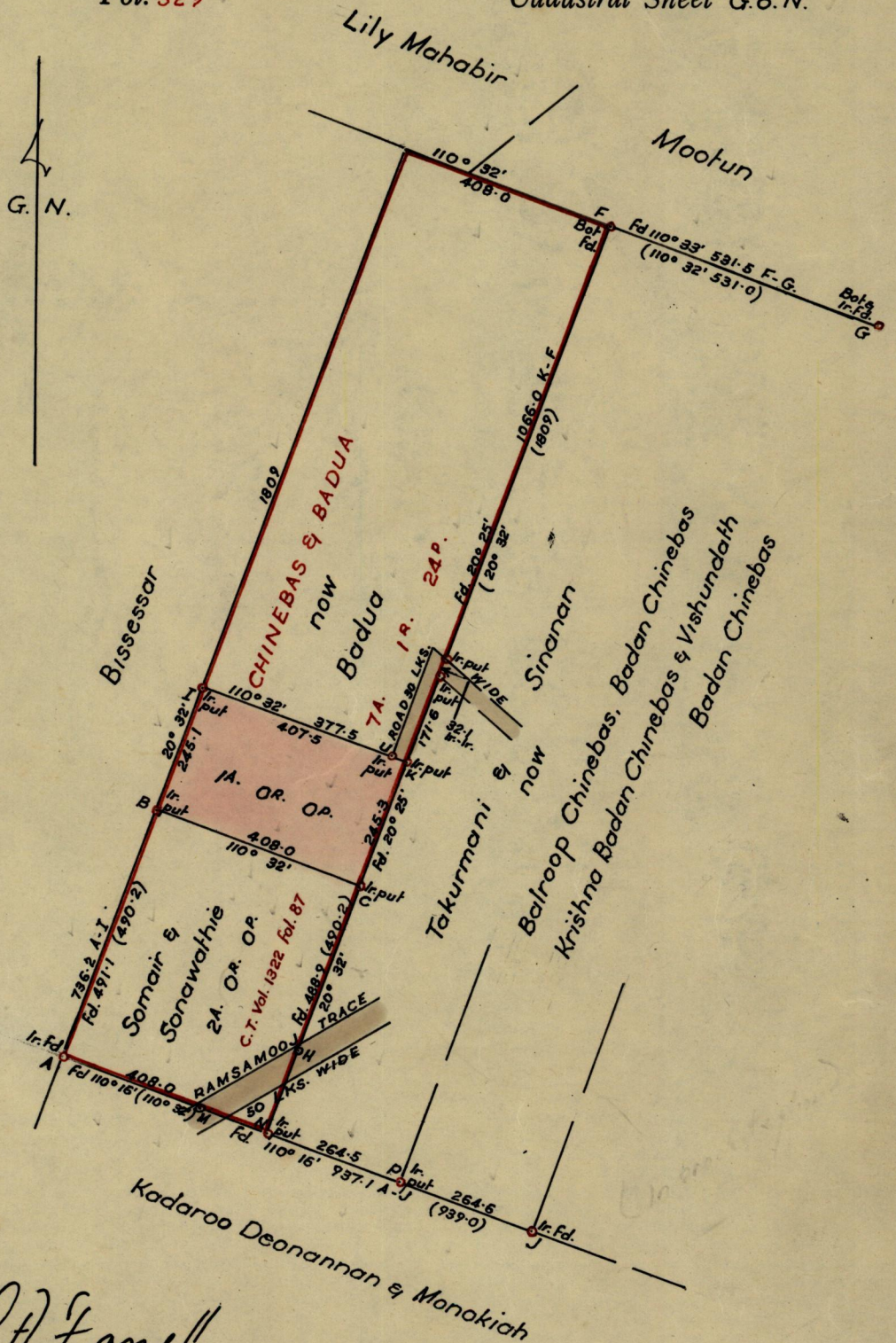

Approved

R. H. Farrell

Director of Surveys

11.2.69

SCALE 1 ~ 2500

Note: To obtain compass bearings ~~add~~ subtract 2 minutes Distances are in links

PLAN of a Parcel of land coloured Pink in the Ward of Naparima
Containing One acre

Surveyed by me, with due authority, in July 1966

I certify that I have complied with rule 76 under Section 14 (2) (d) of the Land Surveyors' Ordinance 1952, and that this plan is correct.

Checked by *[Signature]* 10/7/69

Entered

Land Surveyor, Trinidad

[Signature] 20th April 1968