

No 25914

950

219 GN

R.P.O. Vol. 27
C.T. Vol. 194

Fol. 387
Fol. 371

Ward of Siparia
County of St. Patrick
Cadastral Sheet G.11.L

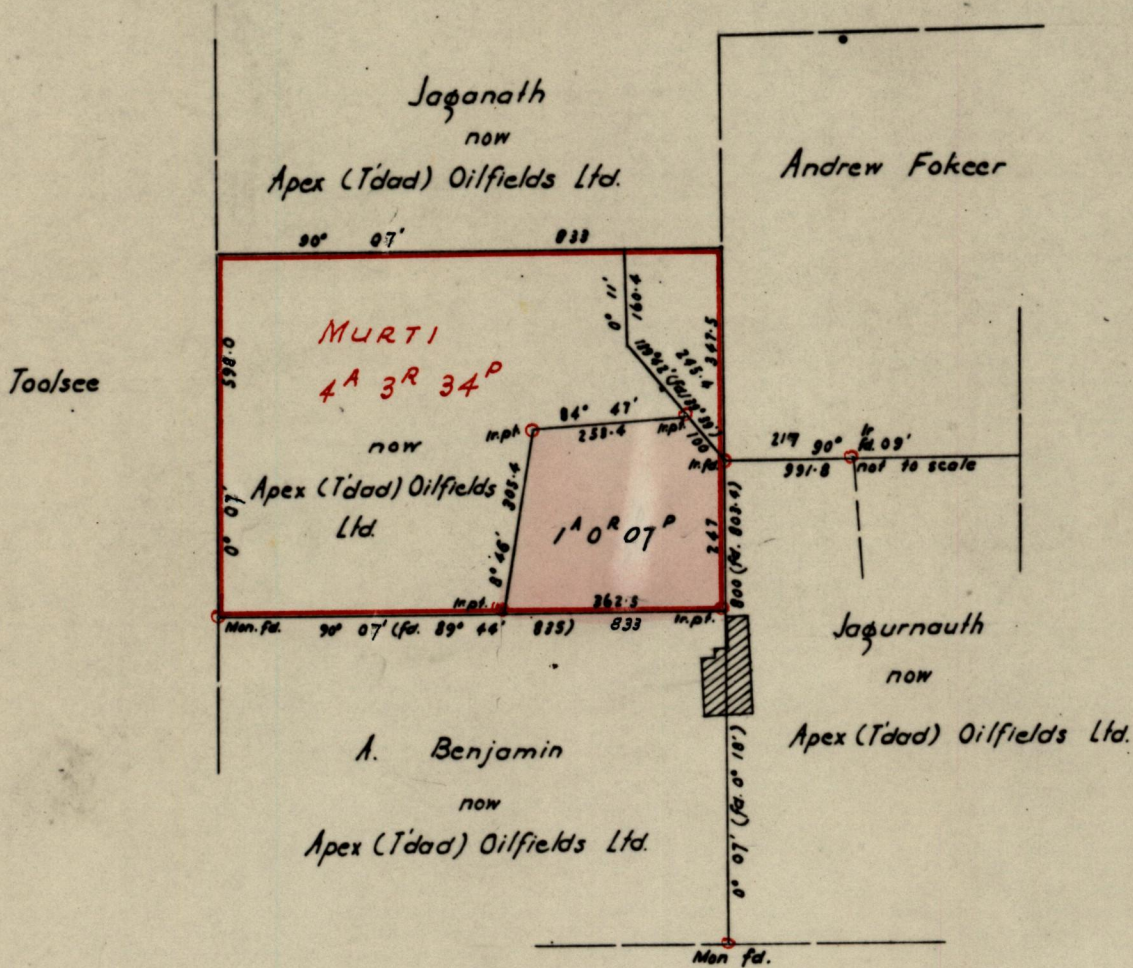

Approved

L. H. Farrell

Director of Surveys
13.10.69

SCALE 1:2500

Note: To obtain compass bearings add/subtract 7 minutes Distances are in Links

PLAN of a Parcel of land coloured pink in the Ward of Siparia

Containing One acre and seven perches

Surveyed by me, with due authority, in June 1969

I certify that I have complied with rule 76 under Section 14 (2) (d) of the Land Surveyors' Ordinance 1952, and that this plan is correct.

Checked by *MR G. J. 12.10.69*

Entered

Land Surveyor, Trinidad

W. H. ...
10th July 1969