

No 25916

950

218

R.P.O. Vol. 49
C.T. Vol.

Fol. 699
Fol.

Ward of Siparia
County of St. Patrick
Cadastral Sheet G.II.L

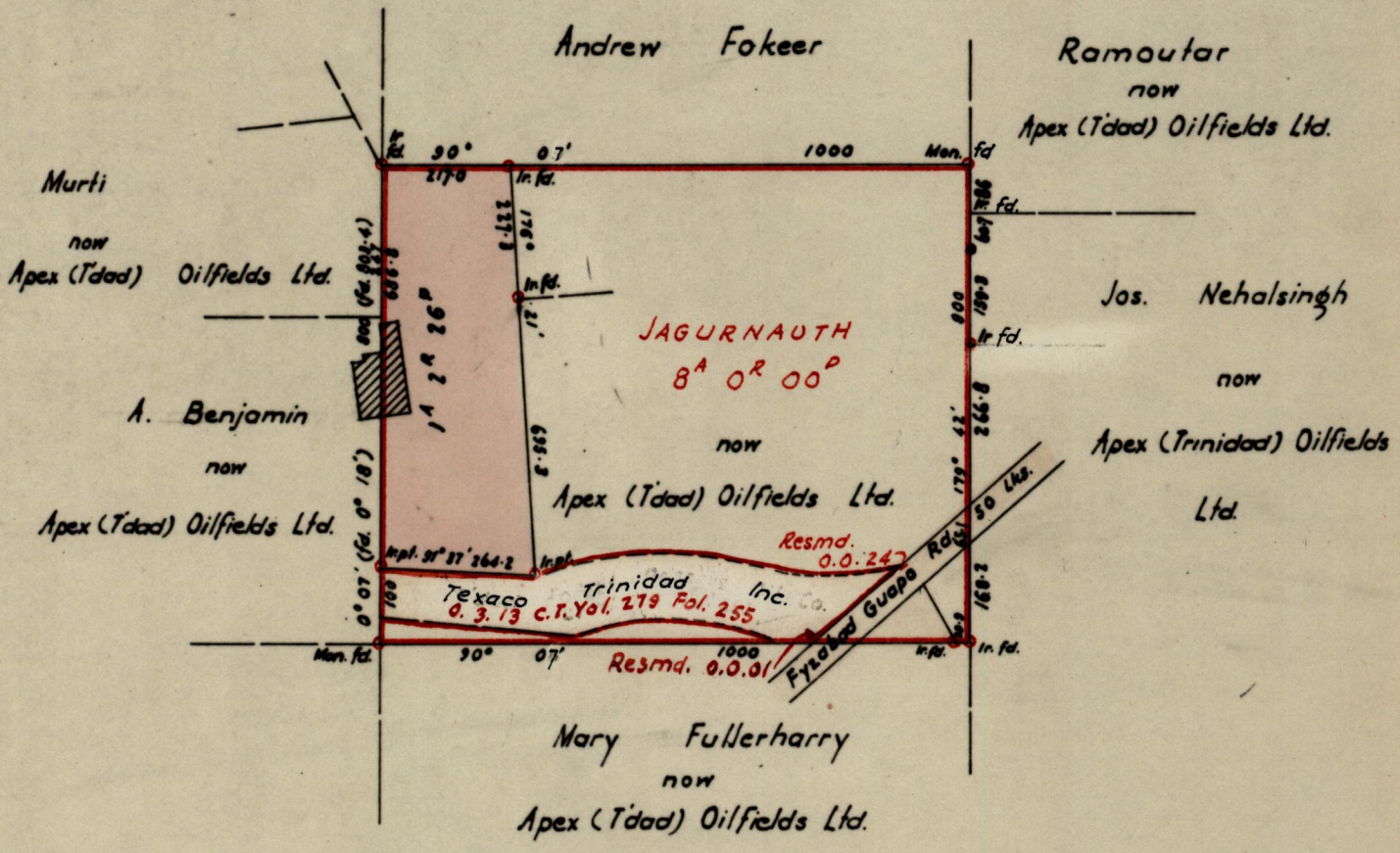
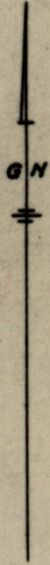

Approved

[Signature]

Director of Surveys
13.10.69

SCALE 1:2500

Note: To obtain compass bearings add/subtract 7 minutes Distances are in Links
PLAN of a Parcel of land coloured pink in the Ward of Siparia
Containing One acre two roods and twenty six perches
Surveyed by me, with due authority, in June 1969

I certify that I have complied with rule 76 under Section 14 (2) (d) of the Land Surveyors' Ordinance 1952, and that this plan is correct.

Checked by *[Signature]* 13.12.69

Entered

Land Surveyor, Trinidad

[Signature]
10th July 1969

