

No 16068

950

Ward of Siparia 2008
County of St. Patrick
Cadastral Sheet G.12.B

R.P.O. Vol. 64 Fol 1
C.T. Vol. 1356 Fol 161

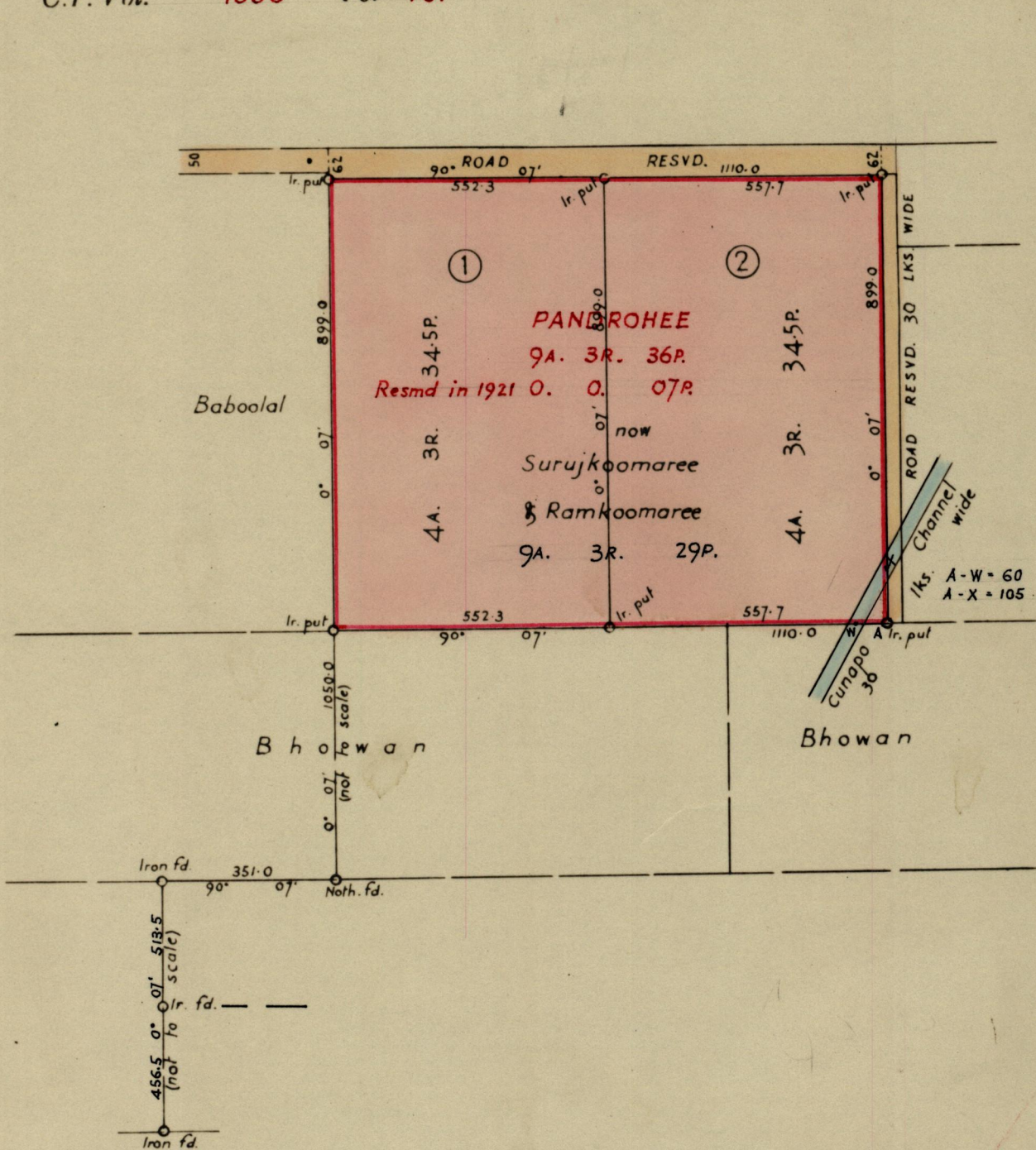

Approved

Fred. E. Farrell

Director of Surveys
18. 10. 65

SCALE 1: 2500

Note: To obtain compass bearings add/subtract 7 minutes Distances are in Links

PLAN of ^{Two} Parcel(s) of land coloured pink in the Ward of Siparia
Containing together Nine acres three roods and twenty-nine perches
Surveyed by me, with due authority, in June 1965

I certify that I have complied with rule 76 under Section 14 (2) (d) of the Land Surveyors' Ordinance 1952, and that this plan is correct.

Checked by *[Signature]* 15/10/65

Entered

Land Surveyor, Trinidad

[Signature]
2nd August 1965