

No 30445

95()

2006

R.P.O. Vol
C.T. Vol. 1506

Fol.
Fol. 298

Ward of Siparia
County of St. Patrick
Cadastral Sheet G.12. D

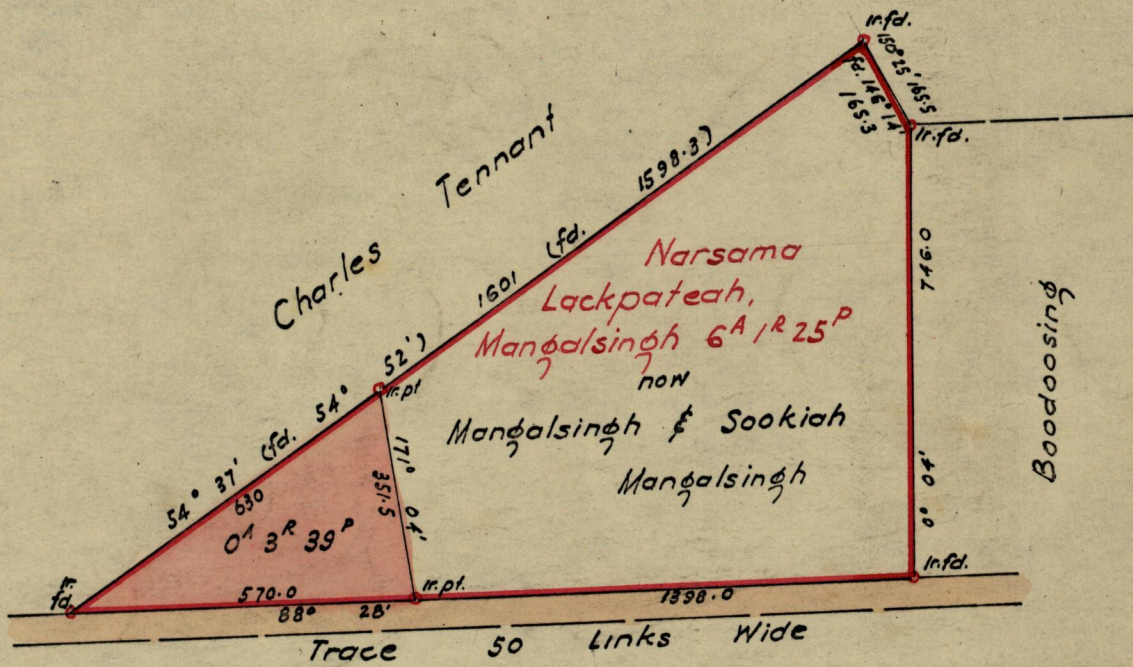

Approved [Signature]
Of Director of Surveys
10.8.71

SCALE 1:2500

Note: To obtain compass bearings ~~add~~ subtract 4 minutes Distances are in Lks.

PLAN of a Parcel of land coloured pink in the Ward of Siparia
Containing Three roods and thirty nine perches
Surveyed by me, with due authority, in June 1970

I certify that I have complied with rule 76 under Section 14 (2) (d) of the Land
Surveyors' Ordinance 1952, and that this plan is correct.

Checked by [Signature]

[Signature]
Land Surveyor, Trinidad 5th June 1970

Entered