

Orig ~ Bk. 408:19.

L. & S.—54

No 22696

950

173

R.P.O. Vol.
C.T. Vol. 1523
192

Fol.
Fol. 53
121

Ward of Siparia
County of St. Patrick
Cadastral Sheet G. 18.K

G N

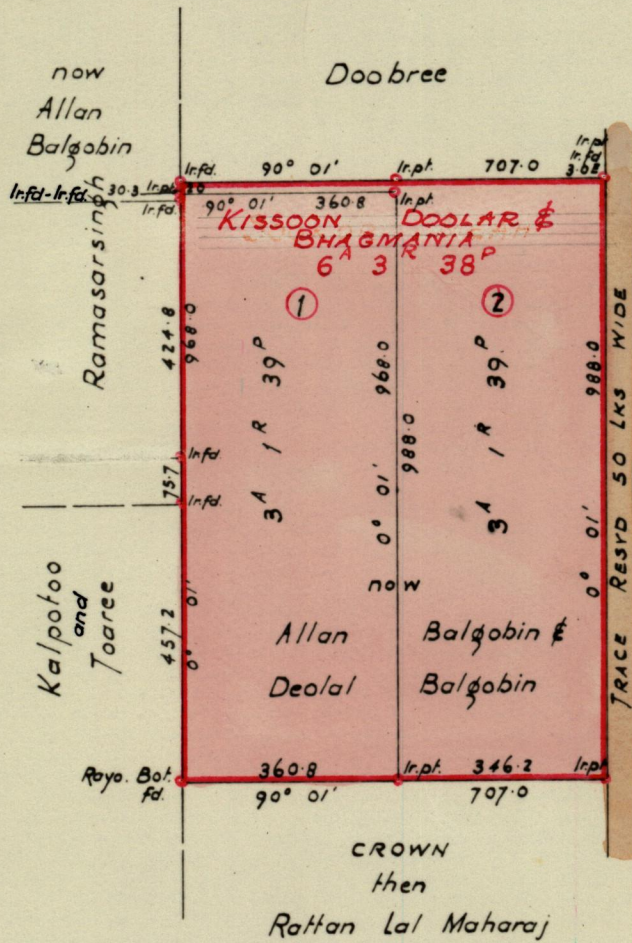

Approved

L. H. Farrell

Director of Surveys
2. 8. 68

SCALE 1:2500

Note: To obtain compass bearings ^{Two} add/subtract 1 minutes Distances are in Links

PLAN of 2 Parcels of land coloured pink in the Ward of Siparia
Containing together Six acres three roods and thirty eight perches
Surveyed by me, with due authority, in June 1968

I certify that I have complied with rule 76 under Section 14 (2) (d) of the Land
Surveyors' Ordinance 1952, and that this plan is correct.

Checked by

L. J. W. 1/6/68

L. J. W.

Entered

Land Surveyor, Trinidad

29th June 1968