

N<sup>o</sup> 7683

950

109

R.P.O. Vol. 267 Fol. 41  
C.T. Vol. 699 Fol. 497

Ward of Charuma  
County of Nariva  
Cadastral Sheet E16.G

GN

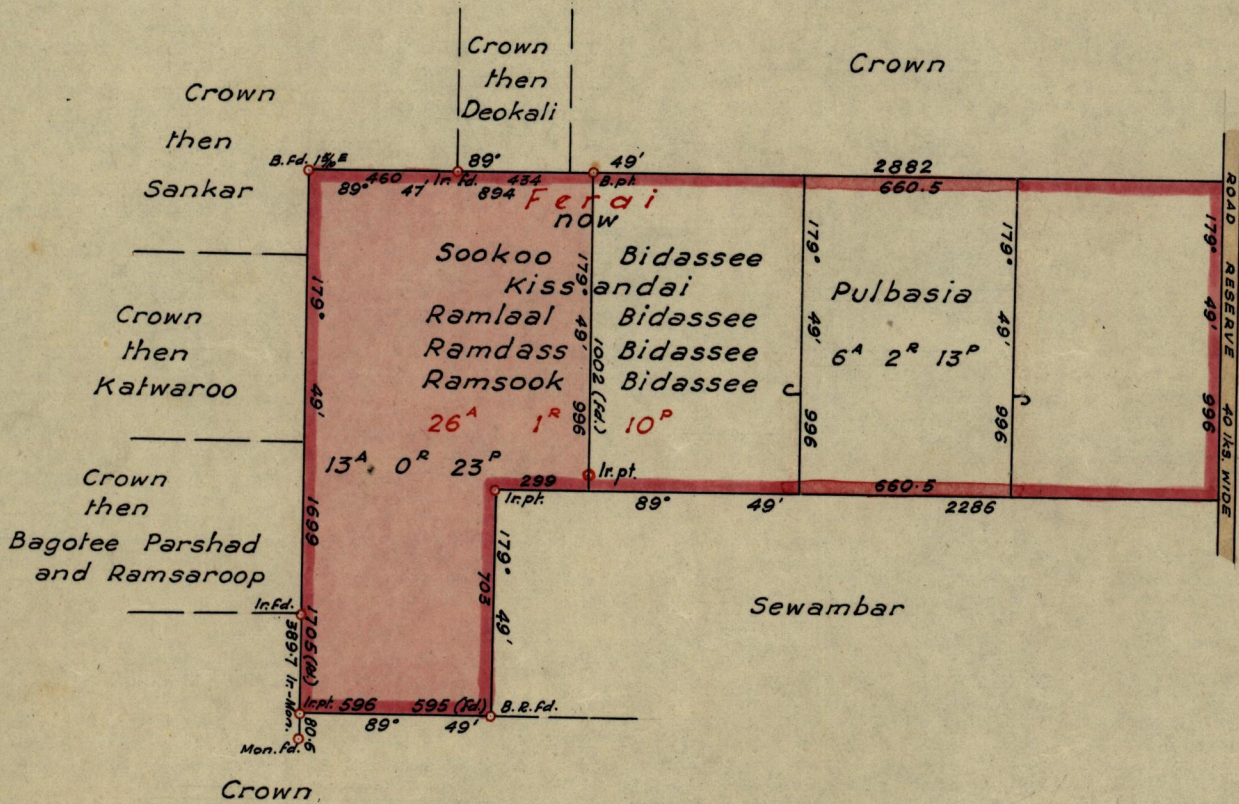

Approved

*Hamilton Murray*

Deputy Director of Surveys  
12.8.58

SCALE 6 chs. = 1"

Note : To obtain compass bearings add / subtract 11 minutes Distances are in Links

PLAN of a Parcel of land coloured pink in the Ward of Charuma  
Containing Thirteen acres, and Twenty-three perches.

Surveyed by me, with due authority, in June 1958.

I certify that I have complied with rule 76 under Sec. 7(2) of the Land Surveyors' Ordinance 1952, and that this plan is correct

Check by *1st class*

*Charles W. ...*

Entered .....

Land Surveyor, Trinidad 26 June 1958  
LAND SURVEYORS' FACT RECORDS