

R.P.O. Vol. 136 Fol. 629  
 CT.. Vol. 3728 Fol. 327

Ward of Siparia  
 County of St. Patrick  
 Cadastral Sheet G.13.N 63F  
 3/c

SIPARIA

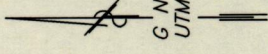

1656

Ir Fd (A) Fd (A)  
 (Nap. Datum Zone 20)  
 670160 m E  
 1122980 m N  
 Accuracy +/- 5m

Vide Bk. 397 Fol. 156  
 Vide Bk. 1155 Fol. 270

Bearings are UTM Grid based on Solar Observation

○ Denotes Iron Put unless otherwise stated

SCALE 1:1500

Distances are in Meters

34

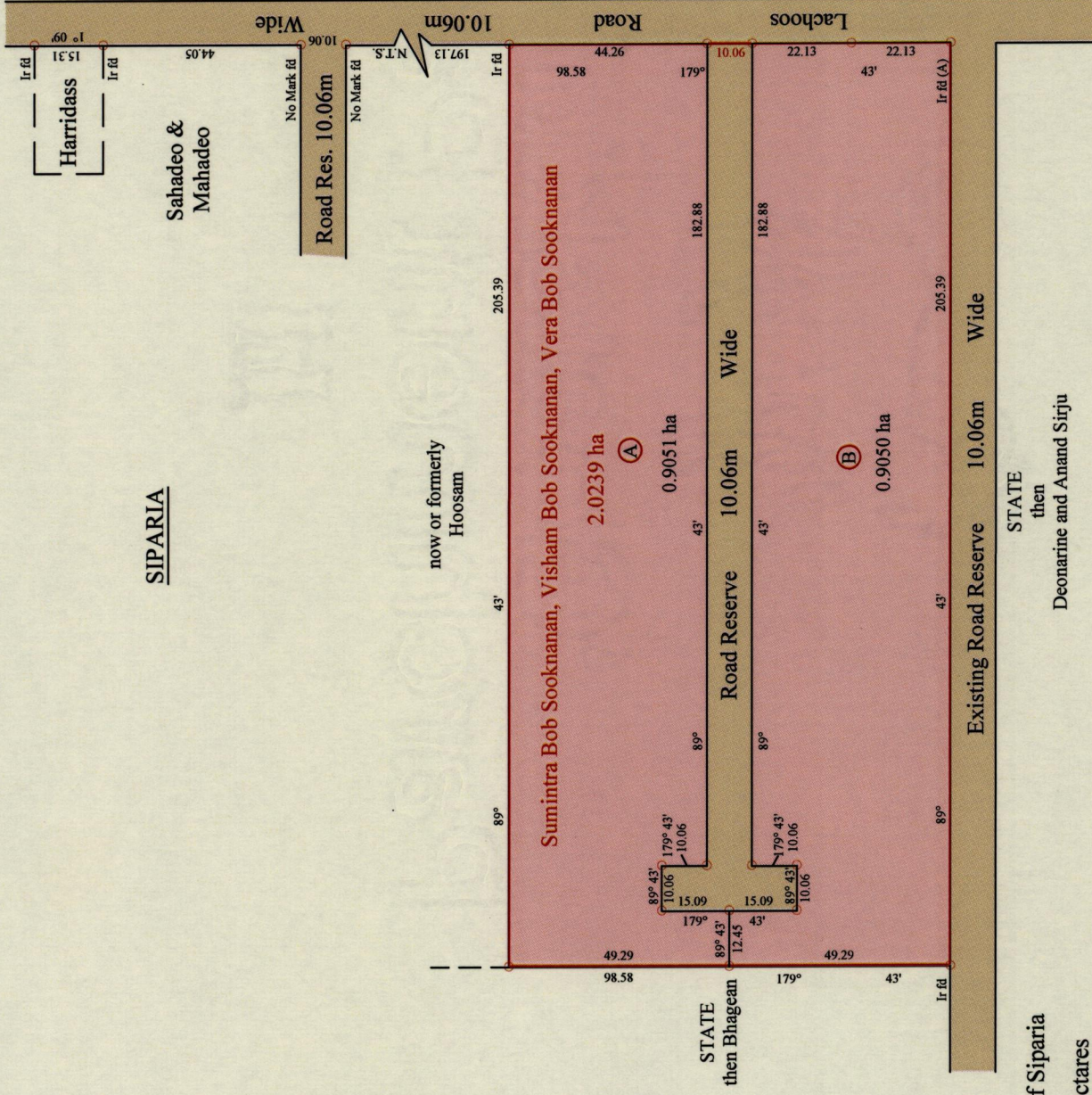

Director of Surveys  
*(Signature)* 27/4/15

Plan of two (2) Parcels coloured pink in the Ward of Siparia  
 Containing together one point eight one zero one hectares  
 Surveyed by me, with due authority, in November 2014  
 Certified correct in accordance with Regulation 25(1) of the Land Surveyors Regulations 1998

Checked by *R-01/04/15*

Entered on.....

Trinidad and Tobago Land Surveyor *20<sup>th</sup> February 2015*

*(Signature)*



1656/84