

R.P.O. Vol. Fol.
C. of T. Vol. 4808 Fol. 395

Cadastral Sheet A.20.B ^{13D} 2/d
Ward of St. Ann's
County of St. George

See PLAN F.I.53

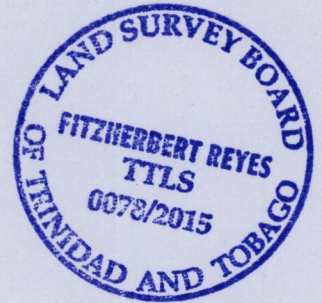
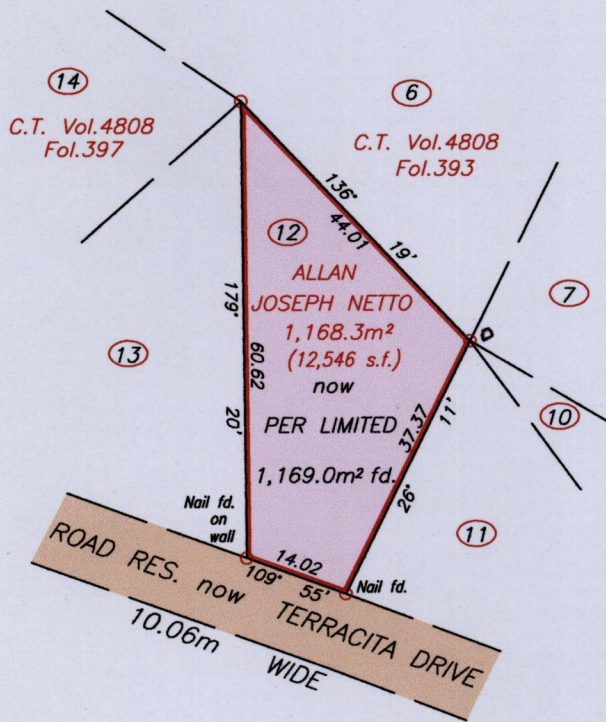
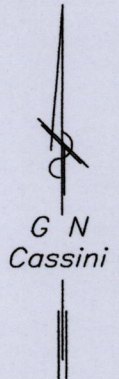

D = N 11815118 +/- 3.0m
E 662662
UTM 20 Naparima 1955
Hand Held GPS

Approved
Director of Surveys *21/4/15*

SCALE 1:1000
Distances are in METRES

- Denotes Iron found unless otherwise stated
- Bearings are Cassini Grid based on Solar observations
- To obtain Compass Bearing subtract 2 minutes

PLAN of a Parcel of land coloured pink in the Ward of St. Ann's
Containing one thousand one hundred and sixty nine point zero square metres
Surveyed by me with due authority in March 2014
Certified correct in accordance with Regulation 25 (1) of the Land Surveyors Regulations 1998.

Checked by
Entered on
JA Super T.T.L.S.
Trinidad & Tobago Land Surveyor *or March 20.15*

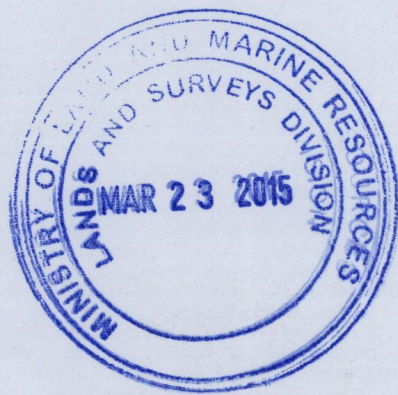

1656/73