

Vide Bk. 397 fol. 276
 Vide S/O 38/1905

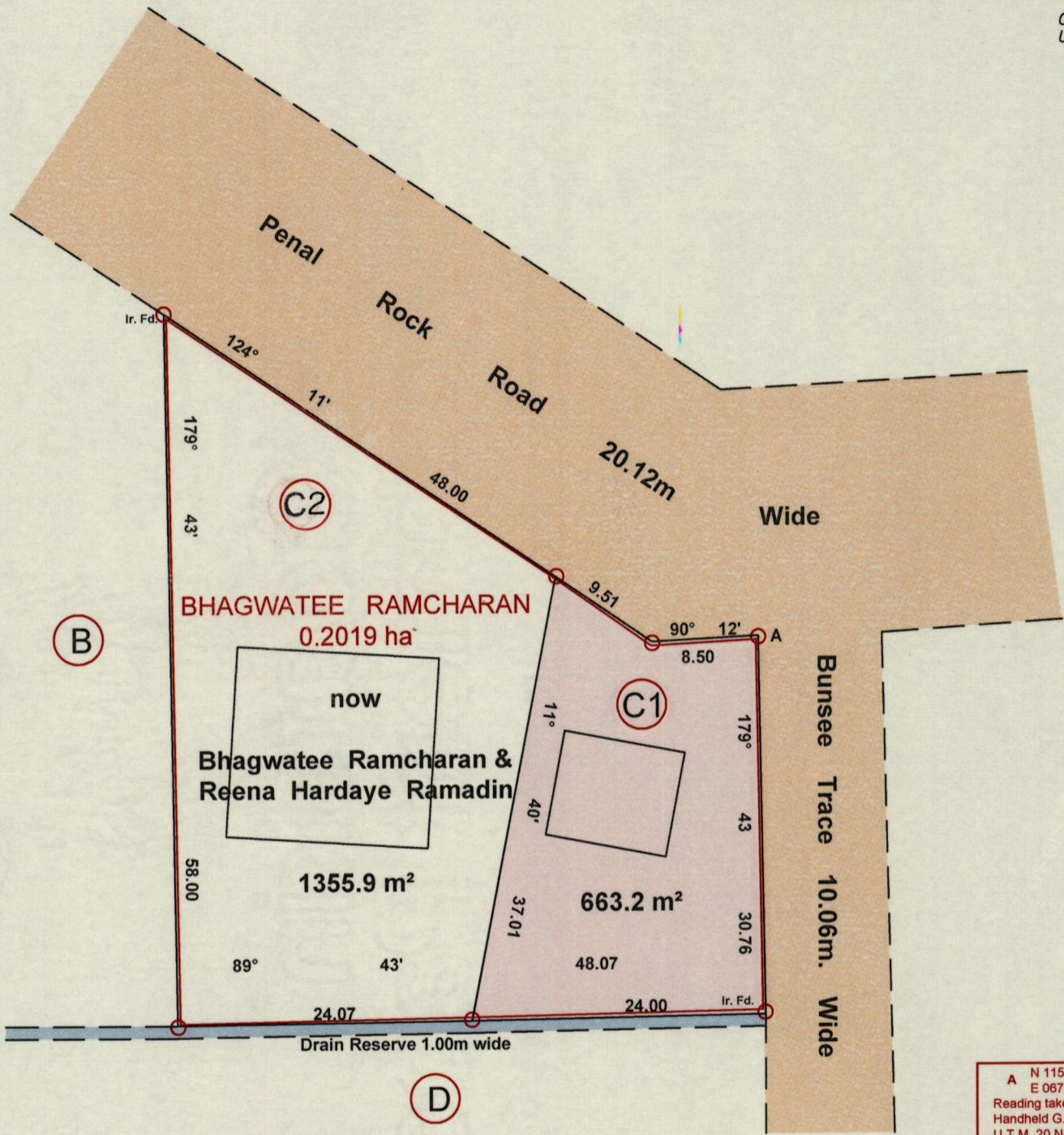
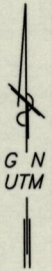

A N 1159234
 E 0672075
 Reading taken with
 Handheld G.P.S.
 U.T.M. 20 Naparima
 ± 5m.

Approved

[Signature]
 9/3/15

Director of Surveys

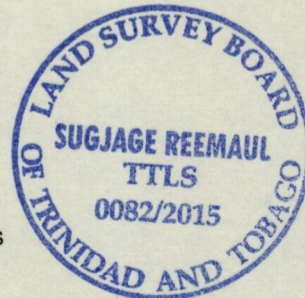

○ Denotes Iron put except stated otherwise.
 Note: Bearings are U.T.M. grid based on solar observations

SCALE 1:500
 Distances are in metres

PLAN of a parcels of land coloured pink in the Ward of Siparia
 Containing Six Hundred and Sixty Three point Two square metres
 Surveyed by me, with due authority, in February 2014.
 Certified correct in accordance with Regulations 25 (1) of the Land Surveyors' Regulations 1998.

Checked by *R - 05/03/15* *[Signature]*
 Entered on..... Trinidad & Tobago Land Surveyor *12th Feb*, 2015.

0631

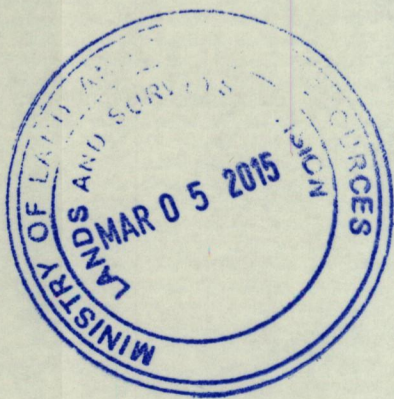

1656/37