

R.P.O. Vol. 28 Fol. 149
C.T. Vol. 3465 Fol. 357

Ward of Naparima
County of Victoria
Cadastral Sheet G 8 M & N 63.B.
4/d

73 Debe Trace, Debe.

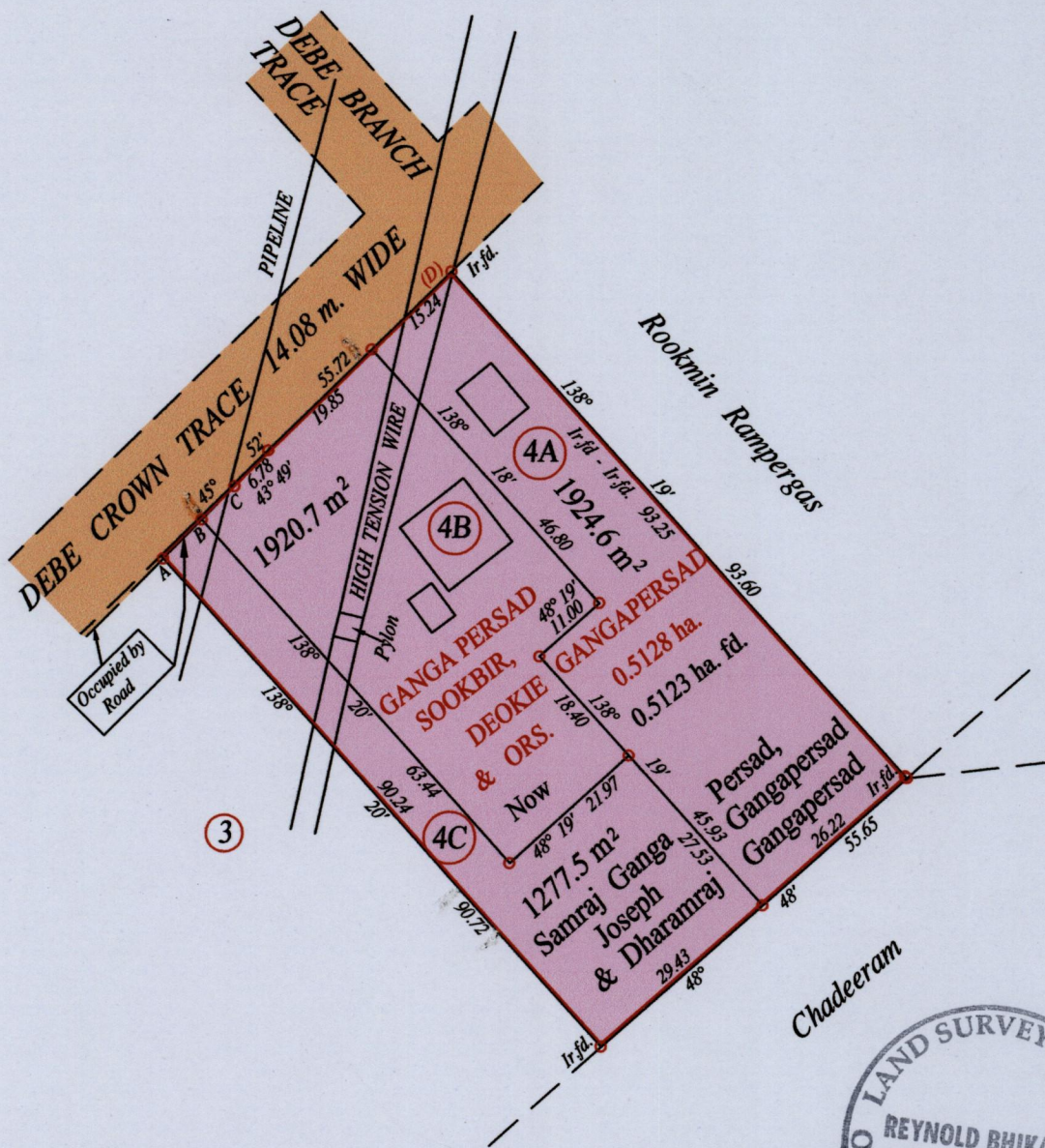

G N
U.T.M.

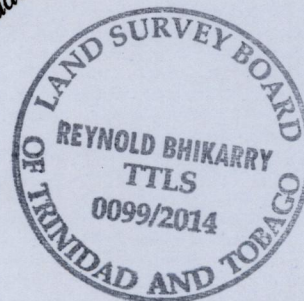

Vide Bk. 1197 fol. 141

Approved *[Signature]*
Director of Surveys 19/2/15

At station (D)
E: 668647 N: 1128490
Hand Held GPS.
Naparima Datum (+/-7m)
UTM Zone 20.

A - B 44° 55' 7.50
B - C 44° 55' 6.36

SCALE : 1:1000

o Denotes Iron put except stated otherwise.
Note: Bearings are U.T.M. grid based on solar observations Distances are in metres
PLAN of 3 Parcels of land coloured pink in the Ward of Naparima
Containing together five thousand one hundred and twenty two point eight square metres
Surveyed by me, with due authority, in January 2013
Certified correct in accordance with Regulation 25 (1) of the Land Surveyors' Regulations 1998.

Checked by *[Signature]*

Entered on Trinidad & Tobago Land Surveyor 20th October 2014

25

1656

THE LANDS AND MARINE RESOURCES ACT
1968 (No. 10)

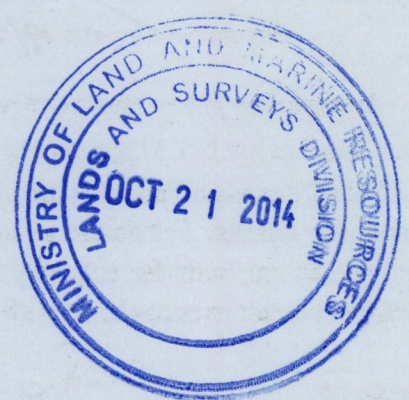

1656/26