

R.P.O Vol. 440 Fol. 377  
 C.T. Vol. 1040 Fol. 225

REMAINING PORTION

Ward of Siparia.  
 County of St. Patrick.  
 Cadastral Sheet G.14.E. 64D  
 1/c

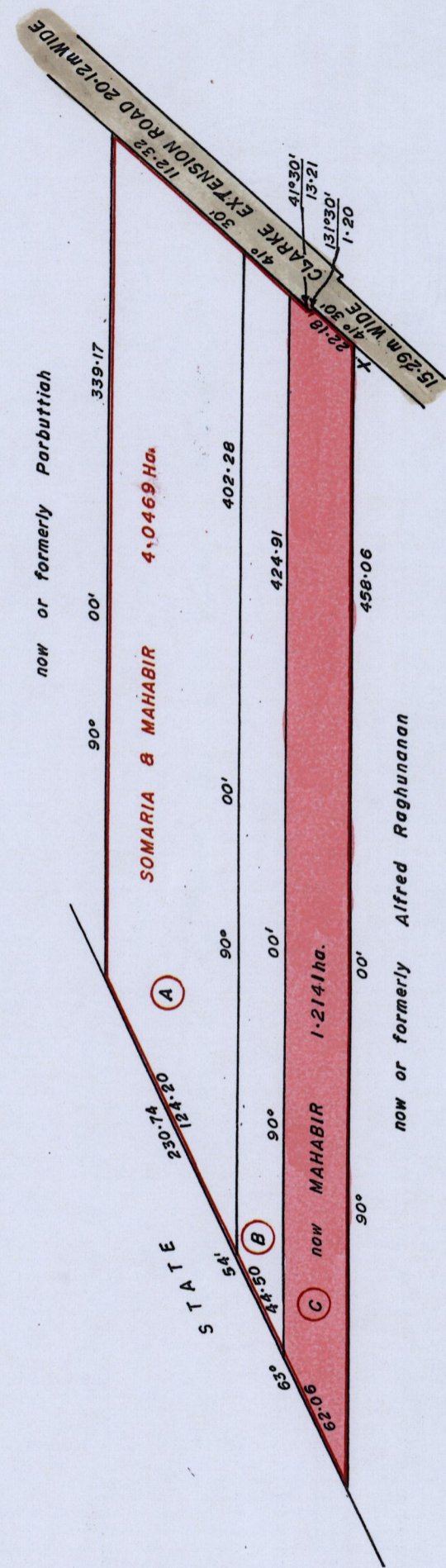

Lot#	NAME	AREA	C.T.Vol.	Fol.
A	Rampersad Maharaj	2-0234 ha.	1040	237
B	Etwaria, Ramsingh, & Lakhansingh	0-8094 ha.	1292	141

LEGEND

Approved: *[Signature]*  
 Director of Surveys. 22/1/14

This is a true copy of a diagram of four point zero four six nine hectares, Originally transferred to SOMARIA & MAHABIR showing a portion Coloured pink and containing one point two one four one hectares, being the remainder, after Two (2) previous transfers of another portion of the land. In accordance with Reg. 25(1) of the Land Surveyors' Regulations 1998, I certify that this plan represents the remaining portion.

Checked by N.W. 14.01.2017  
 Entered ..... 2014.

*[Signature]* Sugjaje Reemaul  
 Trinidad and Tobago Land Surveyor. 18<sup>th</sup> December 2014.

X  
 1124957 mN, 674774 mE  
 UTM 20, NAPI955(+/-5.0m)  
 GPS Handheld Direct Obs.

SCALE 1 : 2500.  
 Distances are in METRES

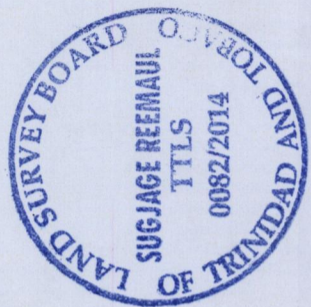

Bk. 431 : 334.  
 Bk. 843 : 137.  
 Bk. 915 : 61.

1656/15



*[Faint, illegible text]*

*[Faint, illegible text]*

*[Faint, illegible text]*

*[Faint, illegible text]*

*[Faint, illegible text]*