

1656

141

R.P.O. Vol. 241 Fol. 381
C.T. Vol. 1734 Fol. 359

Cadastral Sheet G.13.A. $\frac{63E}{2/b}$

Ward of Siparia

County of St. Patrick

Plot 20,

Haarbajan Hill Trace.

Ref. : P.F. 9

Ref. : C.F. 52

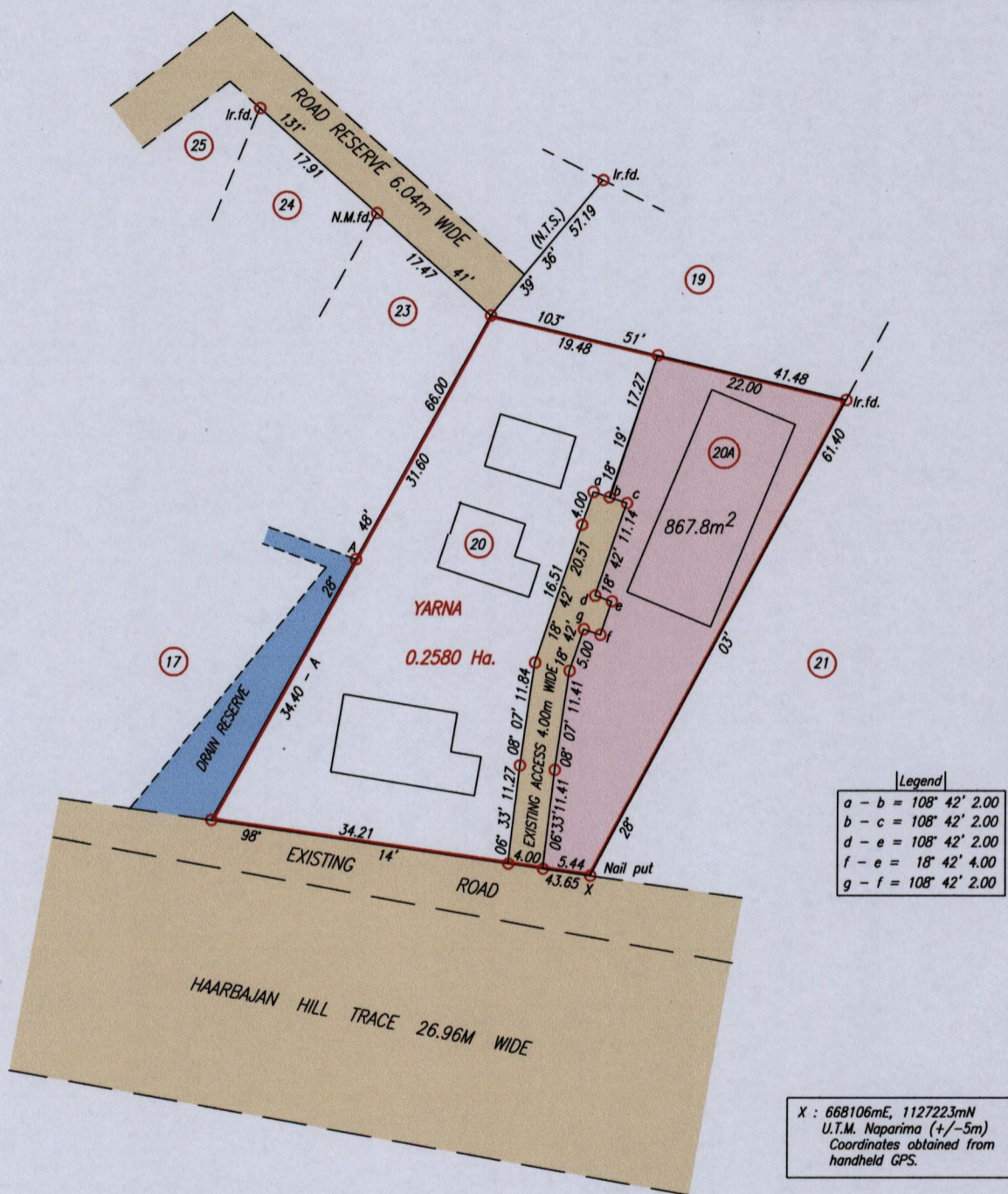

X : 668106mE, 1127223mN
 U.T.M. Naparima (+/-5m)
 Coordinates obtained from handheld GPS.

Approved

Jamal Sookoor
 Director of Surveys 15/16/15

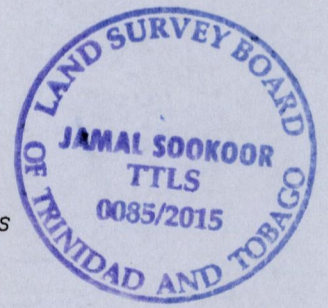

SCALE 1:750

Distances are in Metres

○ Denotes Iron put except otherwise stated.

Bearings are U.T.M. Grid based on Solar Observations.

PLAN of a Parcel of land coloured pink in the Ward of Siparia
 Containing eight hundred and sixty seven point eight square metres.

Surveyed by me, with due authority, in May, 2002

Certified Correct in accordance with Regulation 25(1) of the Land Surveyors' Regulations 1998

Checked by *HR-02/06/15* .. *Jamal Sookoor* ..

Entered on. Trinidad & Tobago Land Surveyor *21st May* 2015

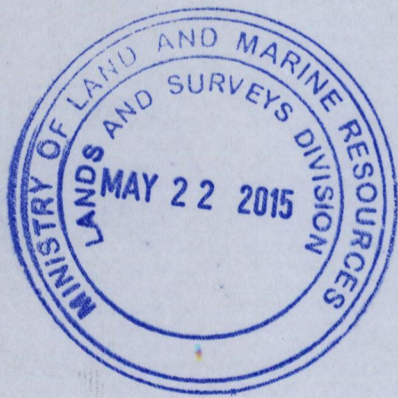

1056/41