

1056

140

REMAINING PORTION PLAN

R.P.O. Vol. 110 Fol. 479
C.T. Vol. 2622 Fol. 173

Ward of Siparia
County of St. Patrick
Cadastral Sheet G.13.J 63F
3/c

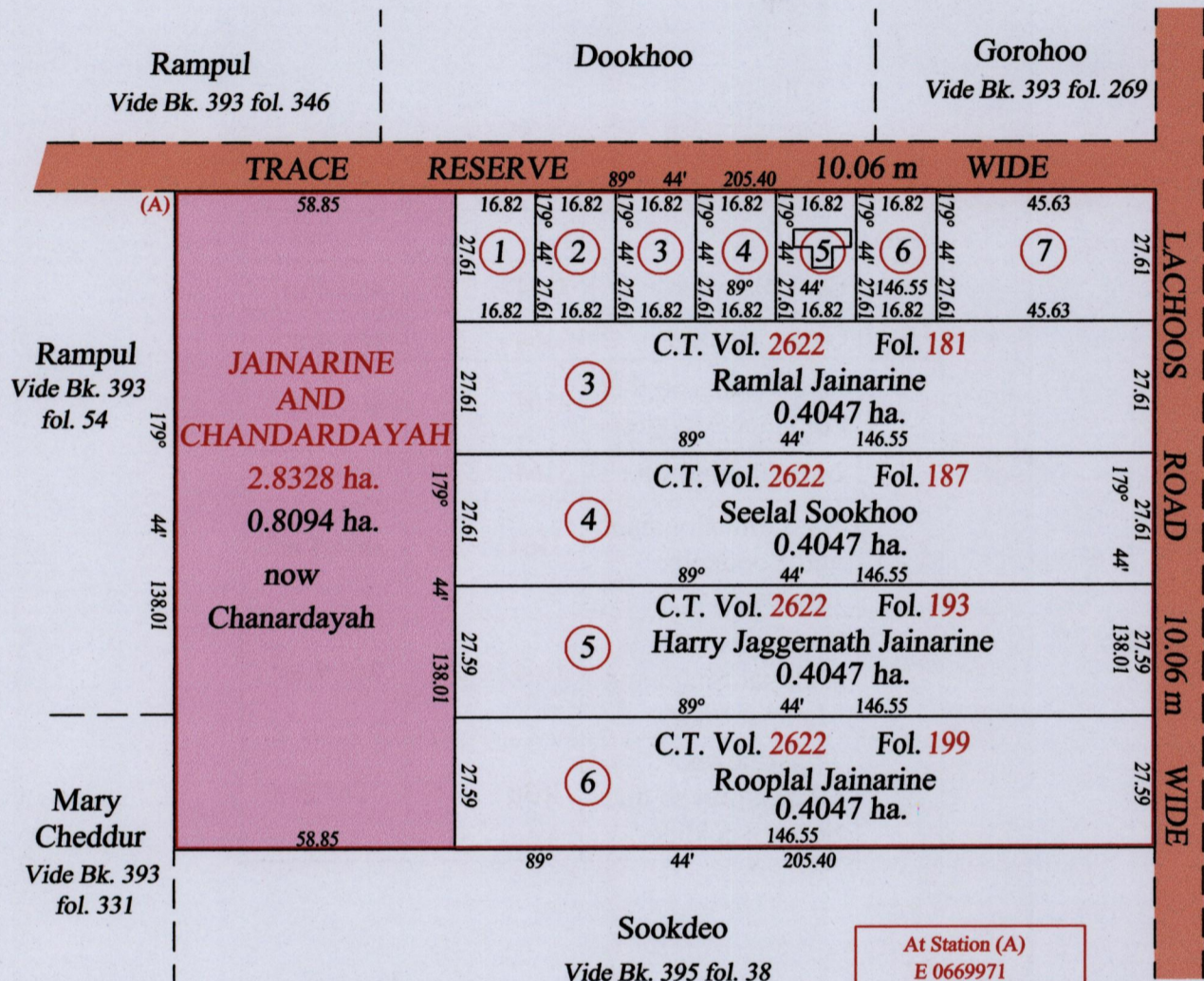

At Station (A)
E 0669971
N 1123342
Reading taken with
Handheld G.P.S.
U.T.M. Zone 20
Naparima
± 5 m.

TURN TO BACK OF PLAN

Approved *[Signature]*
Director of Surveys 15/6/15

SCALE : 1:1500

Note: Bearings are cassini grid based on solar observations Distances are in metres
Plan of two point eight three two eight hectares
originally transferred to Jainarine and Chandardayah, showing a portion
coloured pink and containing zero point eight zero nine four hectares
being the remainder after eleven (11) previous transfer of another portion of the land
In accordance with Regulation 25(1) of the Land Surveyors Regulations 1998
I certify that this plan represents the remaining portion



Checked by *[Signature]* HR-11/06/15

Entered on Trinidad & Tobago Land Surveyor 1-06 2015

Lots	Names	CT.	Vol.	Areas
①	Baby Boodram	3164	213	464.4 m ²
②	Gaura Tacouri	3164	221	464.4 m ²
③	Jasso Mungroo then Pulmatee Mungroo	3164	229	464.4 m ²
④	Mala Praimroop	3164	237	464.4 m ²
⑤	Rookmin Boodnath and Boodnath Ramharrack	3164	245	464.4 m ²
⑥	Soondarbassie Mahipat Singh and Mahipat Singh	3164	253	464.4 m ²
⑦	Jainarine and Chandardayah then Seelal Sookhoo	3636	337	1259.8 m ²

1656/140