

64A
4/c

Cadastral Sheet G.9.0
Ward of Savana Grande
County of Victoria

R.P.O. Vol. 38 fol. 139
C.T. Vol. 4729 fol. 495

Remaining Portion Plan

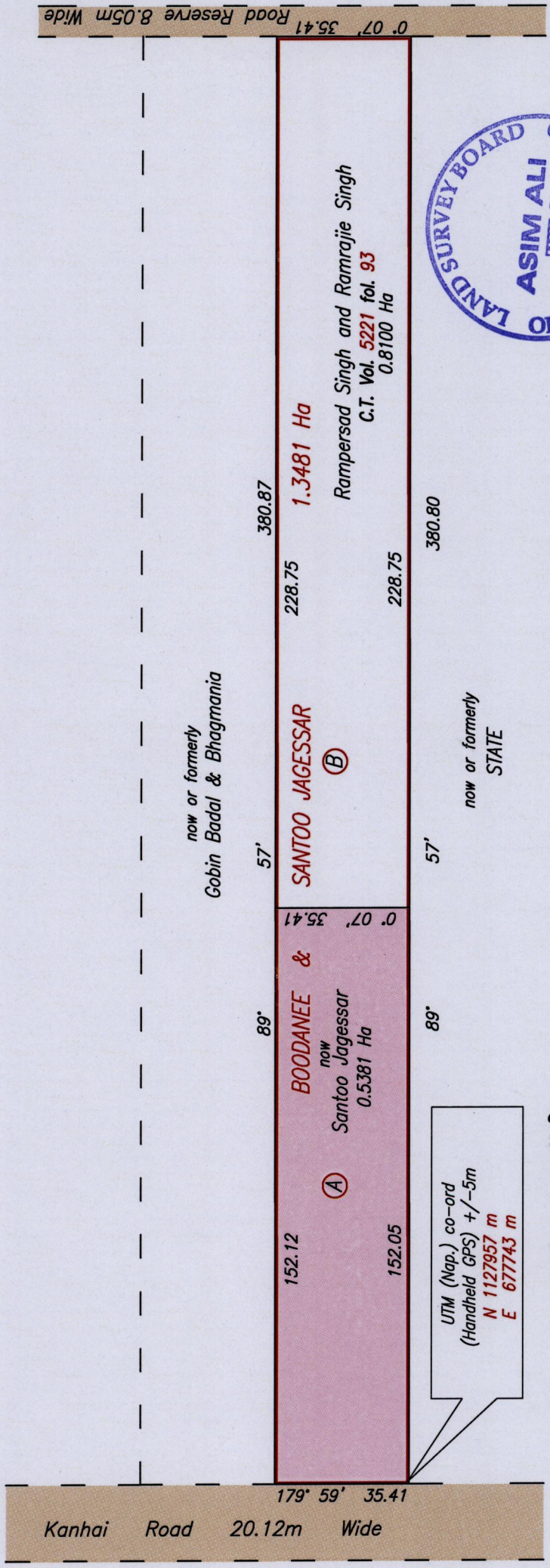
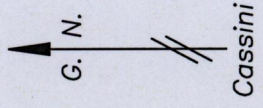

1656

137

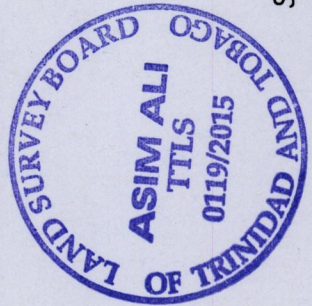

Vide Bk. 1439 fol. 14

SCALE 1:1500
Distances are in metres

PLAN of one point three four eight one hectares originally transferred to BOODANEE and SANTOO JAGESSAR showing a portion coloured pink and containing zero point five three eight one hectares being the remainder after one previous transfer of another portion of the land.

Prepared by me, with due authority, in December 2014.
Certified correct, in accordance with Regulation 25 (1) of The Land Surveyors' Regulations 1998.

Checked By: R. 28/05/15
Entered On

Trinidad & Tobago Land Surveyor. 25 May 2015



1955/137