

R.P.O Vol. 200 Fol. 265
 C.T. Vol. 5170 Fol. 391

Ward of Moruga
 County of Victoria
 Cadastral Sheet G.20.G&H., 74C
 1/c

Coordinates
 Ir.pt. F : N 1120300
 E 686818
 Error Statement : ±4m
 Datum Definition : U.T.M. Zone 20 Naparima
 Source : Magellan Hand Held GPS

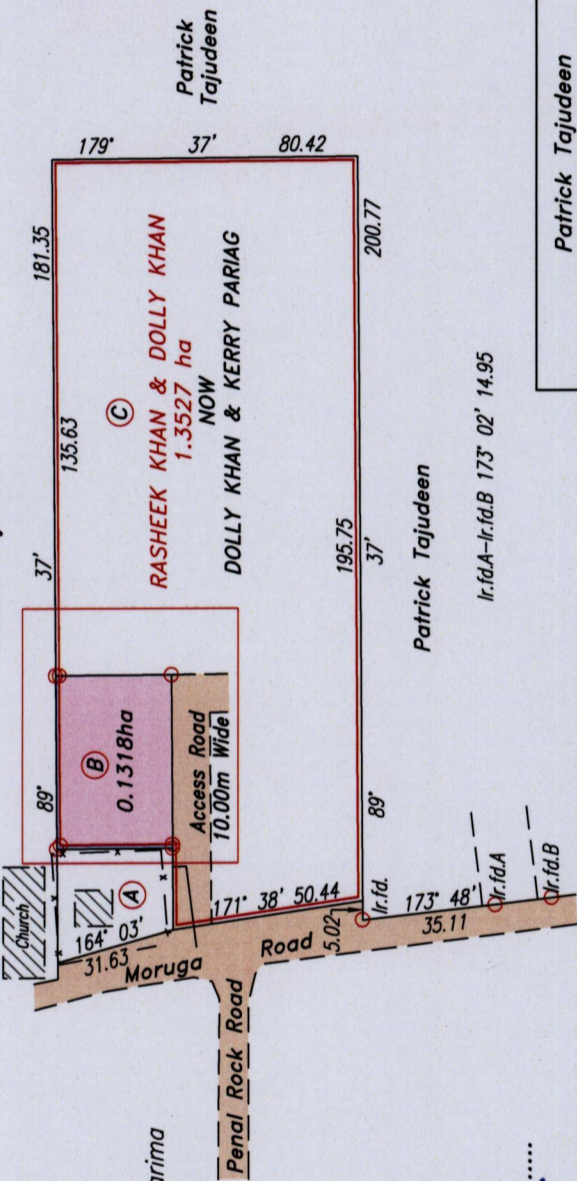

LEGEND	
- x -	Chain Link Wire Fence
▨	Building

Approved.....
 Director of Surveys *CK/15*

Ref.: Plan DA 37
 SCALE 1:2000
 Distances are in metres.

○ Denotes Iron put except otherwise stated.
 Note: Bearings are UTM Grid based on solar observations.
 Plan of a Parcel of land coloured pink in the Ward of Moruga
 Containing zero point one three one eight hectare
 Surveyed by me, with due authority, in January 2013.
 Certified correct in accordance with Regulation 25 (1) of the Land Surveyors
 Regulations 1998.

Checked
 Entered
 Trinidad & Tobago Land Surveyor2015

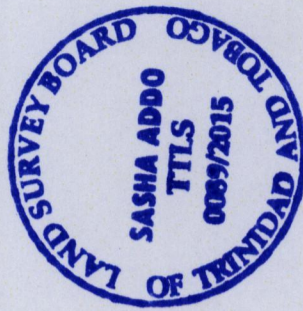
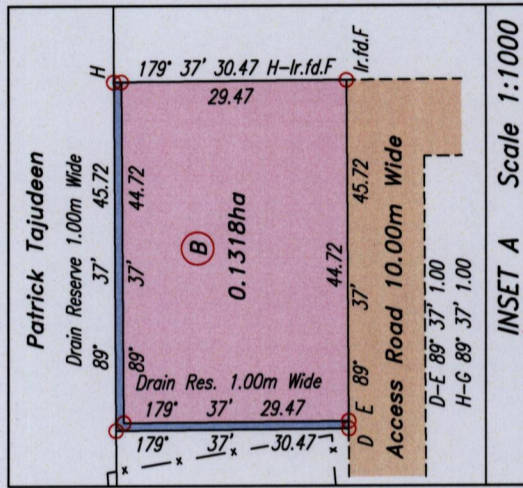

1656

102

Parcel Address: Basse Terre,
 Morgua.

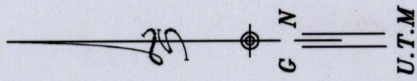

1656/102

