

RPO . Vol 427 Fol. 353
 CT. Vol. 5291 Fol. 397

Remaining Portion Plan Bk. 1005 Fol. 79
 Orig. Bk. 384 Fol. 25

Ward of Savana Grande
 County of Victoria
 Cadastral Sheet G 14 D 64E
 1/a

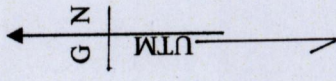

1655

333

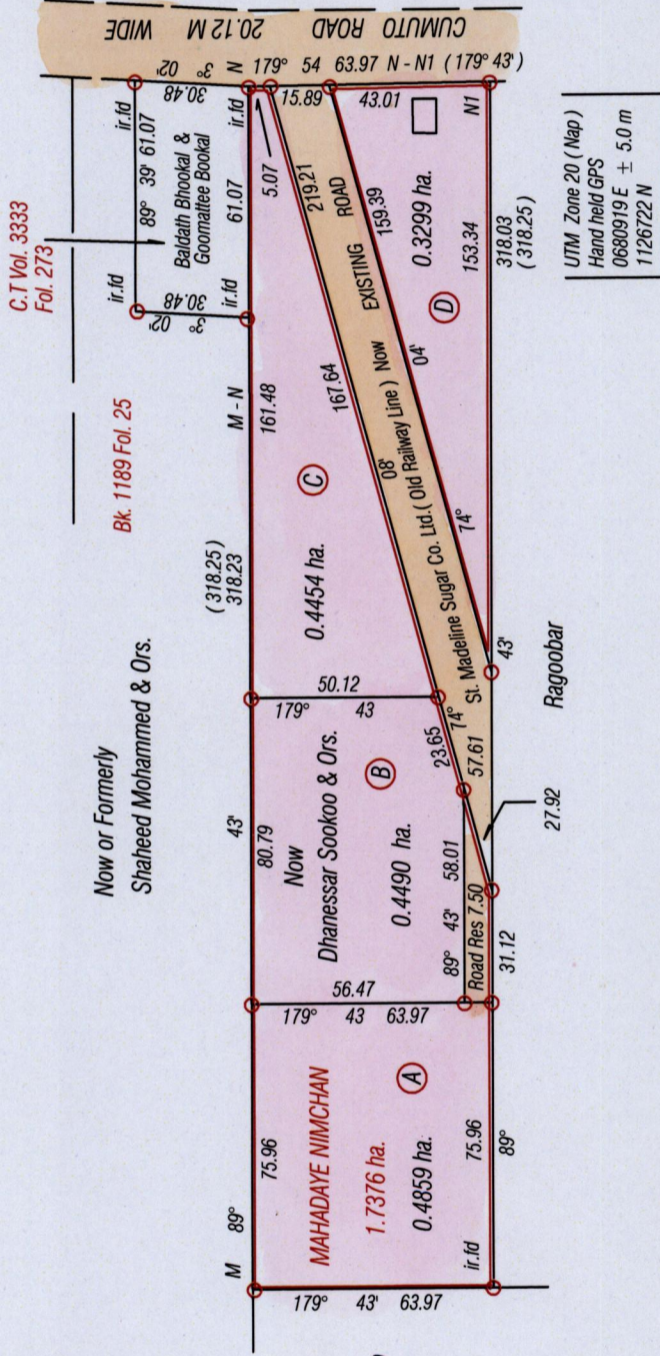

Approved.....
Samuel
 Director of Surveys 22/9/14

Bearings are UTM Grid based on Solar Obs.
 ○ Denotes iron put except otherwise stated

SCALE 1: 2000
 Distances are in metres

PLAN of 4 Parcels of land coloured Pink in the Ward of Savana Grande
 Containing one point seven one zero six hectares
 Surveyed by me, with due authority, in September 2013
 Certified Correct in accordance with Regulation 25 (1) of the Land Surveyors' Regulations 1998.

Checked by.....
 Entered.....
Winston Ramcharan
 Trinidad and Tobago Land Surveyor 09th September 2014