

R.P.O. Vol. 296 Fol. 605
C.T. Vol. 2957 Fol. 395

Ward of Naparima
County of Victoria
Cadastral Sheet G 13 C, 63 F
Transphar Village, Debe. 2/c

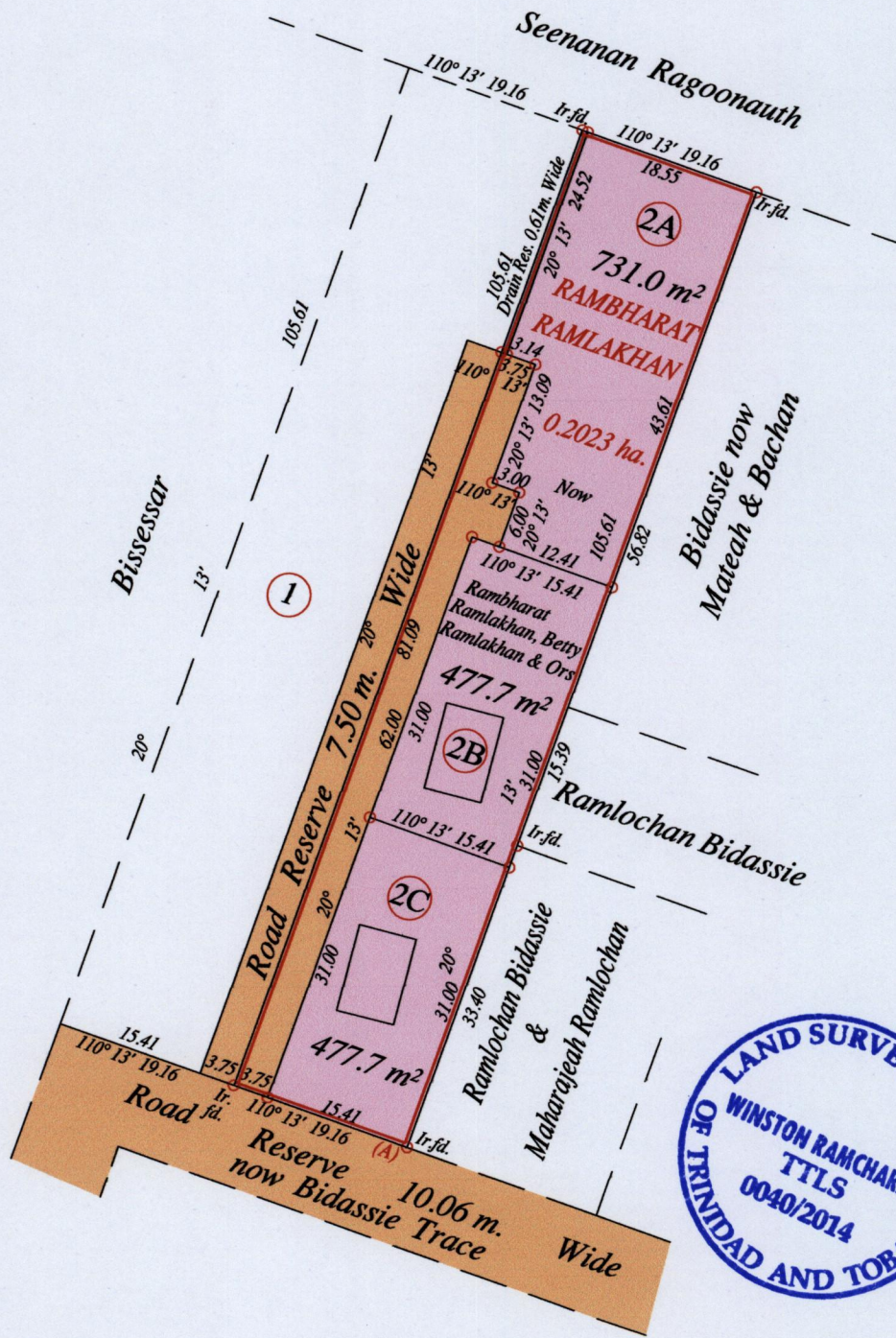

G N
U.T.M.

Vide Bk. 1157 fol. 6

Approved *[Signature]*
Director of Surveys 9/9/14

At station (A)
E: 671867 N: 1126367
Hand Held GPS.
Naparima Datum (+/-5m)
UTM Zone 20.

SCALE : 1:750

o Denotes Iron put except stated otherwise.
Note: Bearings are U.T.M. grid based on solar observations Distances are in metres
PLAN of 3 Parcels of land coloured pink in the Ward of Naparima
Containing together one thousand six hundred and eighty six point four square metres
Surveyed by me, with due authority, in November 2014
Certified correct in accordance with Regulation 25 (1) of the Land Surveyors' Regulations 1998.

Checked by *[Signature]*

Entered on Trinidad & Tobago Land Surveyor 30th July 2014