

1655

60

R.P.O. Vol. 82 fol. 535
C.T. Vol. 1820 fol. 319

Ward of Siparia
County of St. Patrick
Cadastral Sheet G. 12. L. 63 F. 3/b

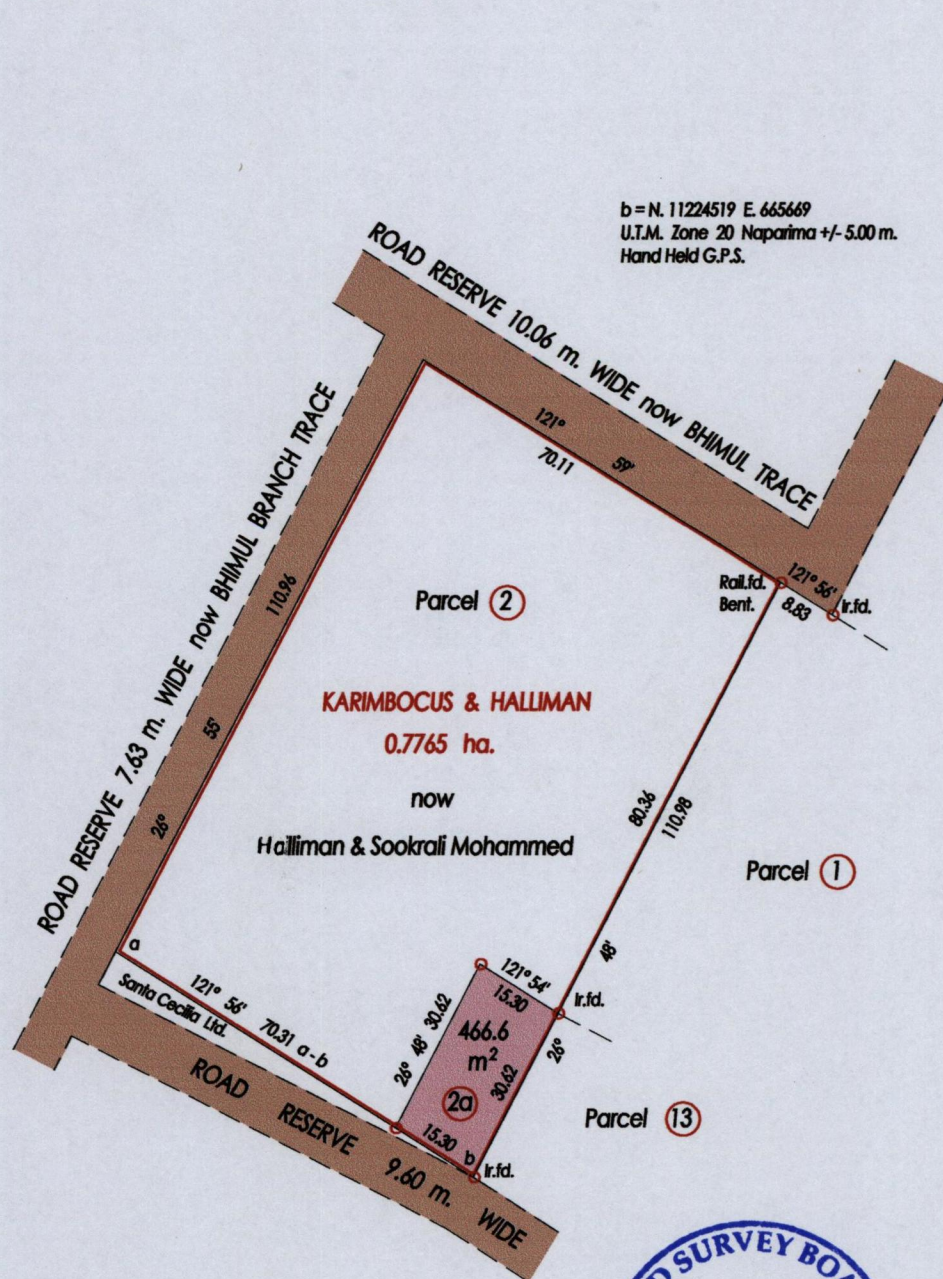

b=N. 11224519 E. 665669
U.T.M. Zone 20 Naparima +/- 5.00 m.
Hand Held G.P.S.



Vide Plan C. K. 43

○ Denotes Iron Put Except Stated Otherwise

SCALE 1 : 1250

Approved.....
Director of Surveys 4/9/14

Bearings are U.T.M. Grid based on Solar Observations Distances are in Metres
PLAN of a Parcel of land coloured pink in the Ward of Siparia
Containing four hundred and sixty six point six square metres
Surveyed by me, with due authority in, March 2014

Certified Correct in accordance with Regulation 25 (1) of the Land Surveyors Regulation 1998.

Checked by 29/8/2014..... Shervon Phriday.....

Entered on..... Trinidad & Tobago Land Surveyor . 02nd June... 2014