

R.P.O. Vol 53
C.T. Vol. 1724

Fol. 263
Fol. 61

Ward of Naparima
County of Victoria
Cadastral Sheet G.13.B., 63F
1/a

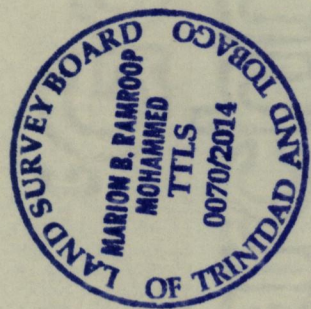
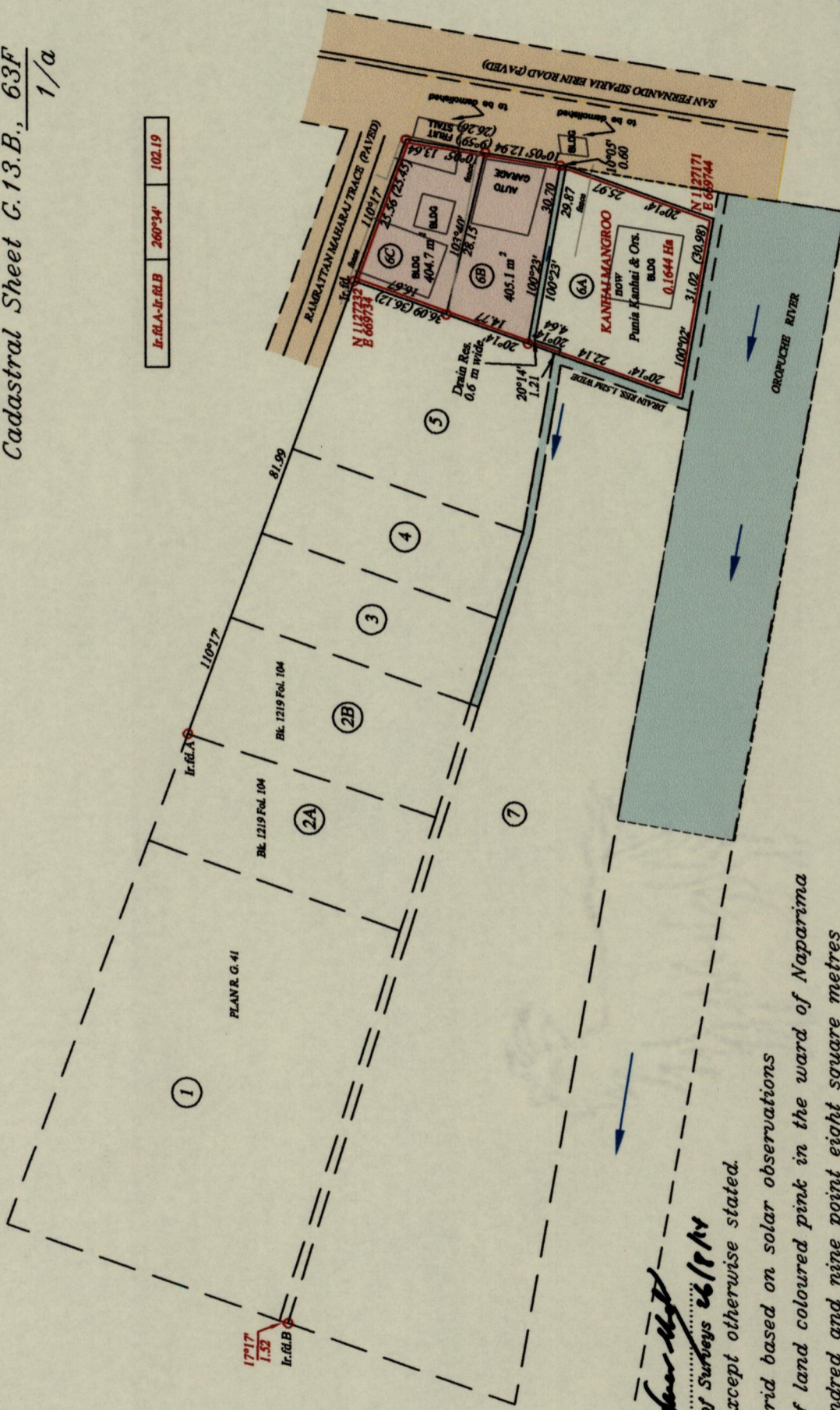

SEE BL. 1249 Fol. 70
SEE BL. 1219 Fol. 104
SEE PLAN R. G. 41

COORDINATES:
UTM ZONE 20 NAPARIMA DATUM
USING GARMIN HANDHELD GPS ± 10m

Approved.....
 Director of Surveys 26/11/14
 ○ Denotes Iron put except otherwise stated.
 Bearings are UTM grid based on solar observations
 Plan of 2 parcels of land coloured pink in the ward of Naparima
 Containing eight hundred and nine point eight square metres
 Surveyed by me, with due authority in November 2012
 Certified Correct in accordance with Regulation 25 (1)
 of the Land Surveyors' Regulations 1998.

Scale 1 : 1000
Distances are in metres

Checked by.....
 Entered.....
 Marion B. Mohammed
 Trinidad and Tobago Land Surveyor, 26/08/2014

1655

55