

RPO Vol. 136 Fol. 323
CT. Vol. 3109 Fol. 253

Ward of Siparia
County of St. Patrick
Cadastral Sheet G.13.N. 63F & 73C
3/c 1/a

Coordinates

Ir.pt. A : N 1121957
E 670074

Error Statement : ±4m

Datum Definition : U.T.M. Zone 20 Naparima

Source : Magellan Hand Held GPS

Parcel Address: Between #Lp74 & 103/7
Daybadial Trace, Off Penal Rock Road, Penal.

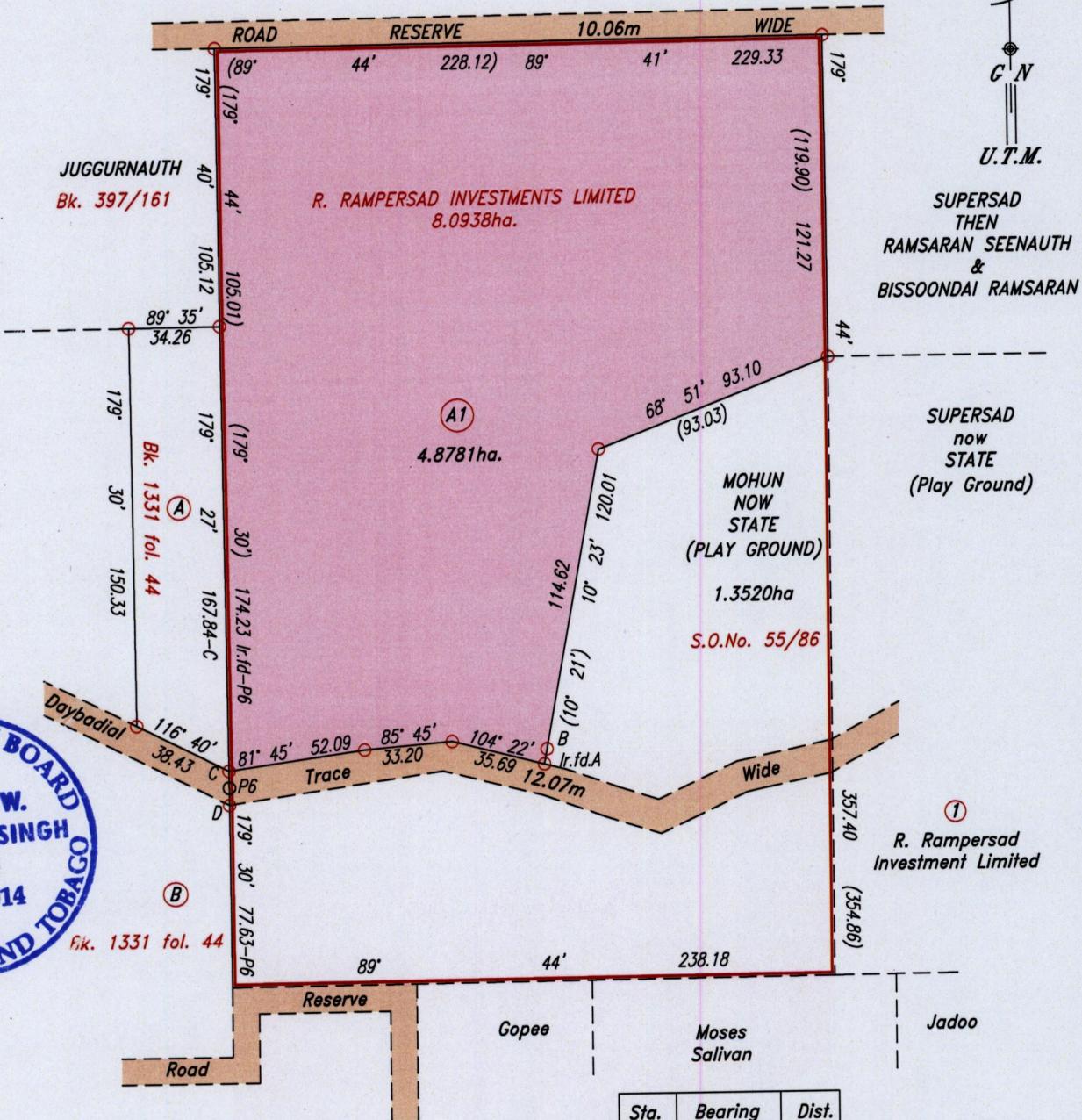

| Sta. | Bearing | Dist. |
|------|----------|-------|
| A-B | 10° 23' | 5.39 |
| C-D | 179° 30' | 12.78 |

Approved.....
Director of Surveys 13/8/14

Reference
Bk. 397 Fol. 166
SCALE 1:2500

○ Denotes Iron found except otherwise stated.

Note: Bearings are U.T.M. grid based on solar observations. Distances are in metres.

Plan of a Parcel of land coloured pink in the Ward of Siparia

Containing four point eight seven eight one hectares

Surveyed by me, with due authority, in September 2011

Certified correct in accordance with Regulation 25 (1) of the Land Surveyors Regulations 1998.

Checked by: MM 12/8/2014

Entered

Trinidad & Tobago Land Surveyor 2014