

1655

40

REMAINING PORTION

R.P.O. Vol. 19 Fol. 105

C.T. Vol. 1358 Fol. 463

Ward of Siparia

County of St. Patrick

Cadastral Sheet G 12 B. 63 D  
2/a

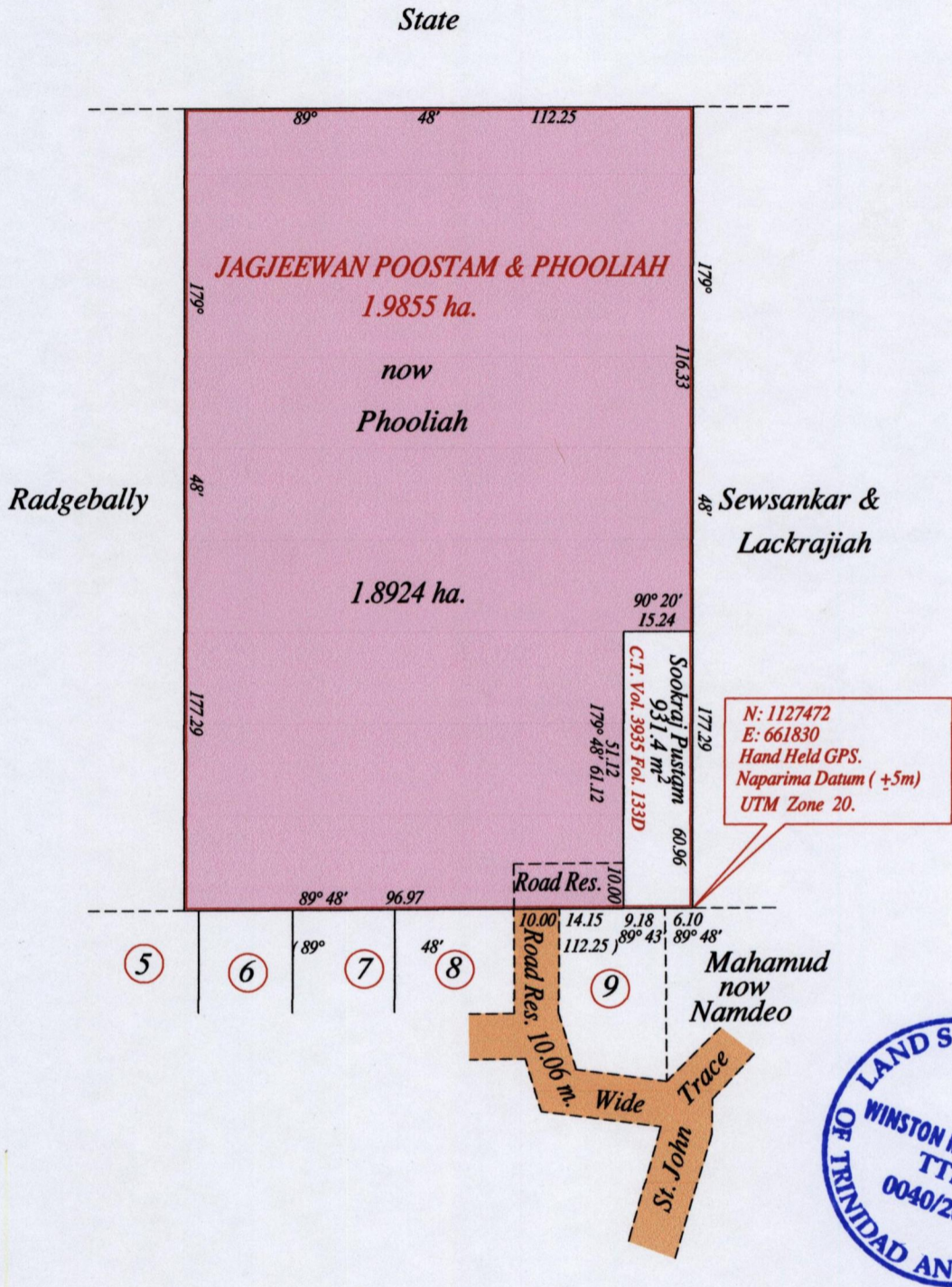

N: 1127472  
 E: 661830  
 Hand Held GPS.  
 Naparima Datum (+5m)  
 UTM Zone 20.



Vide Plan R H 68  
Vide Bk. 1247 fol. 57

Approved *[Signature]*  
 Director of Surveys *13/12/14*

SCALE : 1:1500

Note: Bearings are U.T.M. grid based on solar observations Distances are in metres  
 Plan of one point nine eight five five hectares, originally transferred to Jagjeewan Poostam & Phooliah, shewing a portion coloured pink and containing one point eight nine two four hectares being the remainder after one (1) previous transfer of another portion of the land.  
 In accordance with Regulation 25 (1) of the Land Surveyors Regulations 1998, I certify that this plan represents the remaining portion.

Checked by *10/17/2014 Winston Ramcharan*

Entered on ..... Trinidad & Tobago Land Surveyor *[Signature]* ..... 2014