

R.P.O. Vol. 62 fol. 209
C.T. Vol. 5109 fol. 505
C.T. Vol. 5109 fol. 497

Ward of Tamana
County of St. Andrews
Cadastral Sheet E 6 N $\frac{35 E}{3/b}$

Vide Bk. 7 fol. 205
Vide Bk. 709 fol. 32
Vide Bk. 913 fol. 70
Vide Plan K H 19
Vide Plan K H 20

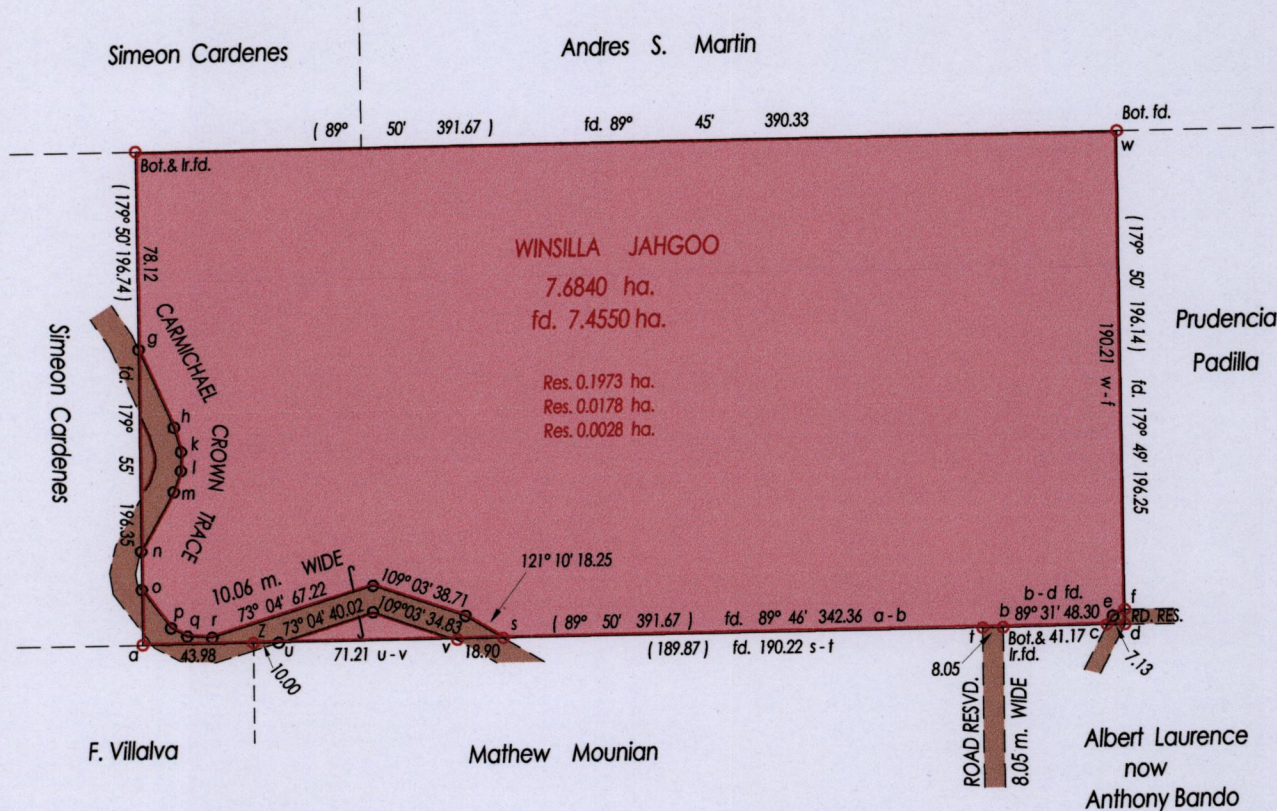
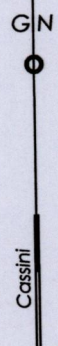

Sta.	Bearings	Dist
c-e	34° 34'	4.19
e-f	62° 11'	5.34
f-d	179° 49'	6.04

Sta.	Bearings	Dist
g-h	156° 20'	34.21
h-k	164° 43'	10.03
k-l	181° 12'	7.66
l-m	199° 13'	8.78
m-n	209° 34'	26.81
n-o	179° 55'	15.22
o-p	143° 38'	19.13
p-q	118° 25'	7.30
q-r	93° 23'	9.90

Z = N. 1158479 E. 698526
U.T.M. Zone 20 Naparima +/- 5.00 m.
Hand Held G.P.S.

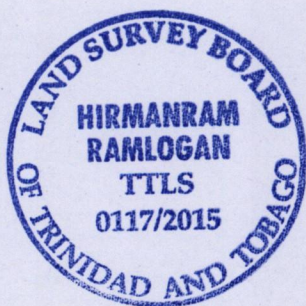

o Denotes Iron Found Except Stated Otherwise

SCALE 1 : 3000

Approved
Director of Surveys *12/1/15*

Bearings are Cassini Grid based on Solar Observations Distances are in Metres
PLAN of a parcel of land coloured pink in the Ward of Tamana
Containing seven point four five five zero hectares
Surveyed by me, with due authority, in Dec. 2014
Certified Correct in accordance with Regulation 25 (1) of the Land Surveyors
Regulation 1998.

Checked by..... *Hirmanram Ramlogan*.....

Entered on..... Trinidad & Tobago Land Surveyor *12th January, 2015*