

R.P.O. Vol. Fol.
C.T. Vol. 4808 Fol. 399

Cadastral Sheet A.20.B. 13D
Ward of St. Ann's 2/d
County of St. George

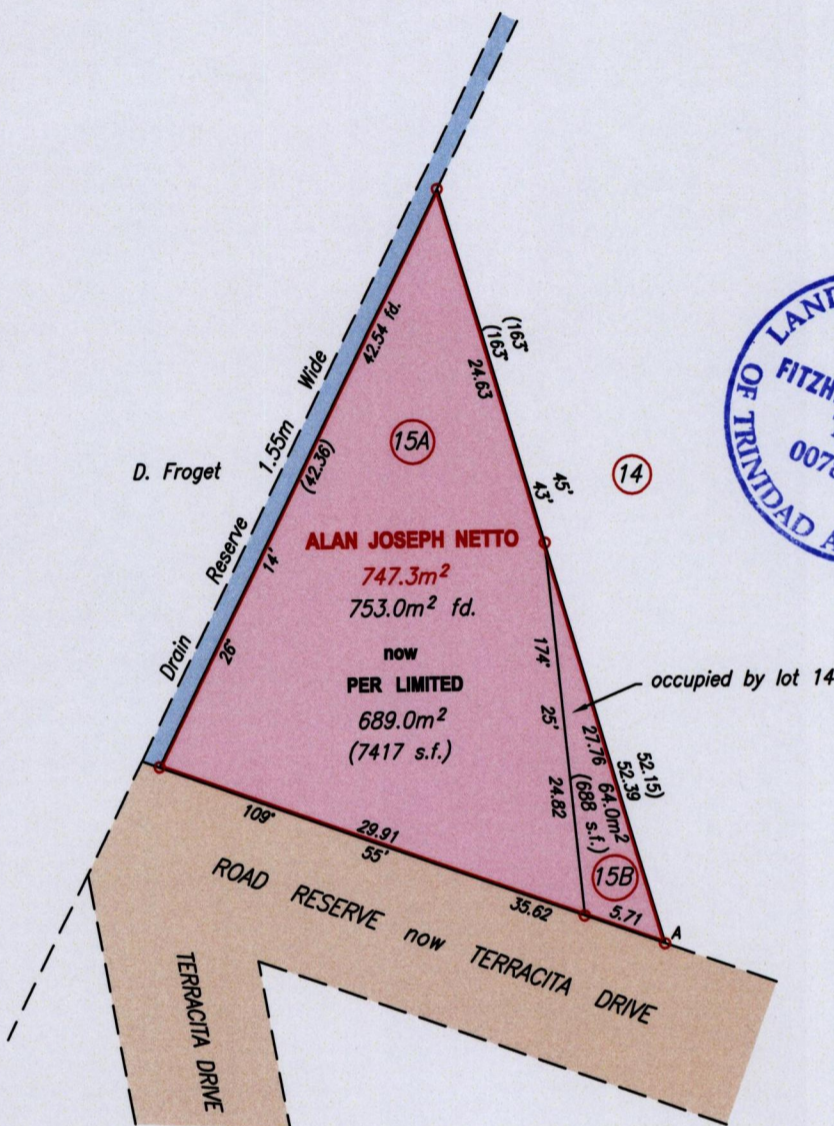
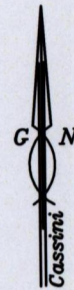

(15B) To be amalgamated with (14)

See Plan F.I.53

A Ir.put N 1181650 Hand Held GPS +/- 5m
E 662771 UTM proj. WGS84 Zone 20

Approved

Director of Surveys 10/12/14

SCALE 1/500
Distances are in metres

- Denotes Iron put unless otherwise stated
- Bearings are Cassini Grid based on Solar Observations
- PLAN of 2 Parcels of land coloured pink in the Ward of St. Ann's
- Containing together seven hundred and fifty three point zero square metres
- Surveyed by me with due authority in March 2014
- Certified Correct in accordance with Regulation 25 (1) of the Land Surveyors Regulations 1998,

Checked by.....

Entered on.....

Trinidad & Tobago Land Surveyor 14 Oct 2014