

R.P.O. Vol. 111 Fol. 117

C.T. Vol. 2351 Fol. 561

Ward of Siparia
County of St. Patrick
Cadastral Sheet (G 12 H & L) 63 E
3/b

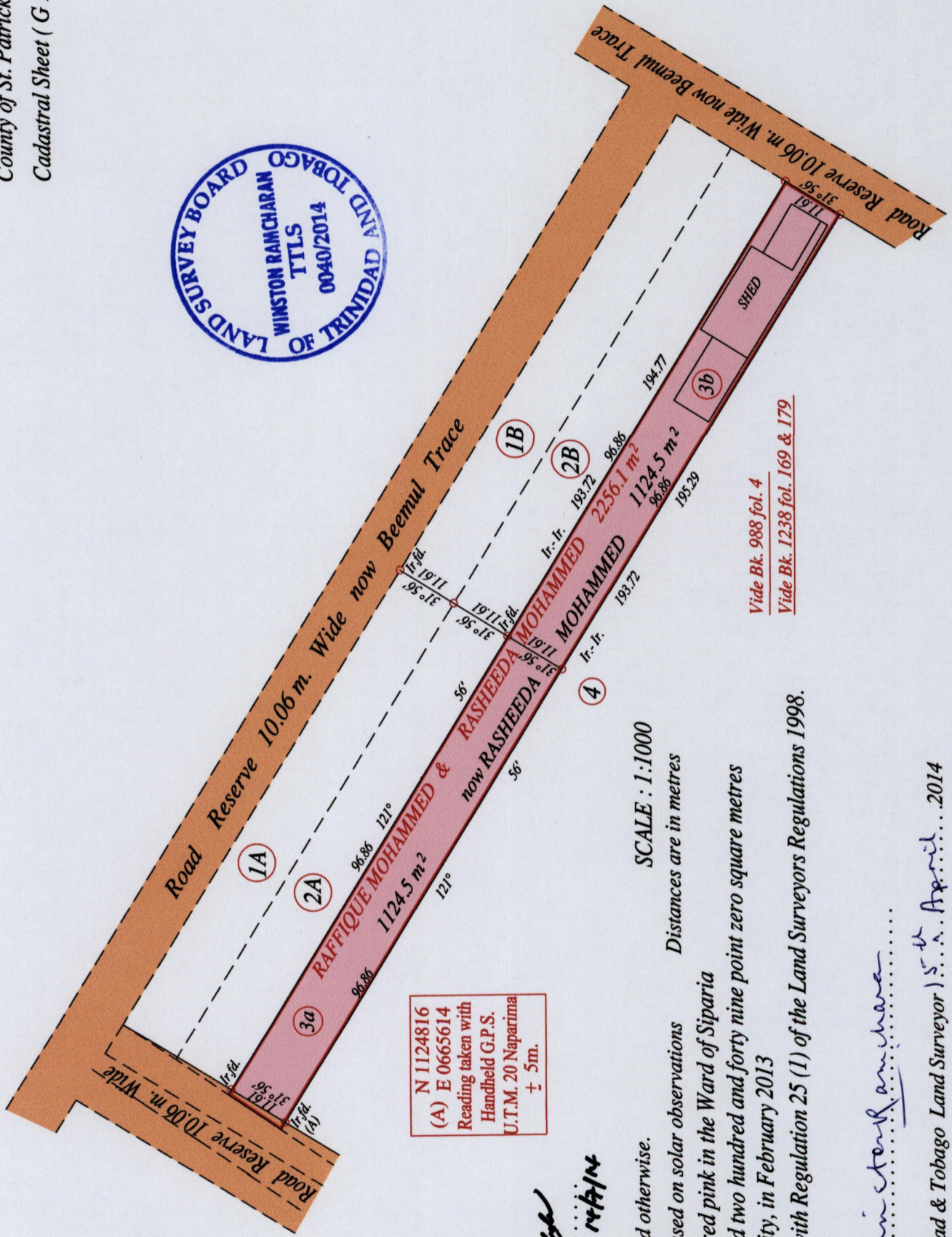

N 1124816
(A) E 0665614
Reading taken with
Handheld G.P.S.
U.T.M. 20 Naparima
± 5m.

Approved
Director of Surveys

o Denotes Iron put except stated otherwise.

Note: Bearings are U.T.M. grid based on solar observations

Distances are in metres

PLAN of 2 Parcels of land coloured pink in the Ward of Siparia

Containing together two thousand two hundred and forty nine point zero square metres

Surveyed by me, with due authority, in February 2013

Certified correct in accordance with Regulation 25 (1) of the Land Surveyors Regulations 1998.

Checked by
Winston Ramcharan

Entered on
Trinidad & Tobago Land Surveyor 15th April 2014

SCALE : 1:1000

Vide Bk. 988 fol. 4
Vide Bk. 1238 fol. 169 & 179

1655

21