

R.P.O Vol. 145 Fol. 327
C.T Vol. 3844 Fol. 167

Ward of Siparia
County of St. Patrick
Cadastral Sheet G.18.H. $\frac{73C}{2/d}$

Penal

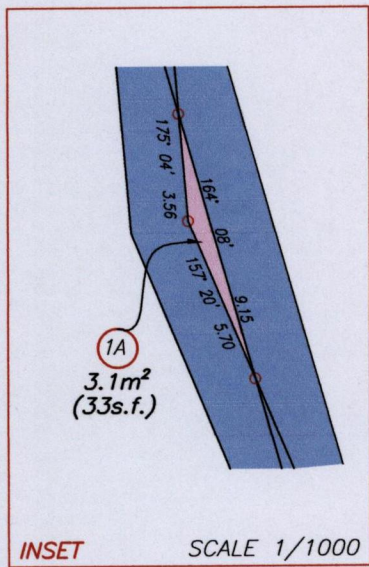
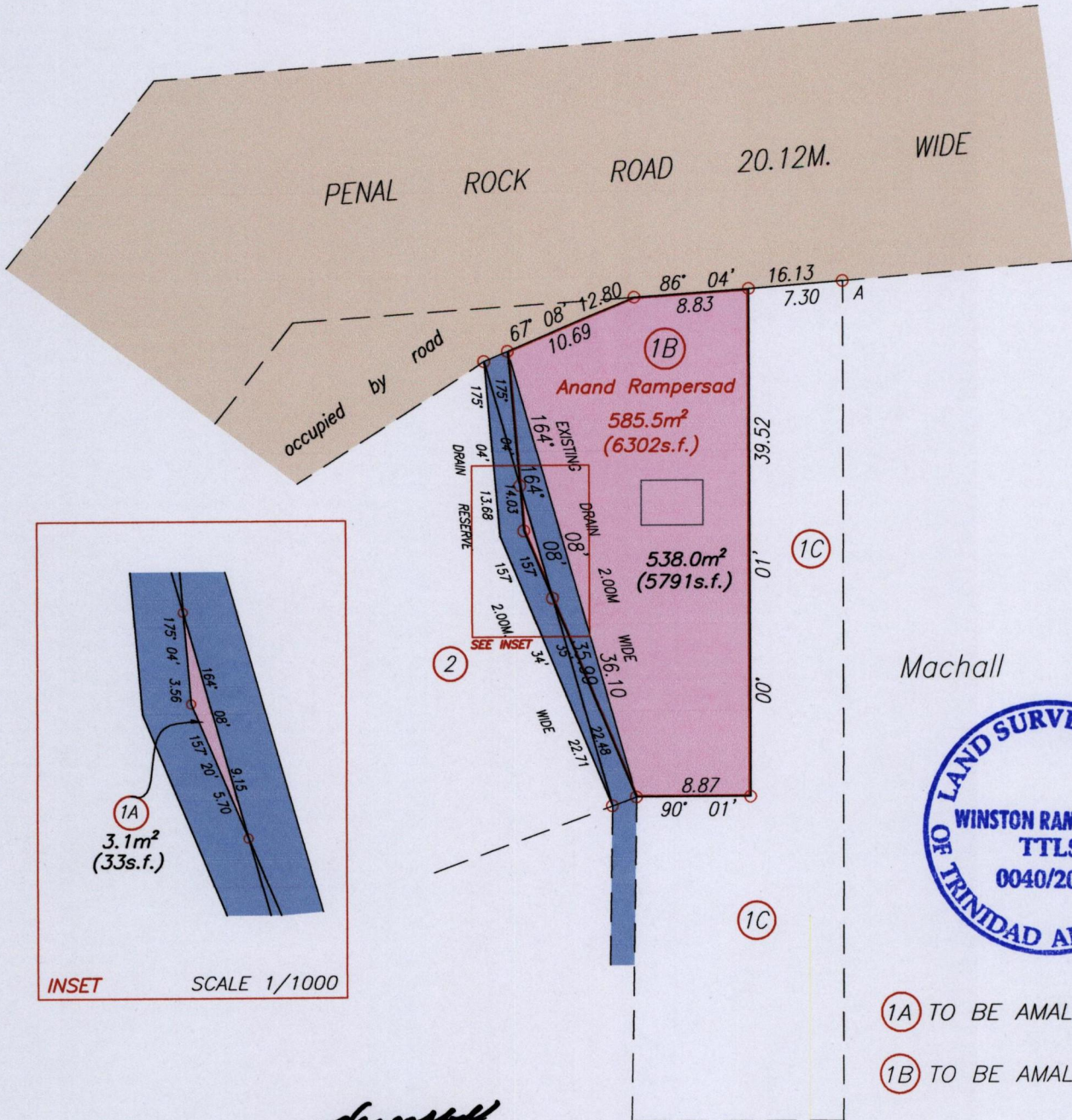

①A TO BE AMALGAMATED TO ②
①B TO BE AMALGAMATED TO ①C

Approved *[Signature]*
Director of Surveys 15/12/14

Bk 1233 : 44

A Iron Put N. 1120560 Hand Held GPS
E. 0737440 WGS84 Zone20

SCALE 1/500
Distances are in metres

○ Denotes Iron Put unless otherwise stated
Bearings are base on solar observation

PLAN of 2 Parcels of land, coloured pink in the Ward of Siparia
Containing five four one point one square metres
Surveyed by me, with due authority, in August 2007

In accordance with Regulation 25 (1) of the Land Surveyors' Regulations 1998,
Certified Correct In accordance with Regulation 25 (1) of the Land Surveyors' Regulations 1998,

Checked by.....

[Signature]

Entered On.....

Trinidad & Tobago Land Surveyor *[Signature]* 11th December 2014