

R.P.O. Vol. 13 Fol. 445  
 C.T. Vol. 2490 Fol. 457

Ward of Naparima  
 County of Victoria  
 Cadastral Sheet G 8 N, 63 C  
 3/d

No. 23C Lalbeharry Trace Extension 1  
 Debe

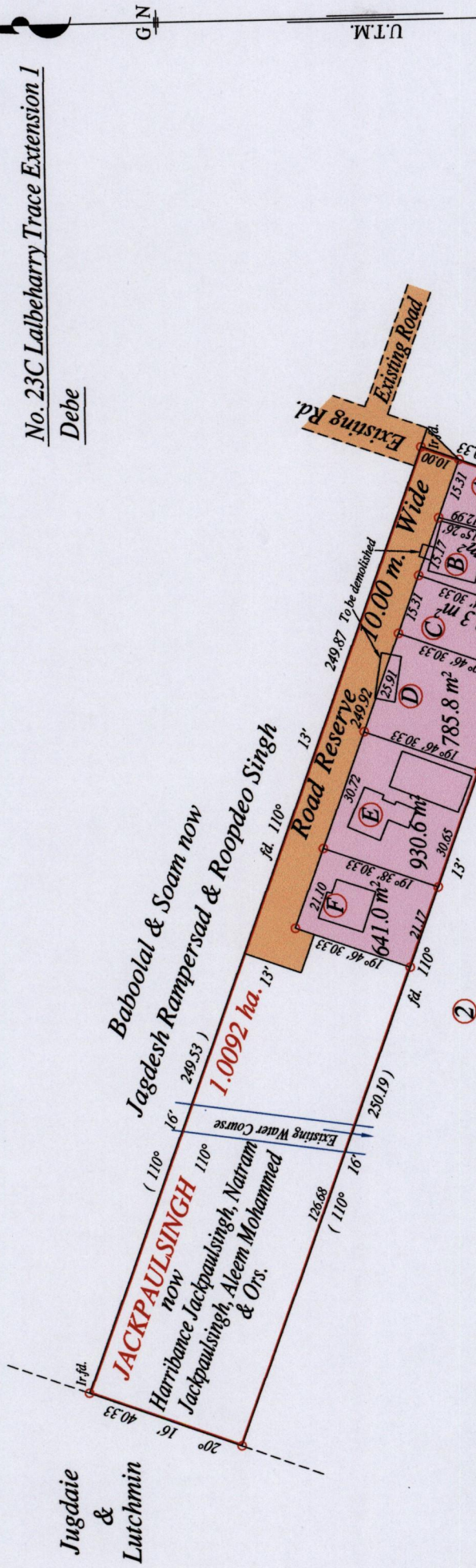

Vide Bk. 1110 fol. 49  
 Vide Bk. 1238 fol. 100

SCALE : 1:1500

o Denotes Iron put except stated otherwise.  
 Note: Bearings are U.T.M. grid based on solar observations Distances are in metres  
 PLAN of 6 Parcels of land coloured pink in the Ward of Naparima  
 Containing together three thousand seven hundred and forty five point two square metres  
 Surveyed by me, with due authority, in July 2013  
 Certified correct in accordance with Regulation 25 (1) of the Land Surveyors Regulations 1998.

Approved by *[Signature]*  
 Director of Surveys 15/7/14

Checked by *[Signature]*  
 Entered on *[Signature]* Trinidad & Tobago Land Surveyor 29<sup>th</sup> April 2014



E 0670419  
 N 1127804  
 Handheld G.P.S.  
 U.T.M. Naparima  
 ZONE 20  
 ± 5m.

1655

20