

R.P.O. Vol. 24 fol. 395
C.T. Vol. 2461 fol. 283
Bk. 723 fol. 12

Ward of Naparima
County of Victoria
Cadastral Sheet G. 8. N. 63 C
3/c

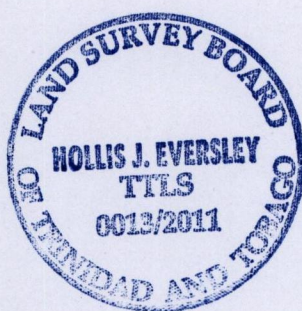
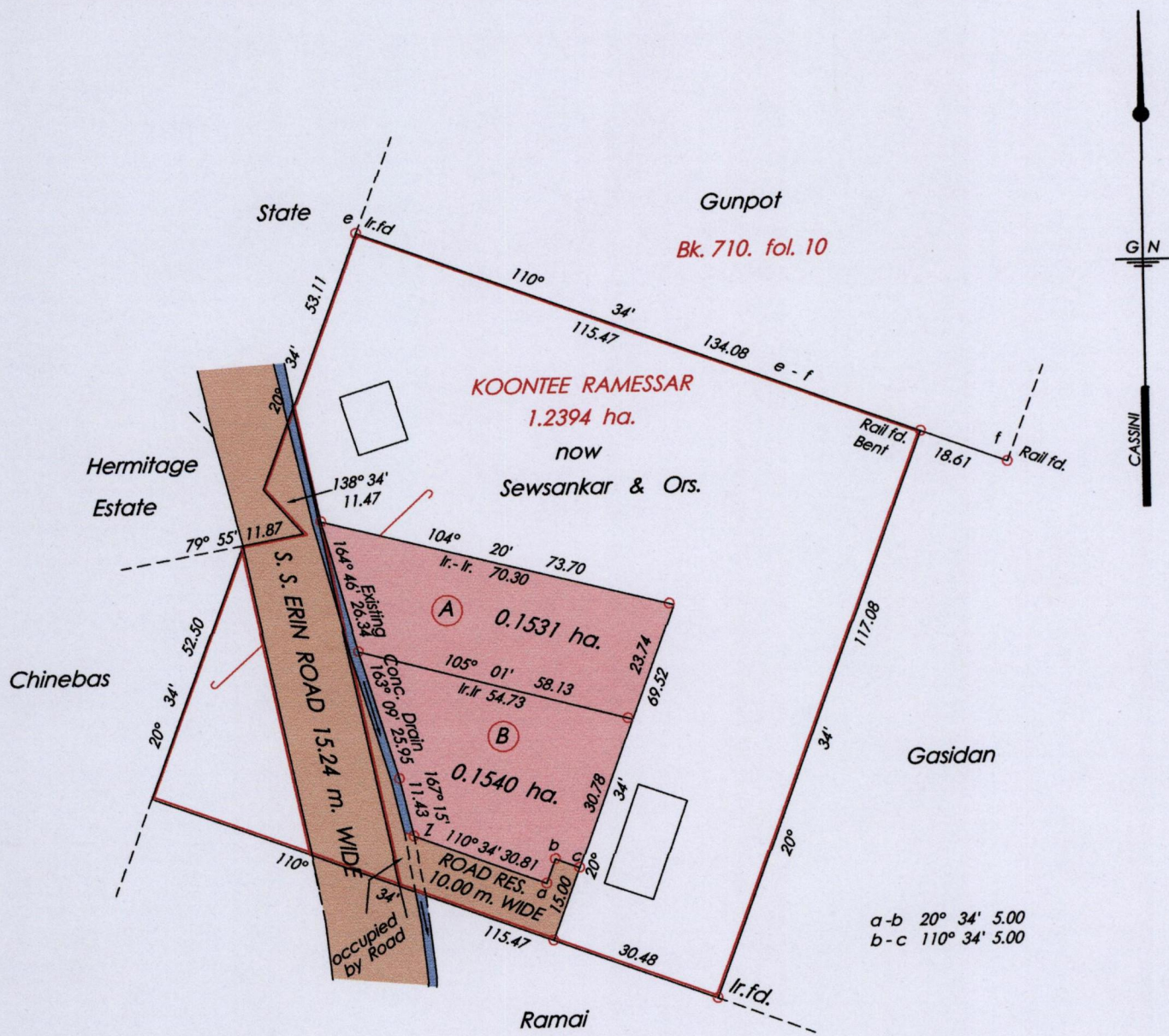

Z = E 669953 N 1128110
U.T.M. Zone 20 Naparima +/- 5.00 m.
Hand Held G.P.S.

Approved *[Signature]*
Director of Surveys 5/12/11

○ Denotes Iron Put Except
Otherwise Stated

SCALE : 1: 1250

Note: Bearings are cassini grid based on solar observations Distances are in metres
PLAN of 2 Parcels of land coloured pink in the Ward of Naparima
Containing together zero point three zero seven one hectare
Surveyed by me, with due authority, in Sept. 2011
Certified correct in accordance with Regulation 25 (1) of the Land Surveyors
Regulations 1998,

Checked by *[Signature]*

Entered on Trinidad & Tobago Land Surveyor *[Signature]* 30th November 2011