

R.P. O Vol. 19 Fol. 579
C.T Vol. 5222 fol. 53

Ward of Siparia
County of ST. Patrick
Cadastral Sheet G 7 P
63 B
3/d

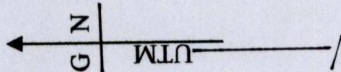

a - b = 25° 49' 6.00
b - c = 125° 04' 6.00
e - f = 25° 49' 6.00
e - d = 125° 04' 6.00

Bk. 1017 Fol. 32
Bk. 1439 Fol. 78

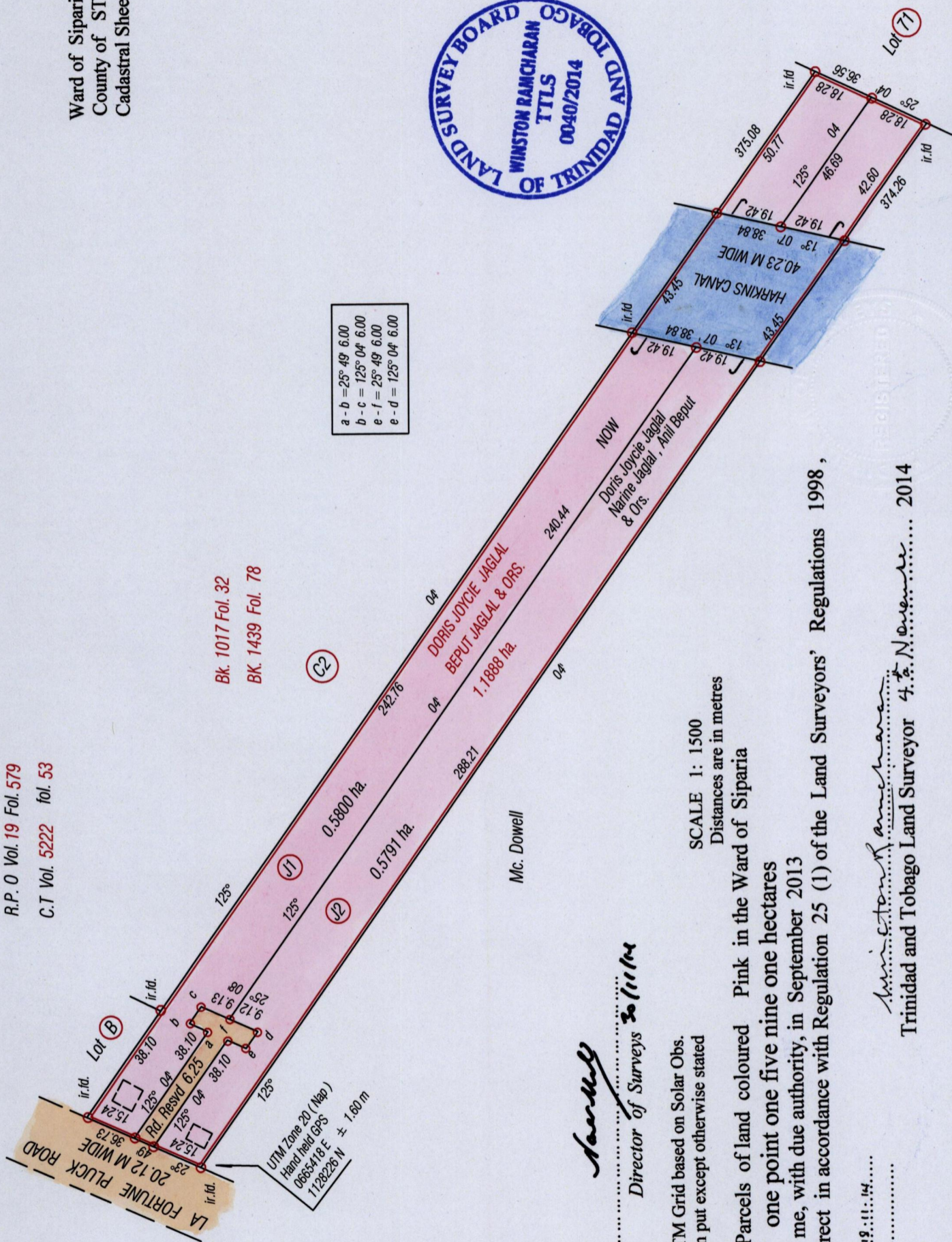

Mc. Dowell

Approved *[Signature]*
Director of Surveys *[Signature]*

Bearings are UTM Grid based on Solar Obs.
○ Denotes iron put except otherwise stated

SCALE 1: 1500
Distances are in metres

PLAN of 2 Parcels of land coloured Pink in the Ward of Siparia
Containing one point one five nine one hectares
Surveyed by me, with due authority, in September 2013
Certified Correct in accordance with Regulation 25 (1) of the Land Surveyors' Regulations 1998 ,

Checked by *[Signature]*
Entered

[Signature]
Trinidad and Tobago Land Surveyor 4th November..... 2014